



Omlet Limited  
Unit 4 Tuthill Park  
Wardington  
Oxon OX17 1RY

[www.omlet.co.uk](http://www.omlet.co.uk)  
[info@omlet.co.uk](mailto:info@omlet.co.uk)  
0845 450 20 56



## Instruction Manual

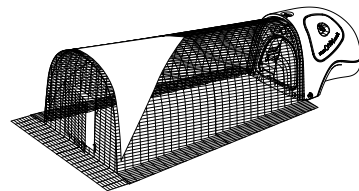

### What you have received

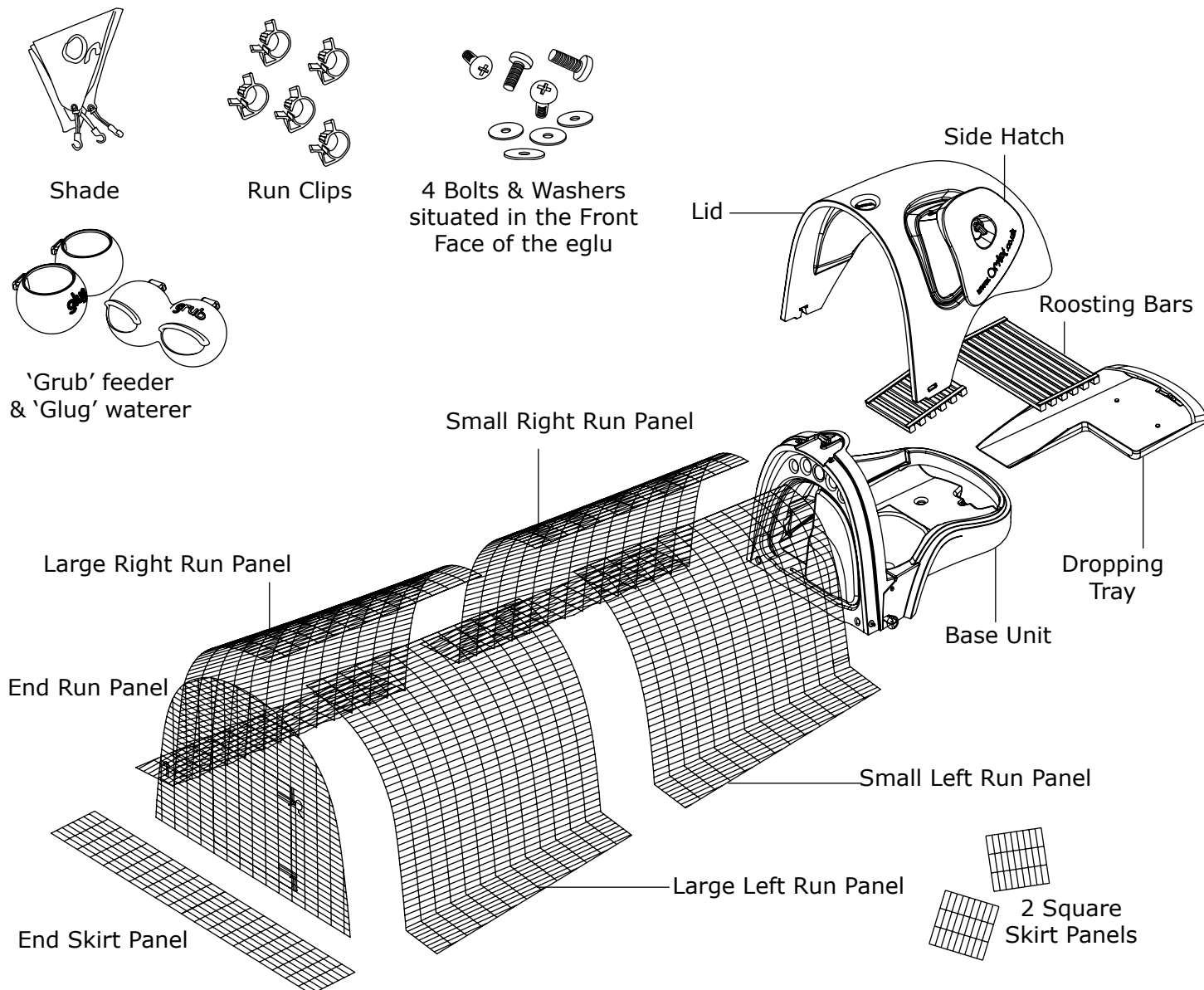

**What should I do  
with the packaging?**



If your eglu arrived by courier, please remember to retain all the packaging it arrived in. In the case that you wish to return the eglu or any part of the eglu, it must be sent back in the original packaging and have no more than normal wear and tear to receive the full product refund.

## Other things you might need

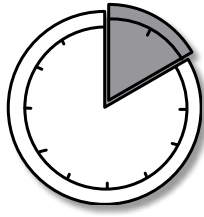

Around 45 minutes to assemble your eglu

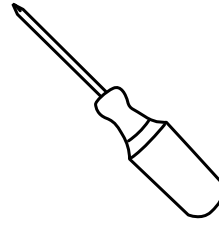

A Phillips Screwdriver

## Assembling Your Eglu

### Step 1 - Find a suitable surface and location in your garden

Make sure you assemble the eglu on a spot that is reasonably even and flat. The diagram shows the eglu dimensions only. Make sure you leave enough space behind the eglu to allow the dropping tray to be removed and enough room in front to open the run door.

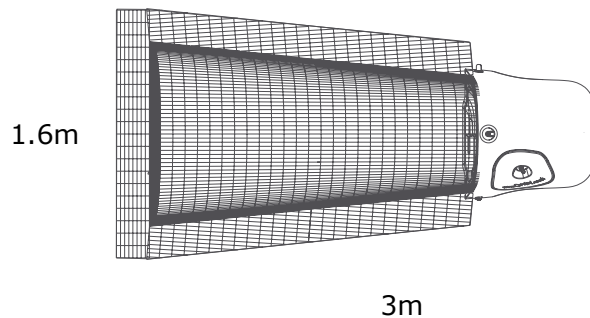

### Step 2 - Attach Small Run Panels to the Eglu

Take the Lid off the eglu by removing the pin and sliding the locking bar - see page 5 for a complete guide.

Place the Base Unit on the ground and line up the Small Left Run Panel with the Base Unit as shown.

Secure the panel by using the Bolts and Washers. You should bolt it to the top hole on the front face first. Screw it on loosely making sure that the middle edge of the Run Panel is in the centre of the eglu.

Now screw the bottom of the Panel to the eglu, making sure that the Panel sits closely against the plastic along its whole length. Tighten the bolts.

Now repeat this procedure for the other Small Run Panel.

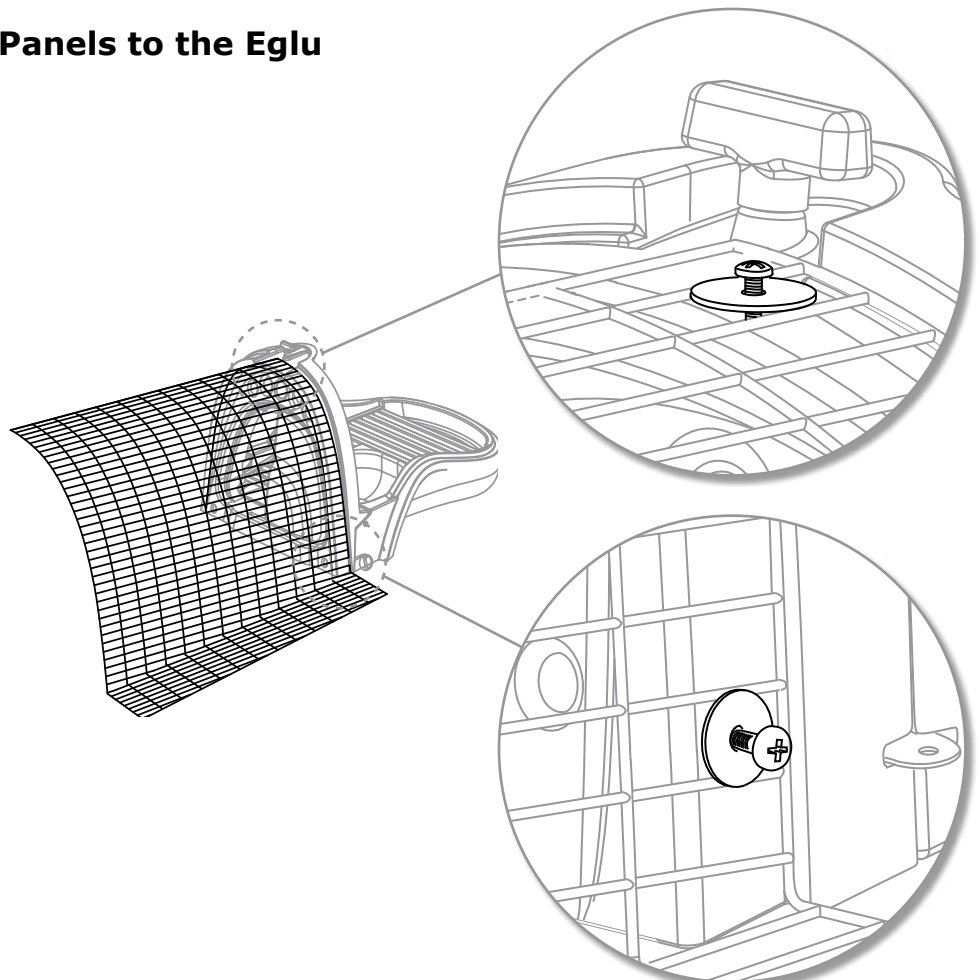

## How do I use the Run Clips?



To join two run panels together, you need to use the Clips supplied. Simply spread the arms and place around the two wires to be joined. Squeeze the clip and it will close up and join the wires as shown in the diagram.

If you wish to undo a clip, spread the 'arms' apart. You may find it easier to use a coin to spread the arms.

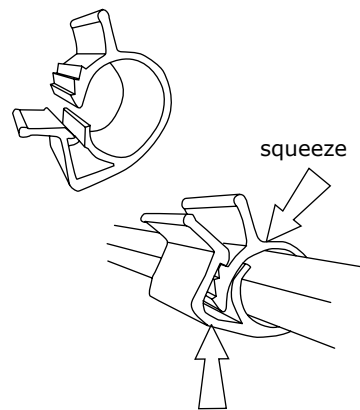

### Step 3 - Clip the Small Run Panels together

Attach the two Small Panels together along their top edges in the positions shown by a ☉

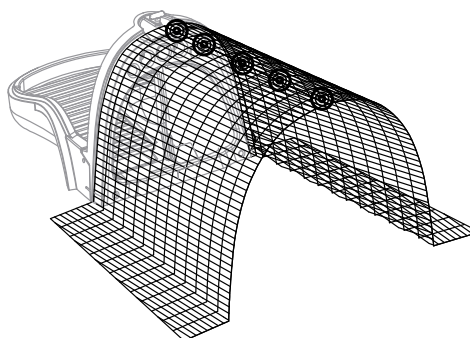

### Step 4 - Clip the Large Run Panels on

Attach the panels Large Left Run Panel and Large Right Run Panel using the clips along their edges.

Do not overlap the panels, just line the edges up and clip together.

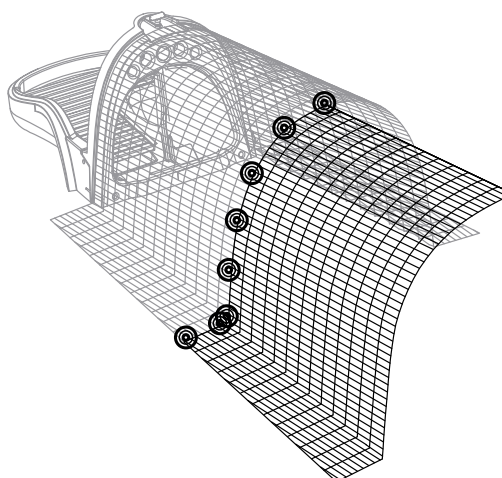

### Step 5 - Clip the Large Run Panels together

Clip the two Large Run Panels together in the positions shown.

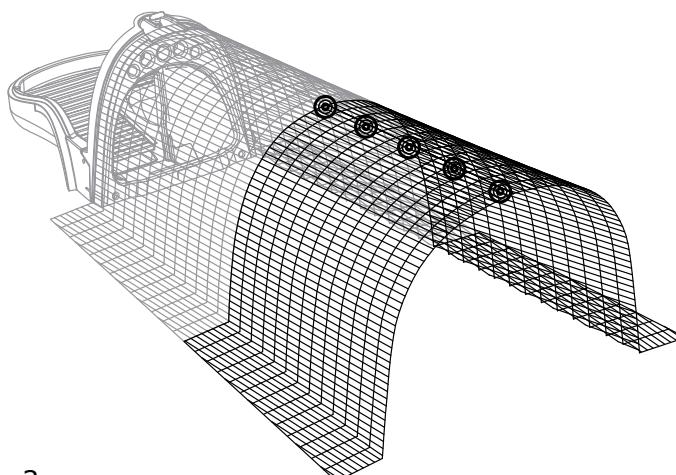

## Step 6 - Clip the End Panel on

To attach the Run End Panel, line up the centre of the panel with the centre of the run. Put the first clips on each side in the positions shown by the arrows before putting the rest of the clips on.

Repeat this for the other side.

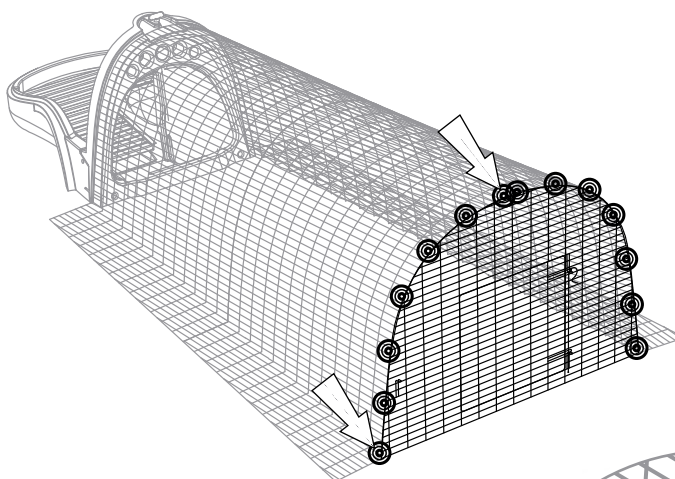

## Step 7 - Clip the End Skirt Panel on

To attach the End Skirt Panel, line up the centre of the Panel with the centre of the run then underlap it by one mesh hole - see closeup. Now clip the Panel on.

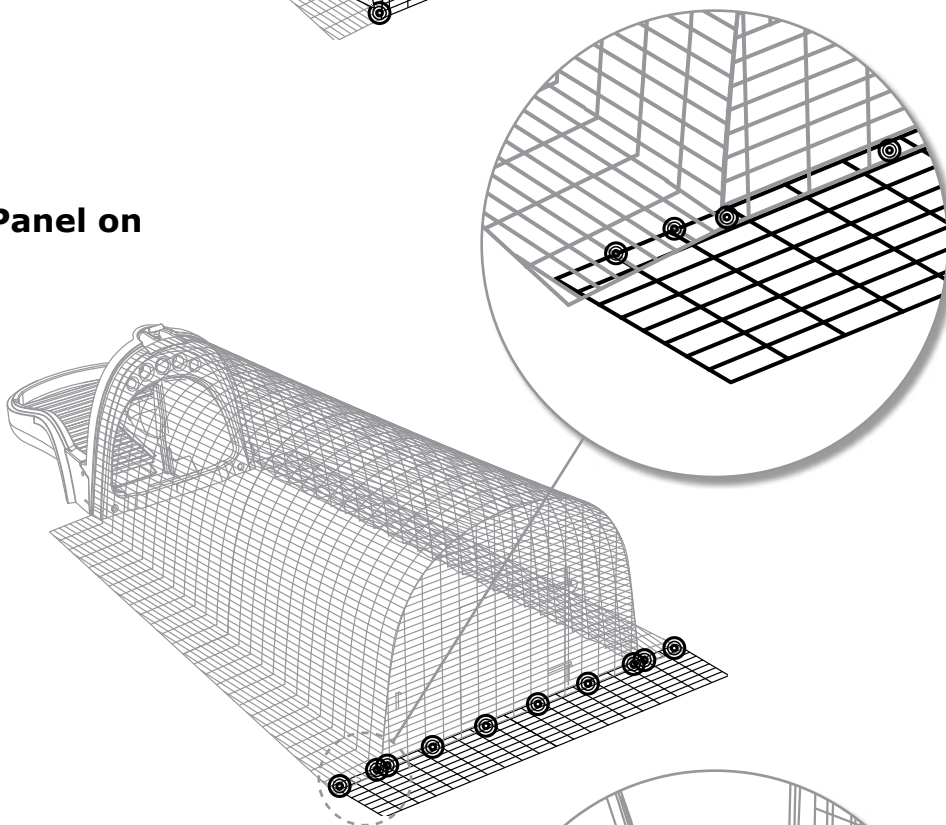

## Step 8 - Clip the Square Skirt Panels on

Attach the square run panels by sliding underneath the eglu and Run panel and clipping in the positions shown.

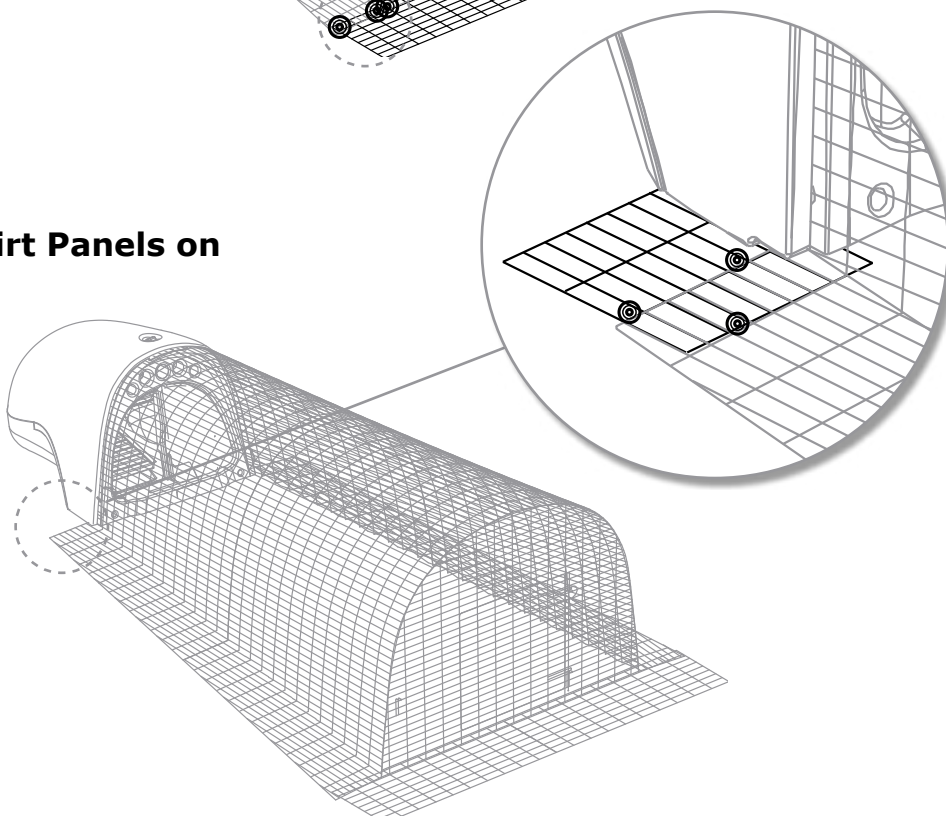



## Step 9 - Attach the Accessories

**Shade** - This is held on with three hooks on bungee cords as shown. Hook the corners onto the run making sure that it is held reasonably taut to prevent it flapping in the wind.

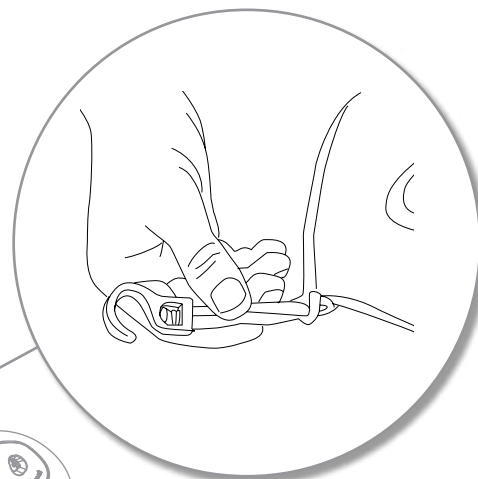
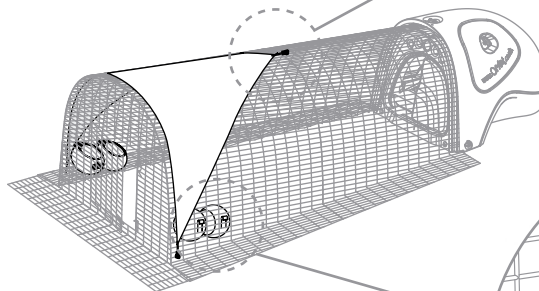

### 'Grub' Feeder and 'Glug' Drinker

These can be attached to the run using the hooks on the backs. Open the door at the end of the run and reach in hanging them on the side walls of the run.

Place the Drinker as low down as possible to allow the chickens to drink from it. The Feeder should be hung at chicken 'head height'.

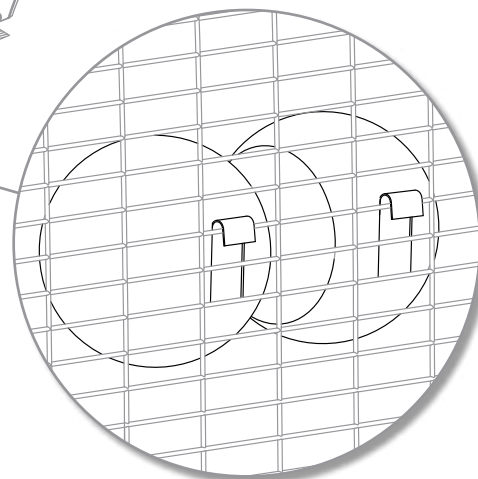

If you have any problems assembling your eglu call us on  
**0845 450 20 56** or email **info@omlet.co.uk**

## Guide to Using Your Eglu

### How to use the Front Door

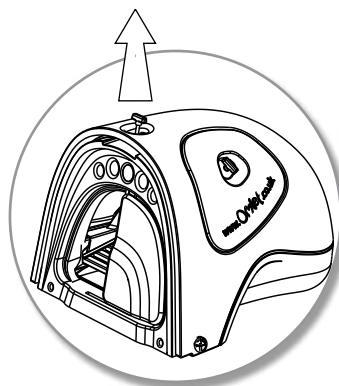

Firstly, pull the handle at the top of the house up until it stops.

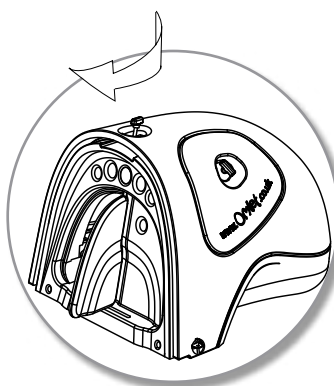

Turn the handle to close the door.

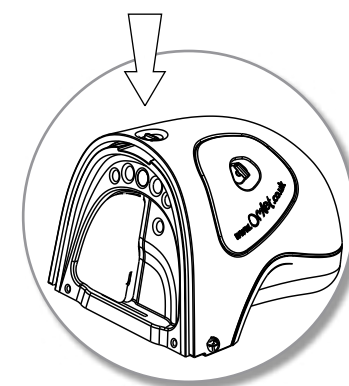

Lock the door by pushing the handle back down until it stops.

## Removing the Lid

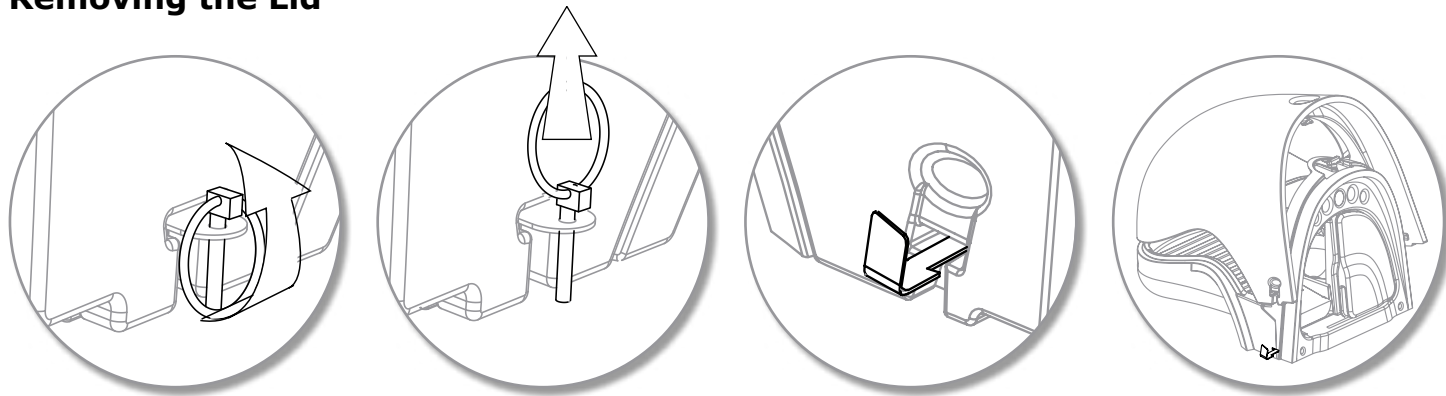

To take the lid of the eglu off, the first step is to remove the lynch-pin as shown above.

Now simply pull the lock bar out as far as it will go and lift the lid off. This will give you full access to the inside of the eglu.

## Closing the Eggport

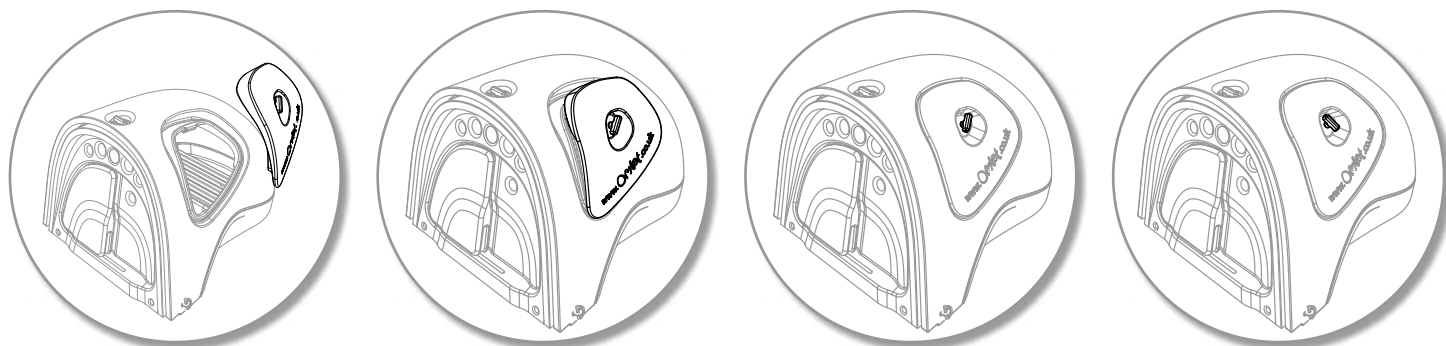

To put the side hatch on, align the bottom edge of the lid.

Push the top corner into place.

Now twist the handle clockwise until you feel it 'click'.

## Using the Droppings Tray



release clip to  
remove tray

To empty the droppings tray, go to the back of the eglu. Simply grip the tray in the center pulling the catch underneath the tray up to release the tray, then slide it out. When putting it back, keep sliding it until the clip clicks into position.

## Moving your eglu

Hold on to the run at the end furthest from the eglu, lift and then pull the eglu to a new patch of grass. The underside of the eglu is smooth and rounded allowing you to slide it around without the need for any dis-assembly.

If you want to move the eglu to a new garden then you will need to take the run apart. Firstly undo the four bolts that hold it to the eglu and then unclip the run. If you lose any clips along the way you can get more by going to [www.omlet.co.uk/shop](http://www.omlet.co.uk/shop)

## Do's and Don'ts



**Do** collect and enjoy your eggs everyday. Leaving eggs in the egglu can cause your chicken to go broody and not lay any eggs for a few weeks.

**Do** make sure your hens have food and water. Without food and water your chickens will die.

**Do** let your chickens out of the egglu everyday. If you are away, then leave the egglu door open so that the chickens can get out into the run in the morning. Not letting your chickens out will lead to distressed chickens and could lead to terminal overheating.

**Do** supervise children when they are using the egglu or interacting with the chickens. Chickens can be unpredictable and peck at anything including people.

**Do** take extra care when using the lawn mower around the 'skirt' of the run. Without care you will damage the 'skirt' with the lawnmower.

**Do** wash your hands after coming in contact with the egglu or chickens.

**Do** be aware that chickens have sharp beaks and claws and they may peck something that resembles food or looks interesting to them. Small shiny things are especially attractive to chickens.

**Do** check that the side hatch and dropping tray are well fastened. If they are not secure your chickens are at a greater risk of a predator getting them.

**Don't** sit or climb on the run. This is not only dangerous but can lead to the run being damaged.

**Don't** let children inside the run or egglu. This could lead to them getting stuck.

**Don't** leave the door of the run open while your chickens roost at night. This will compromise your chickens safety by allowing predators to get into the run

**Don't** keep the egglu on uneven ground as this will make the run less secure. It can also cause the run 'skirt' to be a tripping hazard.

**Don't** use bleach, solvents or strong detergent to clean the egglu, they could damage the plastic.

**Don't** keep the egglu near sources of ignition, such as a bonfire or barbecue, because they could set the egglu on fire.

**Don't** use the egglu for anything other than housing chickens. It has not been designed for any other purpose.

**Don't** keep more than 2 heavy breeds, 4 medium sized breeds (like the Ginger Nut Ranger and Miss Pepperpot) or six bantams in an egglu. This will cause overcrowding and distressed birds.

for further information go to [www.omlet.co.uk](http://www.omlet.co.uk)  
or you can email enquiries to [info@omlet.co.uk](mailto:info@omlet.co.uk)  
or call us on **0845 450 20 56**

## The Online Shop

In the Omlet shop you can find everything you need to keep your eglu and chickens in tip top condition. You can order more chicken food, browse for books on chickens and find unusual items such as egg timers and mini frying pans that make perfect gifts for hen-thusiasts. We also stock accessories for eglus and (probably) the worlds largest selection of egg cups!



Feed



Eglu Accessories



Health



Accessories



Kitchen and eggcups



Gifts



Clothing



Books

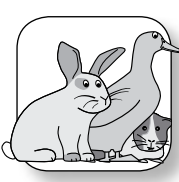

Eglus for other animals

## Hen Parties

### Share Your Chicken Knowledge

Running your own course is a fulfilling and rewarding way for you to share your hobby. Whether you keep chickens, rabbits, guinea pigs or another type of animal in your eglu you can apply to set up your own course.

To host your own Hen Party all you need to do is send us your name, address and the type of animal you would like to run a course on and we will get in touch with you.



Learn more about Hen Parties at  
[www.omlet.co.uk/courses](http://www.omlet.co.uk/courses)

## Join the Omlet Club

### The Omlet Website



A fantastic resource and a place to make new friends.

Need to know more about the eglu or keeping chickens? Then look no further than the Omlet website. You'll find sections on all our products and short video clips of the eglu in use. A breeds directory on the website features over 50 of the most popular and extraordinary varieties from all over the world. You will also find comprehensive guides covering everything from daily chicken routines to seasonal care and even a description of how an egg is formed.

**Omlet**

To order these items please call

**0845 450 2056**

or you can order and pay securely online at

**[www.omlet.co.uk](http://www.omlet.co.uk)**

### The Omlet Club

As an eglu owner you will have access to the Omlet Club on the Omlet website. The club includes several areas including a forum, a gallery and a library of Omlet Newsletters. It's a hugely enjoyable and lively community where people with lots of experience of keeping chickens in eglus share tips and advice with people eagerly expecting their first egg.

The gallery pages are filled with pictures of eglus and chickens, there is a special area dedicated to images of "my first egg" and you can put names to faces in the "meet the eglu owners" pages. With well over a thousand members there's never a dull moment in the Omlet Club!



See more photos at [club.omlet.co.uk/gallery](http://club.omlet.co.uk/gallery)

Omlet Ltd, Tuthill Park, Wardington, Banbury, OX17 1RR.

Reg#5028498 VAT#837106436

Omlet®, eglu® and No foxes allowed™ are trademarks of Hebe Studio Ltd.