

TOWER

Module Assembly

DE Montage des Turmmoduls · FR Assemblage du module Tour · NL Assemblage van torenmodules
IT Assemblaggio del modulo torre · ES Montaje del módulo de torre · SE Montering av tornmodul
DK Tårnmodulsamling · NO Tårnmodulmontering · PL Montaż modułu wieży

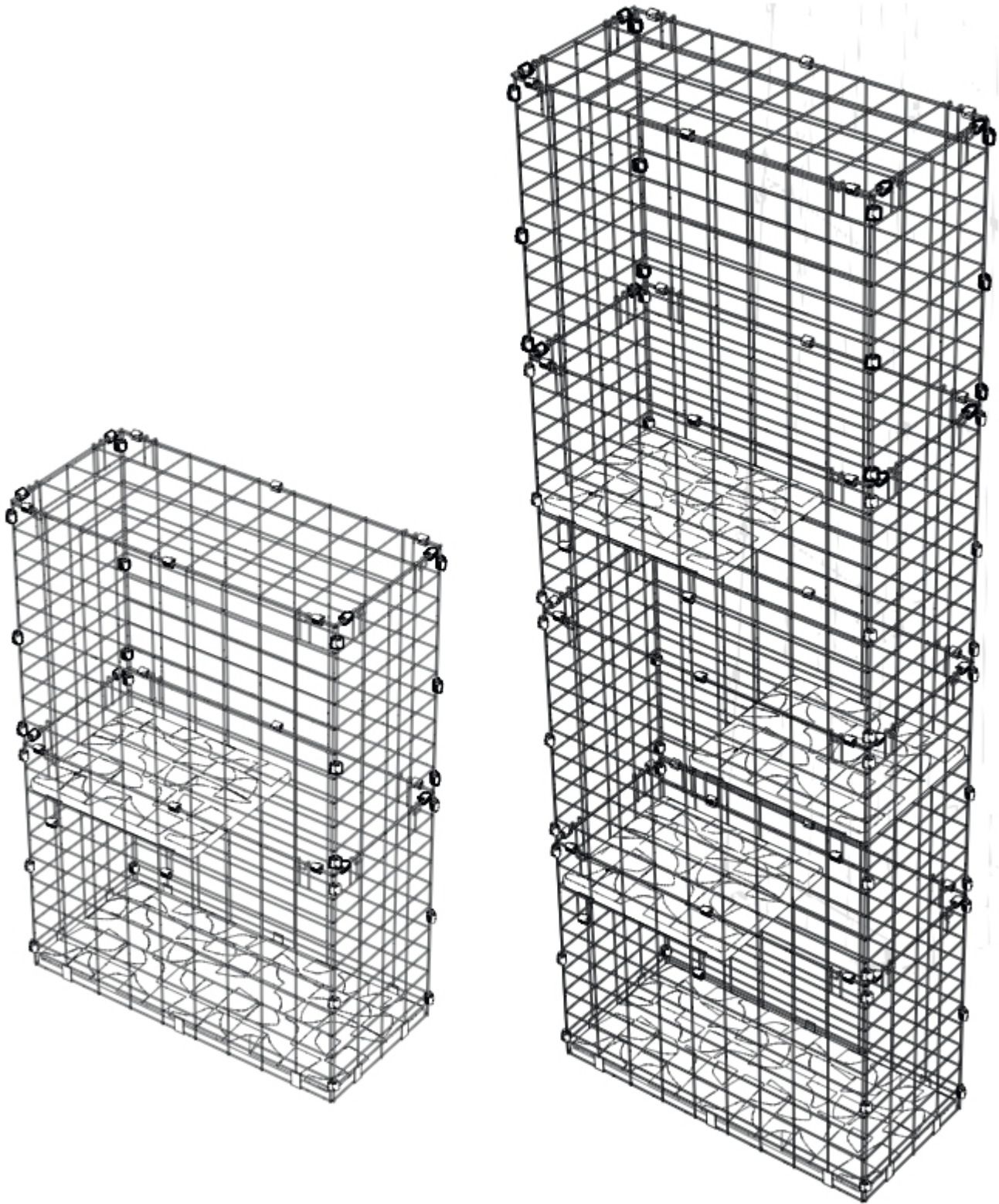

What you have received

DE Das haben Sie erhalten · FR Ce que vous avez reçu · NL Wat u heeft ontvangen · IT Cosa hai ricevuto
ES Qué ha recibido · SE Vad du har fått · DK Du har modtaget · NO Hva du har mottatt · PL Co otrzymałeś/eś

096.0028 Boxed Tower



X1
Square Platform
096.1021

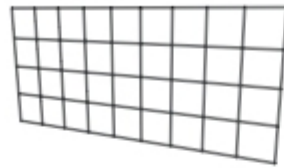

X1
Tower Top
096.1025



X2
Tower Platform Bracket
096.1026

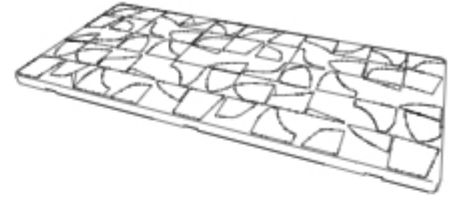

X1
Window Box Platform
096.1031

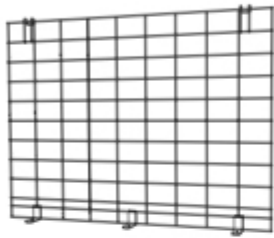

X2
Window Box Front Panel
096.1032

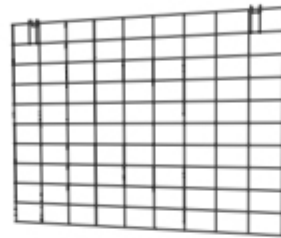

X2
Window Box Front
Extension
096.1033

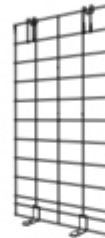

X2
Window Box Side Panel
096.1034

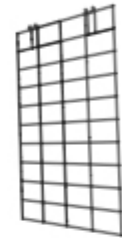

X2
Window Box Side Extension
096.1035



X2
Mesh Edge Protector 250
810.0410



X2
Mesh Edge Protector 330
810.0411

096.0105 Fixings Pack Tower

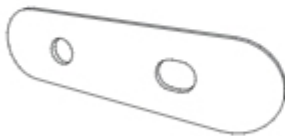

X2
Platform Connection Bracket
096.1101



X4
Connection Hook
096.1103



X17
Nylon Washer M6
800.0323



X17
M6 x 12mm Bolt
800.0353



X6
Cable Tie
3 x 200mm
800.0427



X48
Mighty Clip C
810.0134



X1
4mm Allen Key
810.1122

096.0116 Wall Mounting Fixings Pack Tower



X15
Wall Mounting Clip
096.1045



X2
Wall Mounted Bracket
096.1102



X20
Woodscrew
4 x 30mm
800.0366

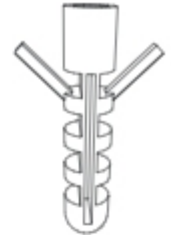

X20
Wall Plug
800.0392

096.0029 Boxed Tower Vertical Extension



X2
Square Platform
096.1021



X4
Tower Platform Bracket
096.1026

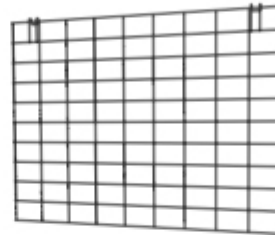

X4
Window Box Front
Extension
096.1033

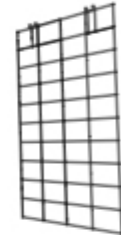

X4
Window Box Side Extension
096.1035

096.0106 Fixings Pack Tower Vertical Extension



X8
Nylon Washer M6
800.0323



X12
M6 x 12mm Bolt
800.0353



X6
Cable Tie
3 x 200mm
800.0427



X52
Mighty Clip C
810.0134

096.0117 Wall Mounting Fixings Pack Tower Extension



x12
Wall Mounting Clip
096.1045



x12
Woodscrew
4 x 30mm
800.0366

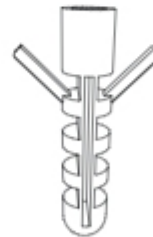

x12
Wall Plug
800.0392

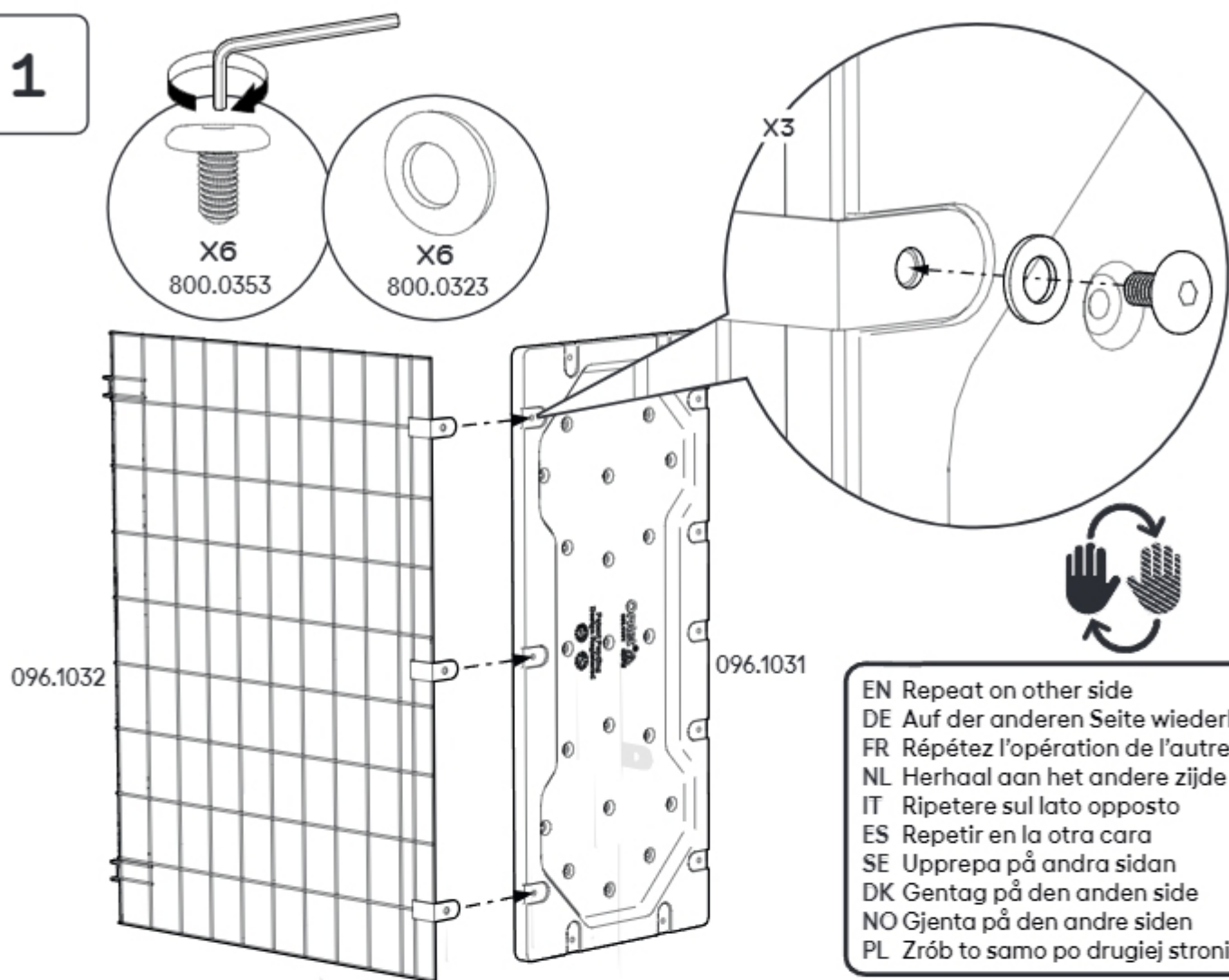
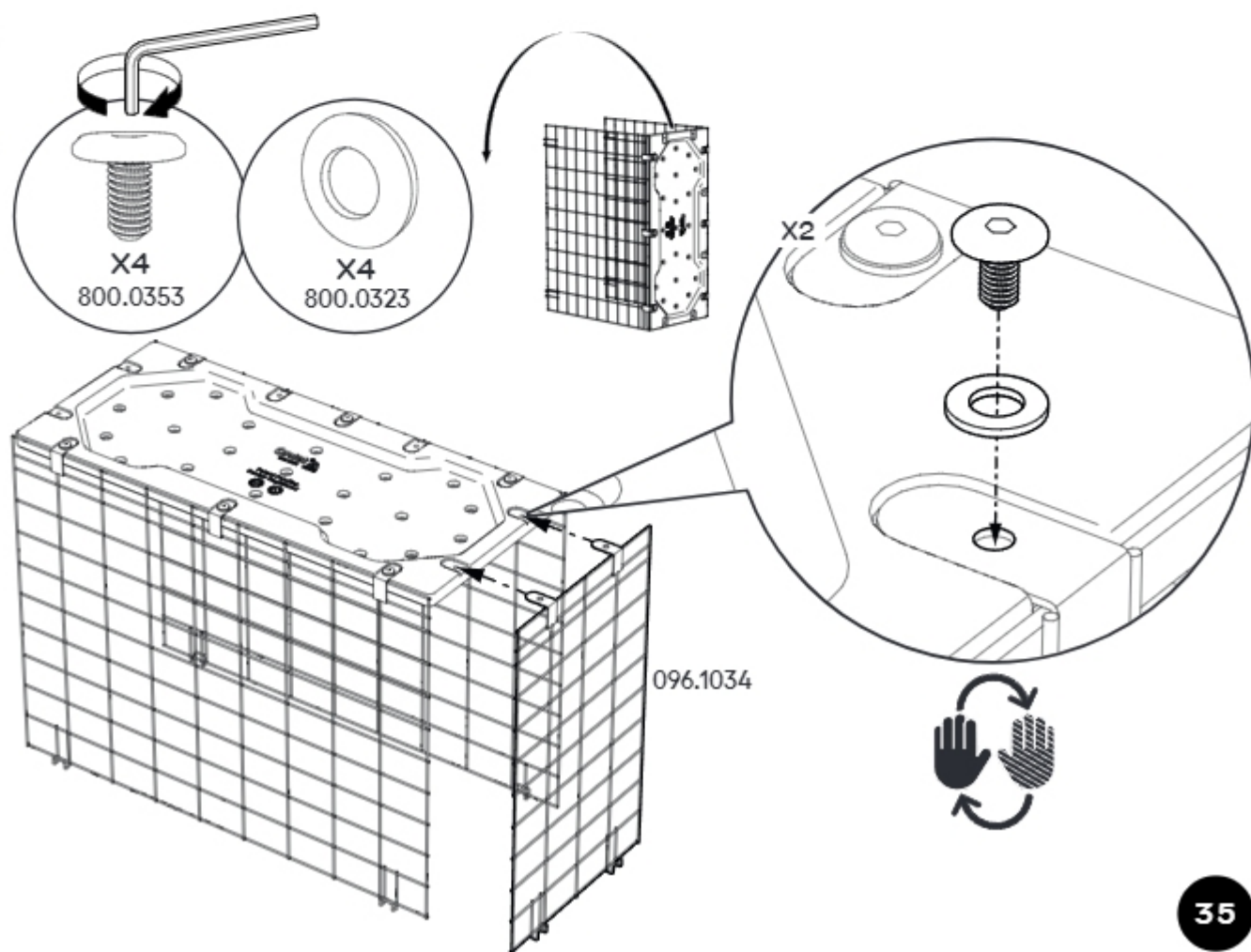
1**2**

3

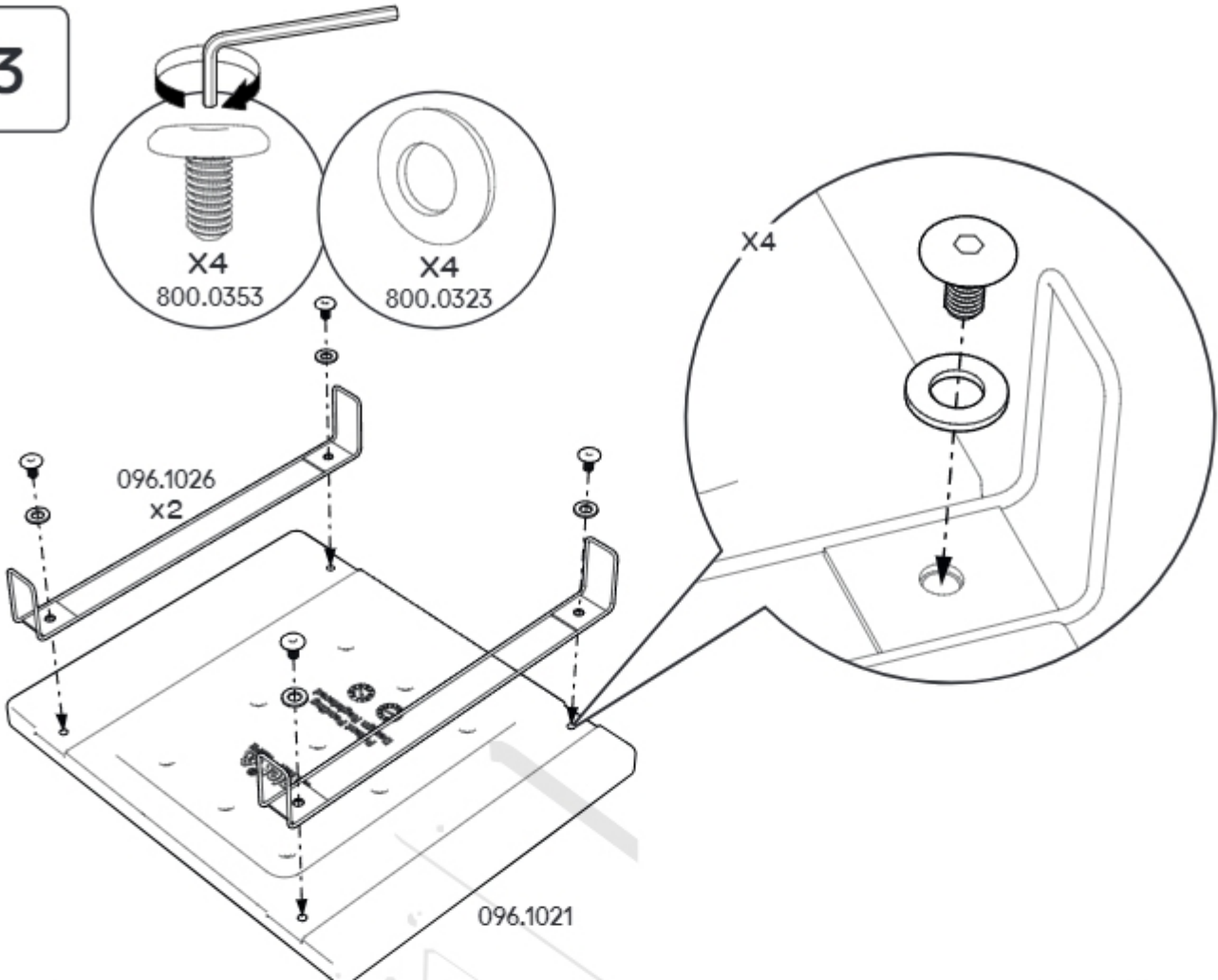

4

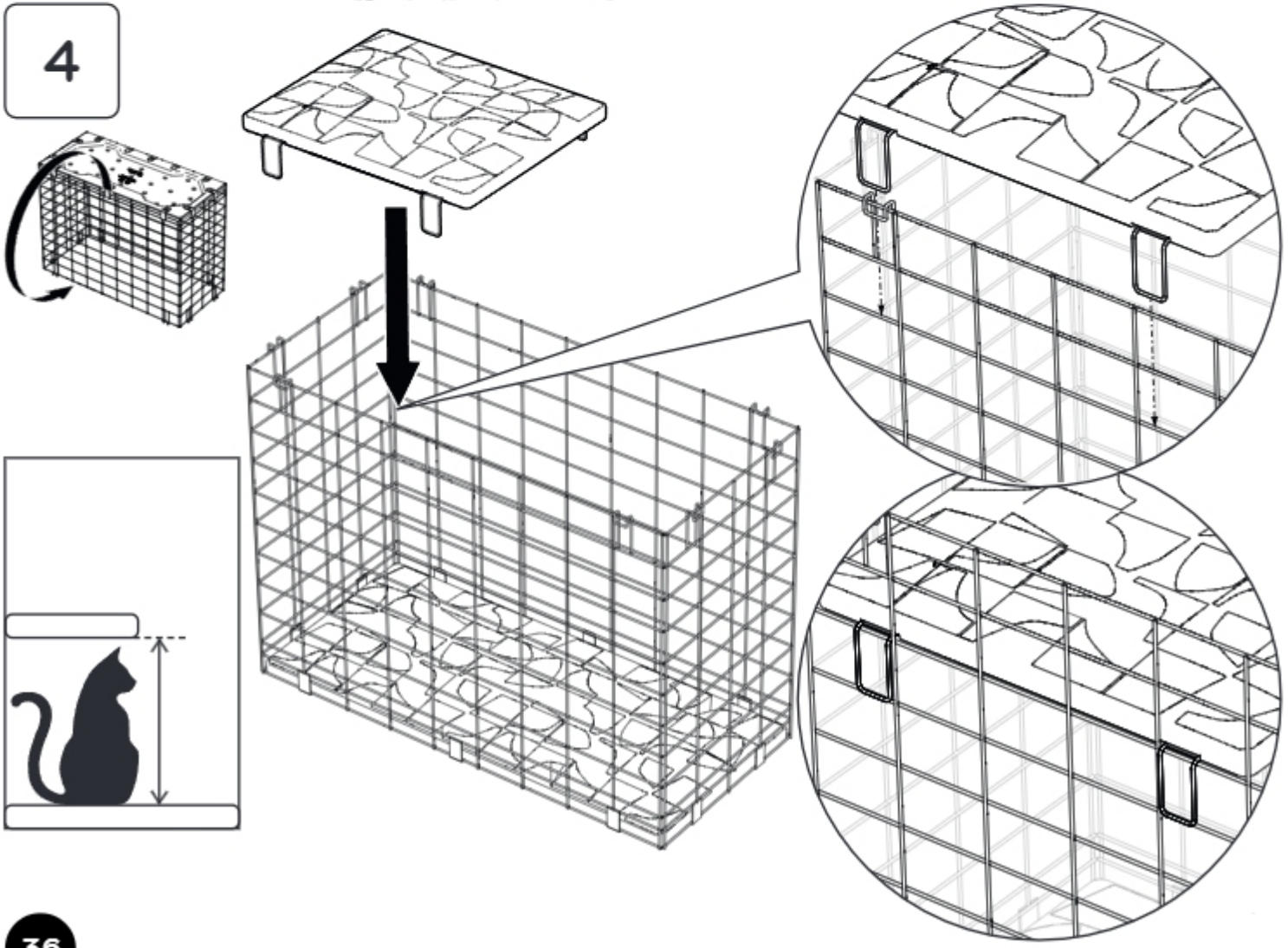

5

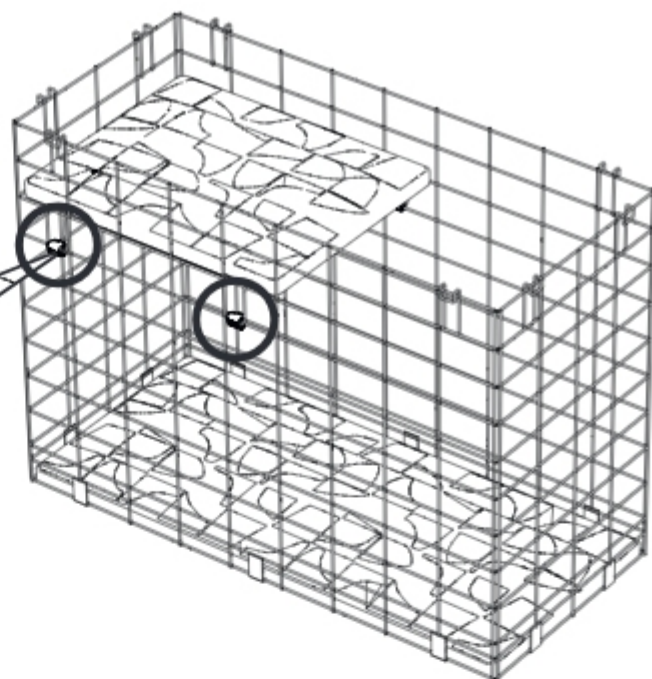
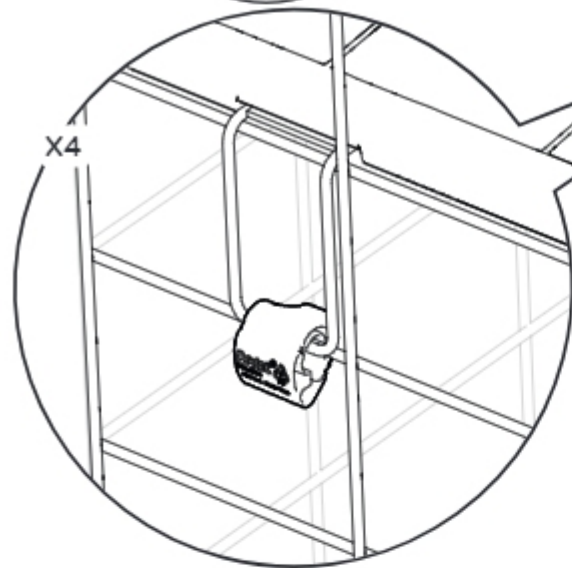
X4
810.0134

6

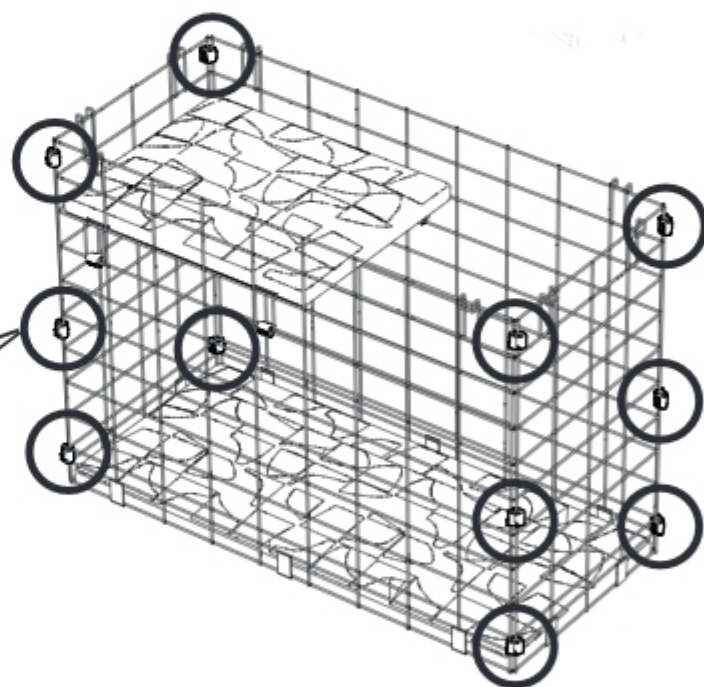
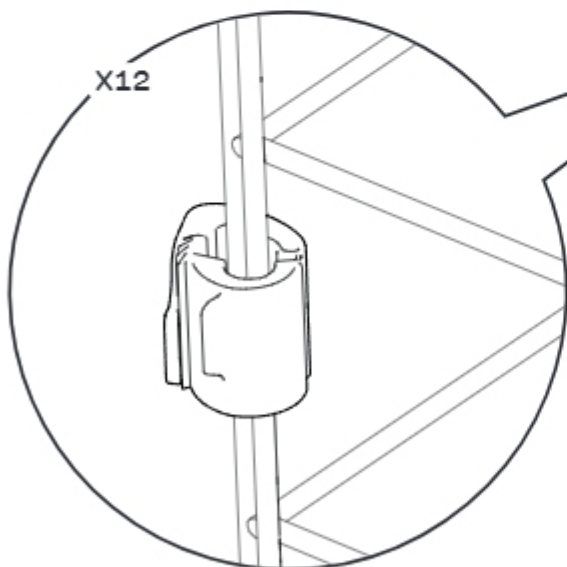
X12
810.0134

If you have an extension pack.

DE Wenn Sie ein Erweiterungspaket haben.
 FR Si vous avez un pack d'extension.
 NL Als u een uitbreidingsset heeft.
 IT Se disponete di un pacchetto di estensione.
 ES Si usted tiene un pack de extensión.
 SE Om du har ett tilläggspaket.
 DK Hvis du har en udvidelsespakke.
 NO Hvis du har en utvidelsespakke.
 PL Jeśli masz pakiet rozszerzeń.



If not...

DE Wenn nicht...
 FR Autrement...
 NL Indien niet...
 IT Altrimenti...
 ES Si no...
 SE Om inte...
 DK Hvis ikke...
 NO Hvis ikke...
 PL Jeśli nie...



37

7

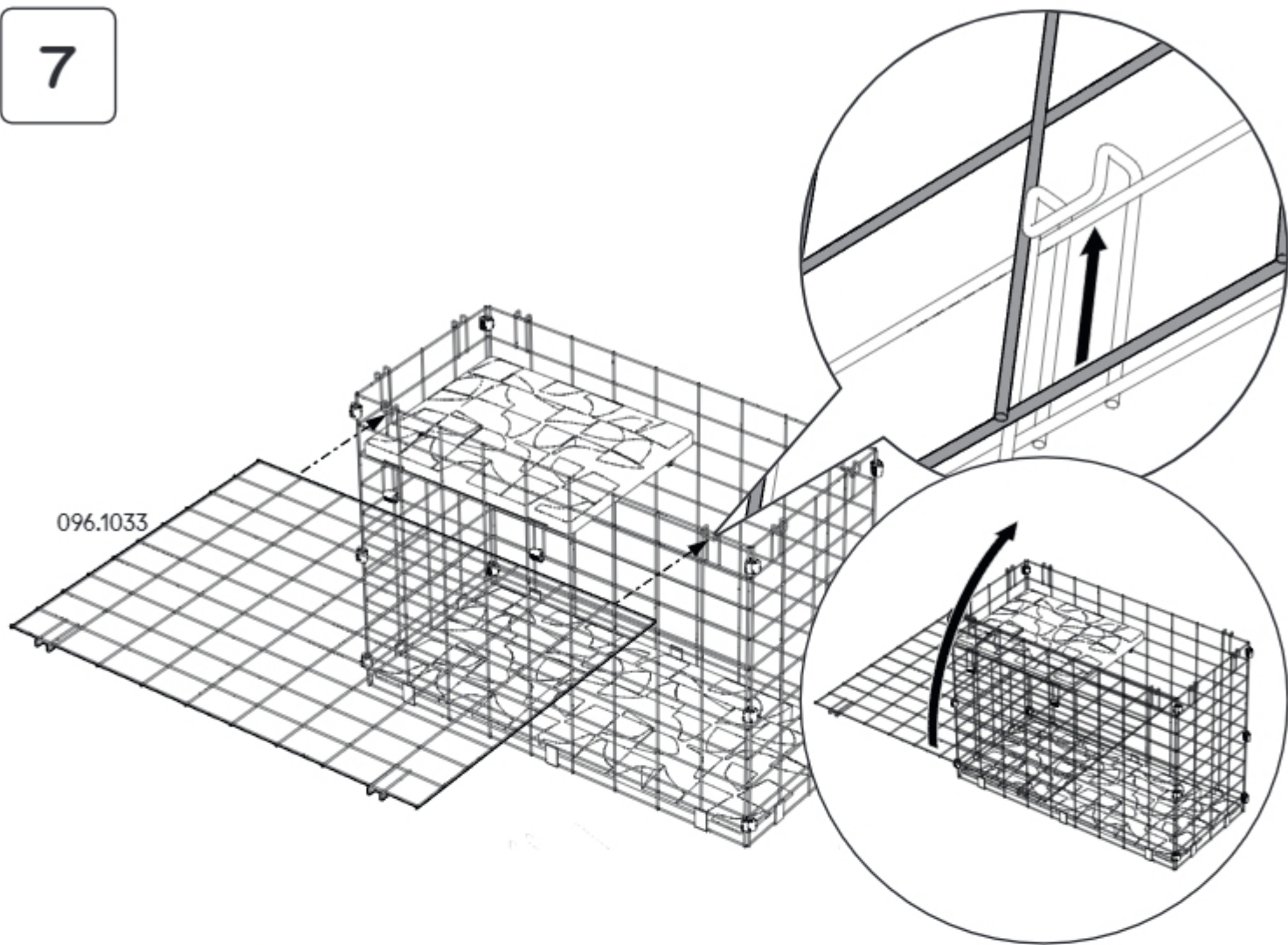

8

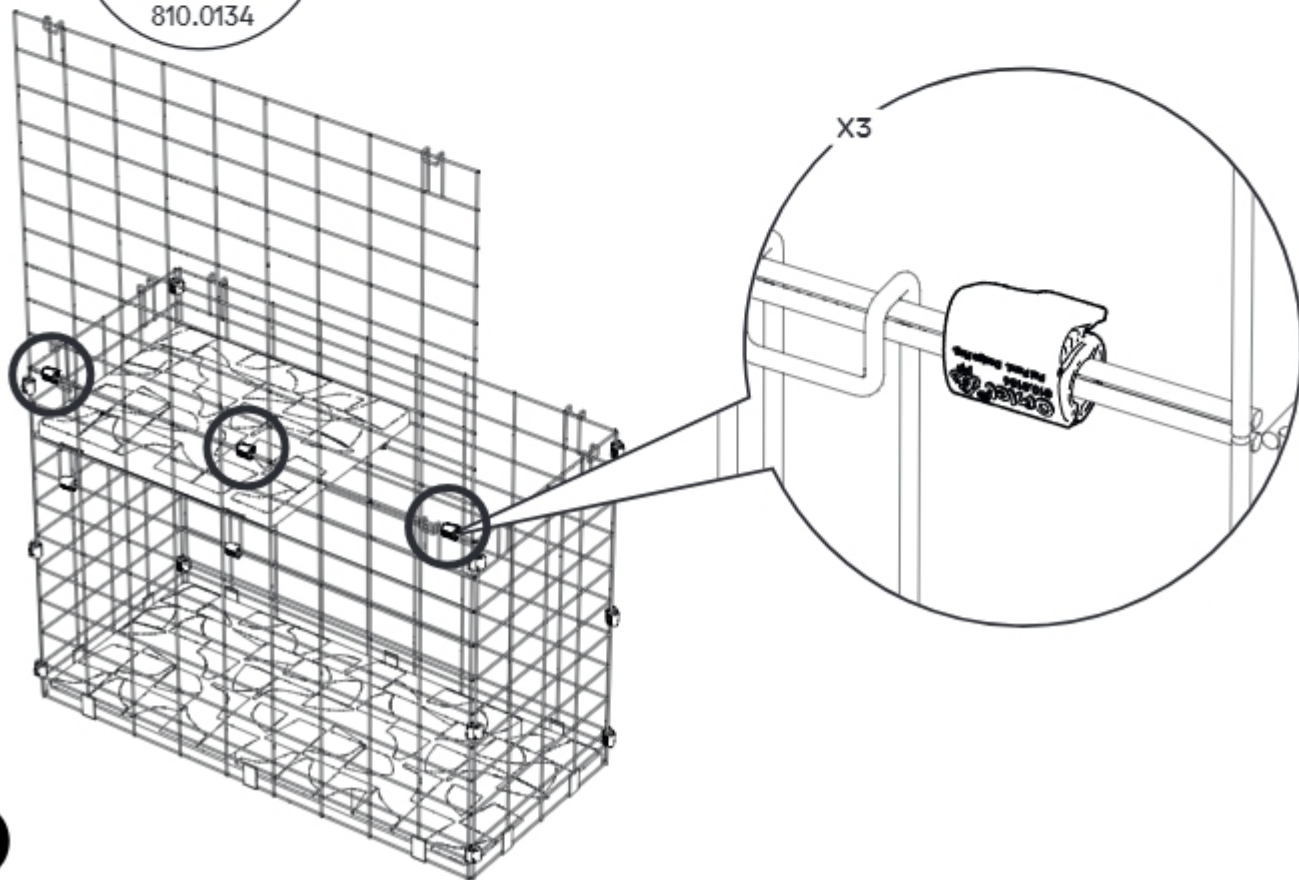

9

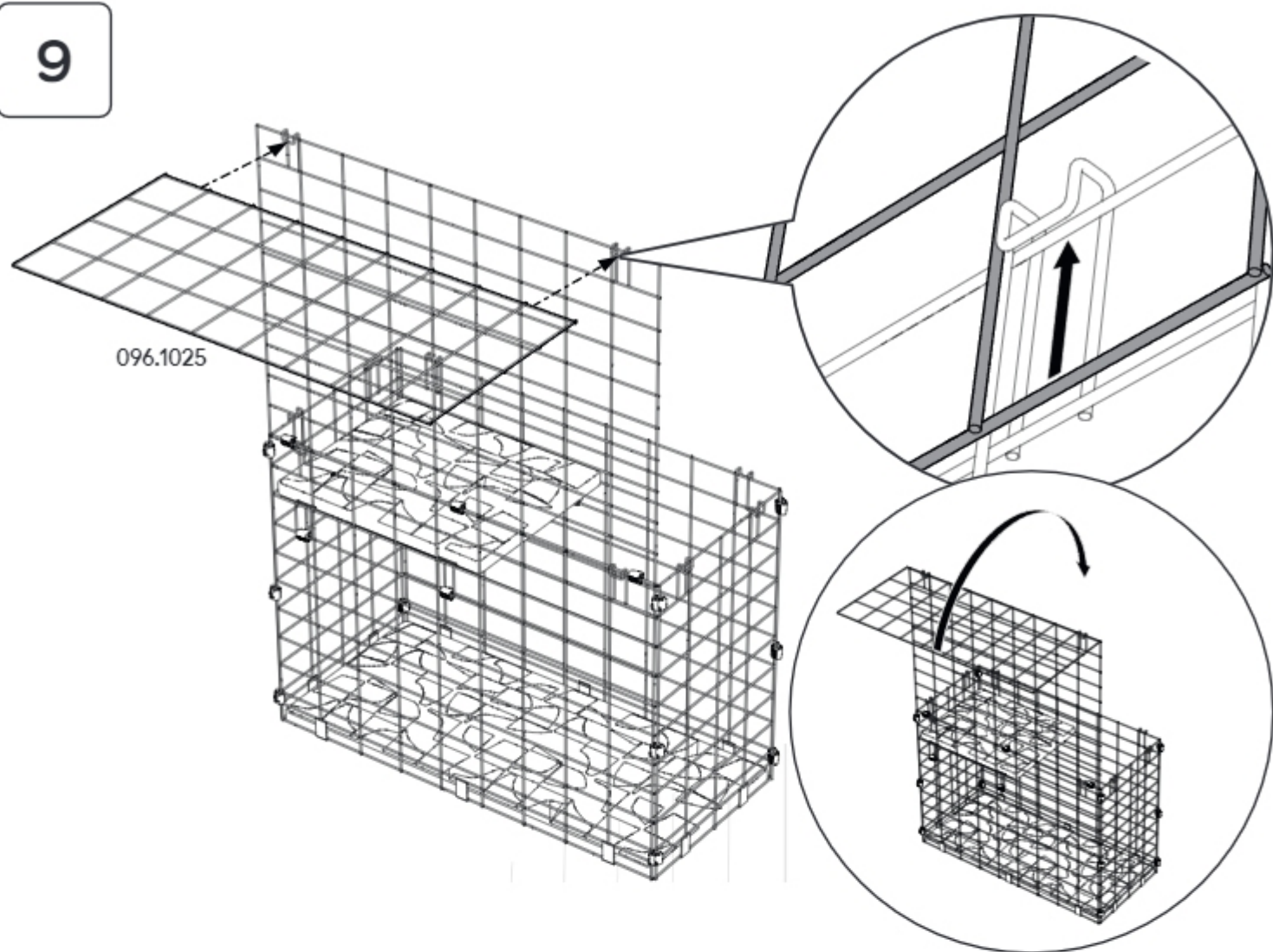

10

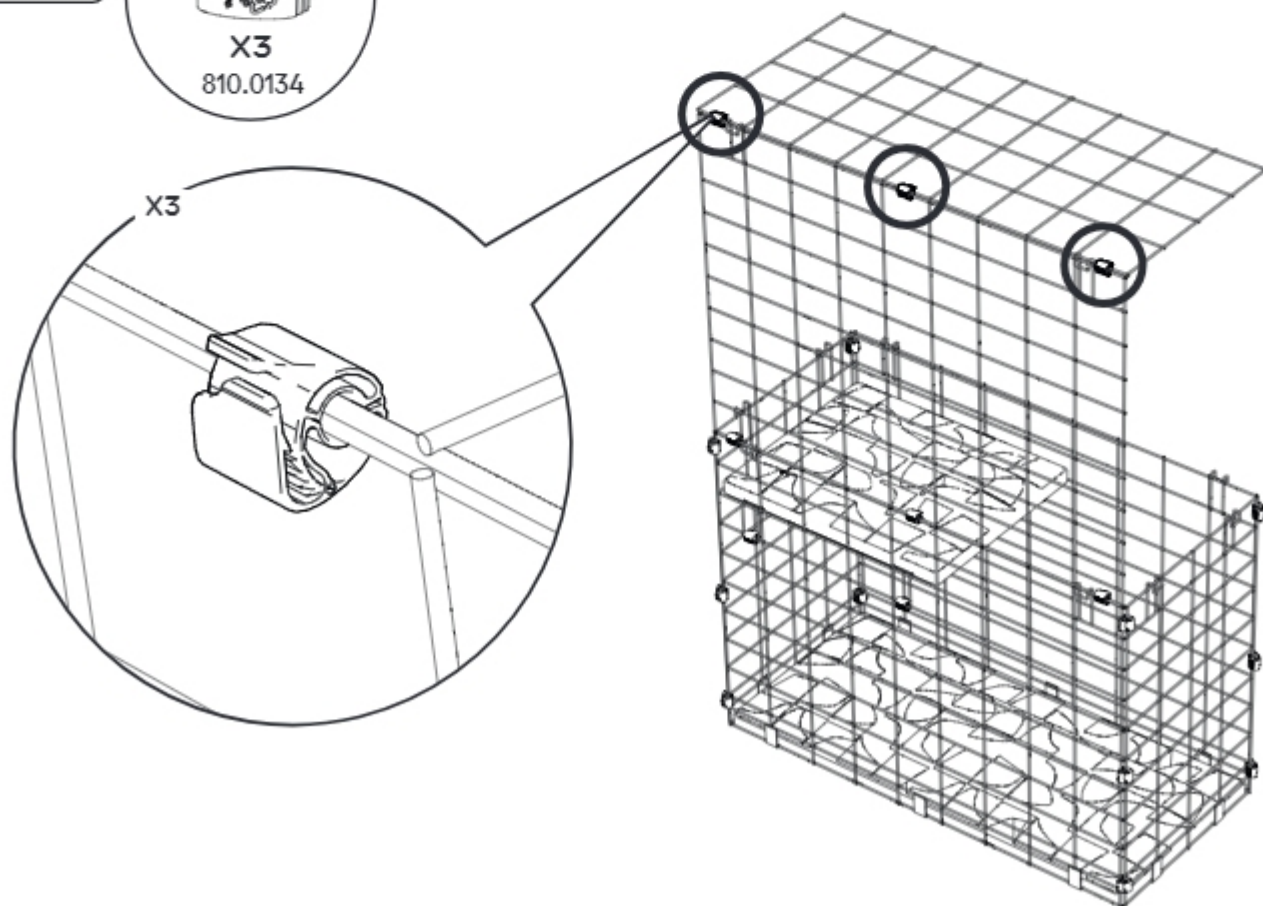

11

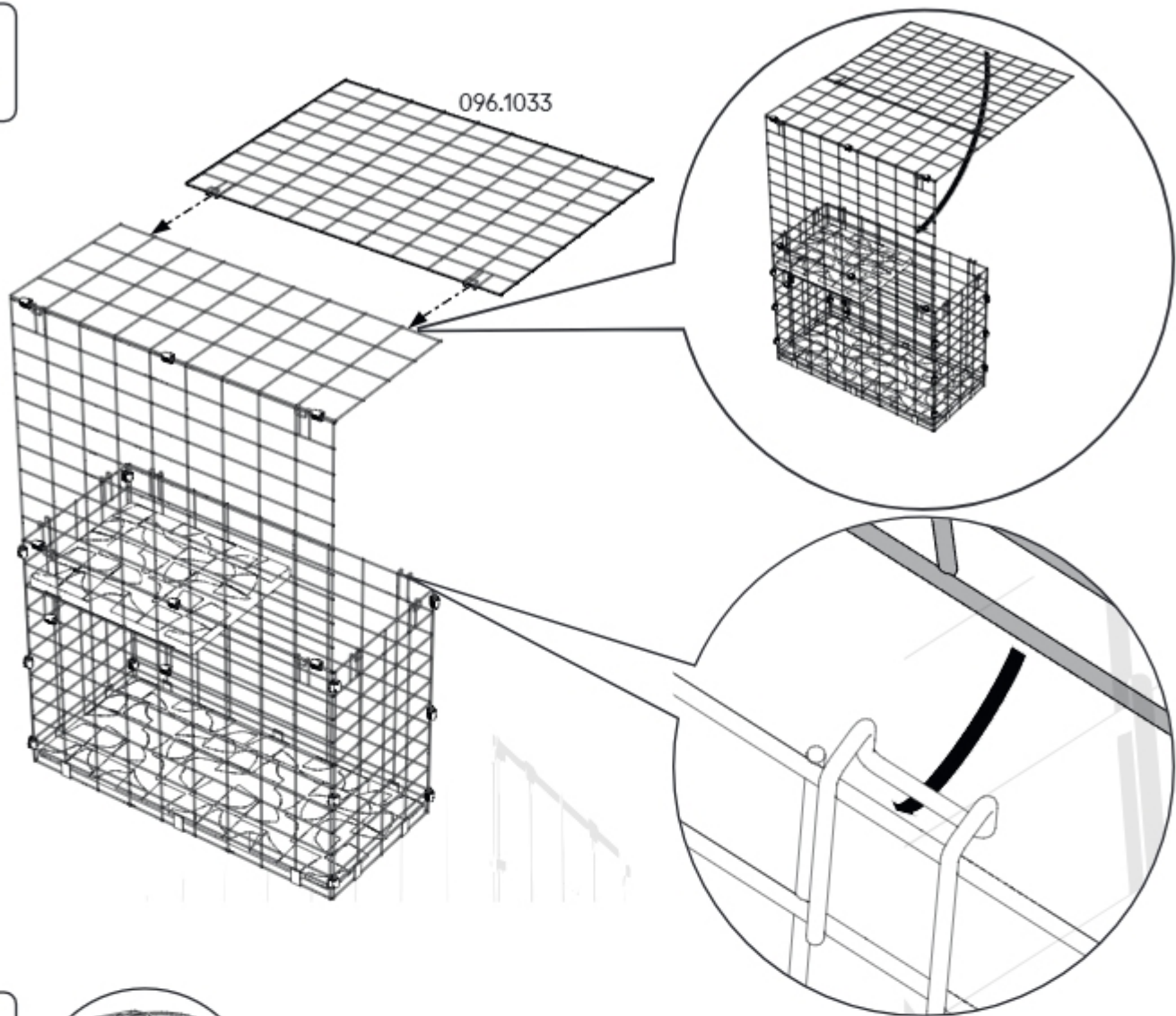

12

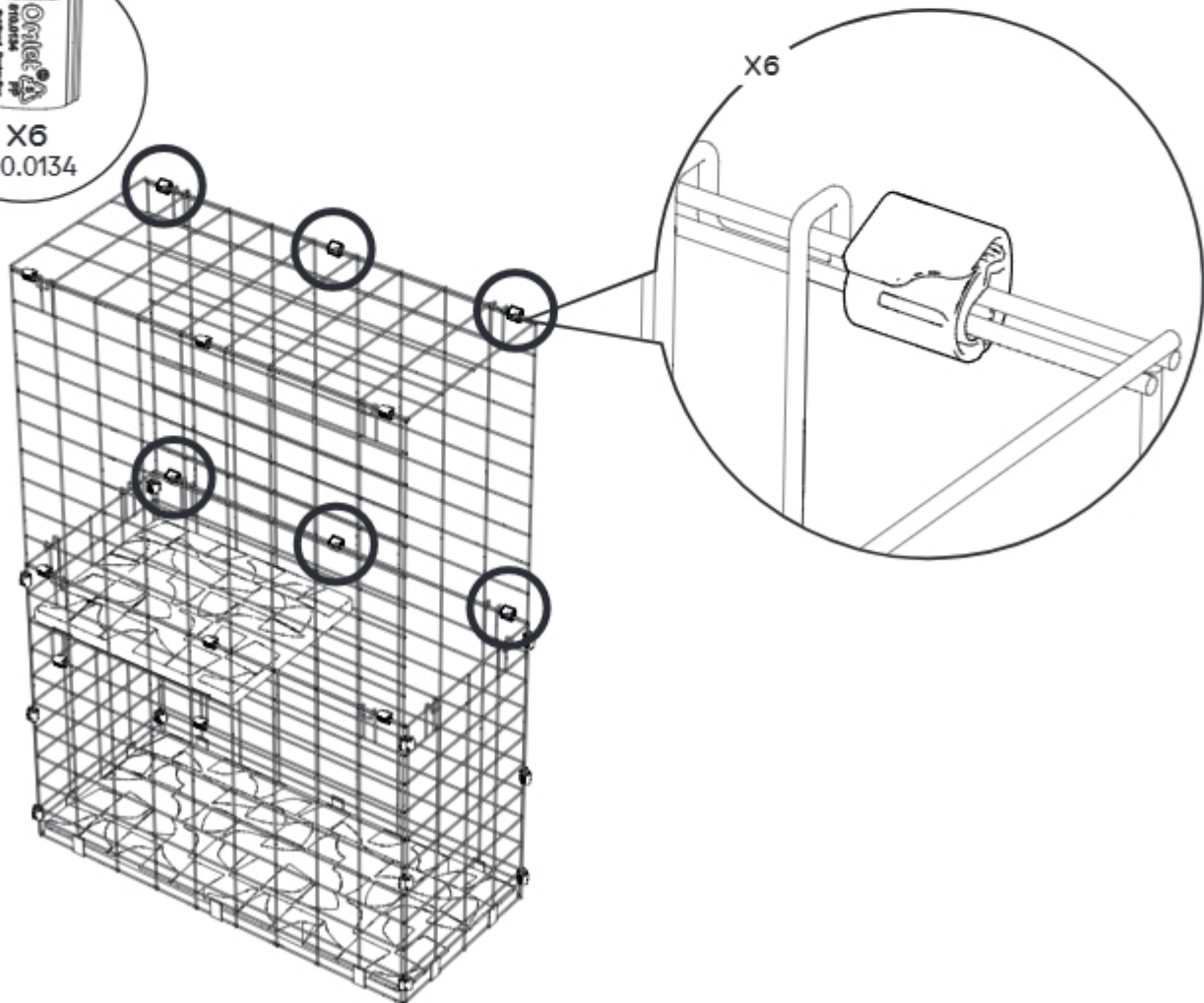

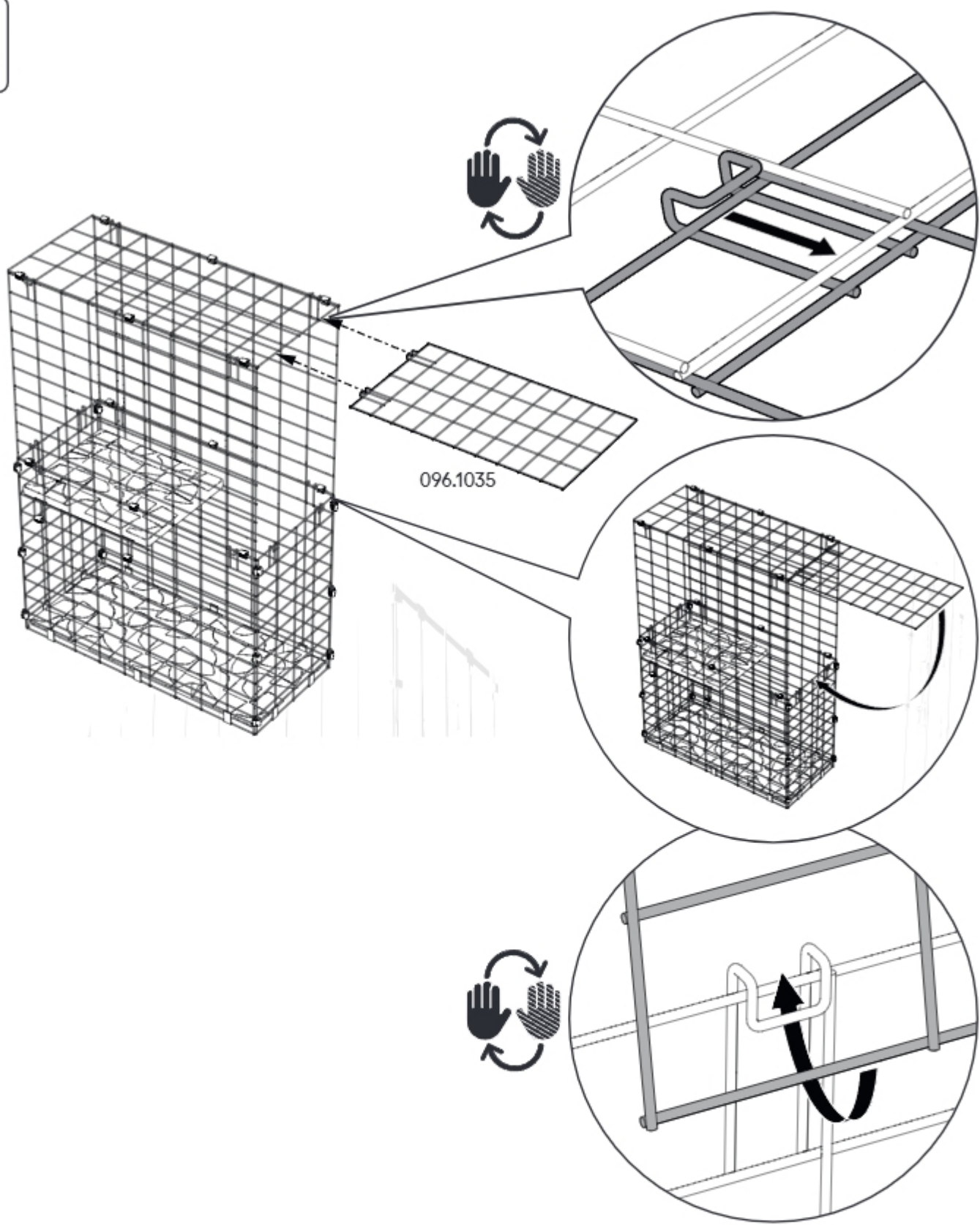

14

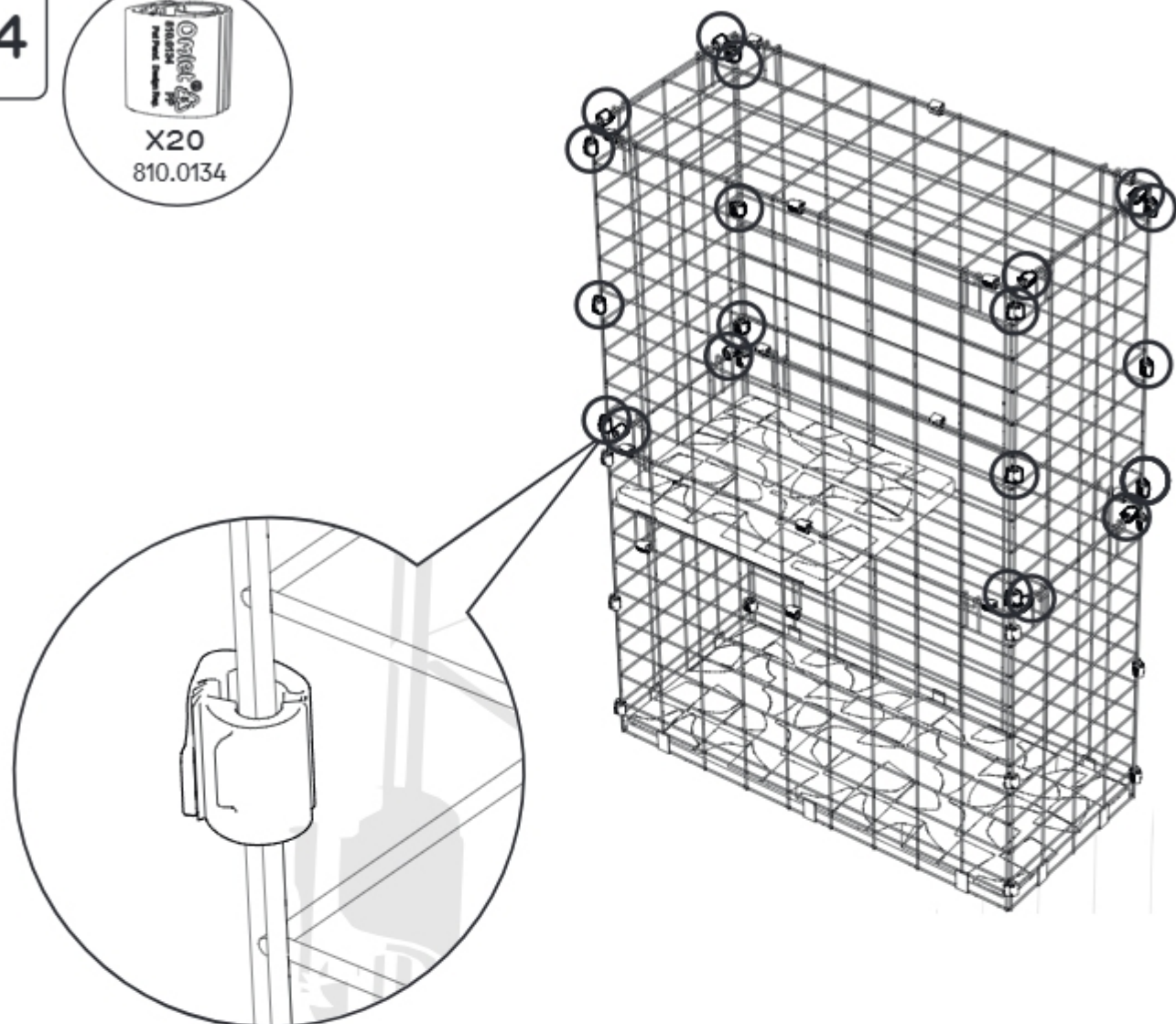

! Tower complete - assemble your remaining modules or go to page 65 and for attachment options of the different modules.

- **DE** Der Turm ist fertig – bauen Sie Ihre restlichen Module zusammen oder lesen Sie ab Seite 65 nach, wie Sie die verschiedenen Module aneinander befestigen können.
- **FR** Tour terminée – assemblez les éléments restants ou allez à la page 65 pour les options de fixation des différents éléments.
- **NL** Toren compleet - monteer de overige modules of ga naar pagina 65 en de daaropvolgende voor bevestigingsopties van verschillende modules.
- **IT** Torre terminata - assemblare i pezzi rimanenti o andare a pagina 65 e successive per le opzioni di collegamento dei vari pezzi.
- **ES** Torre completa - monte los módulos restantes o vaya a la página 65 y siguientes para ver las opciones de fijación de los diferentes módulos.
- **SE** Torn komplett - montera dina återstående moduler eller gå till sidan 65 och senare för att se alternativ för fästen för de olika modulerna.
- **DK** Når tårnet er fuldent, så saml dine resterende moduler eller gå til side 65 og følgende for vedhæftningsmuligheder for de forskellige moduler.
- **NO** Tårnet komplett - sett sammen de resterende modulene dine eller gå til side 65 og følgende for festealternativer for de forskjellige modulene.
- **PL** Wieża gotowa — zmontuj pozostałe moduły lub przejdź do strony 65 i spójrz poniżej, aby zapoznać się z opcjami mocowania różnych modułów.

15

2m + Tower Assembly



- DE 2m+ Turmmontage
- FR 2 m + Assemblage de la tour
- NL 2m + Tunnelmontage
- IT 2m + Assemblaggio della torre
- ES 2m + Montaje de la torre
- SE 2m + montering av torn
- DK 2m + montering af tårn
- NO 2m + Tårnmontering
- PL 2m + montaż wieży

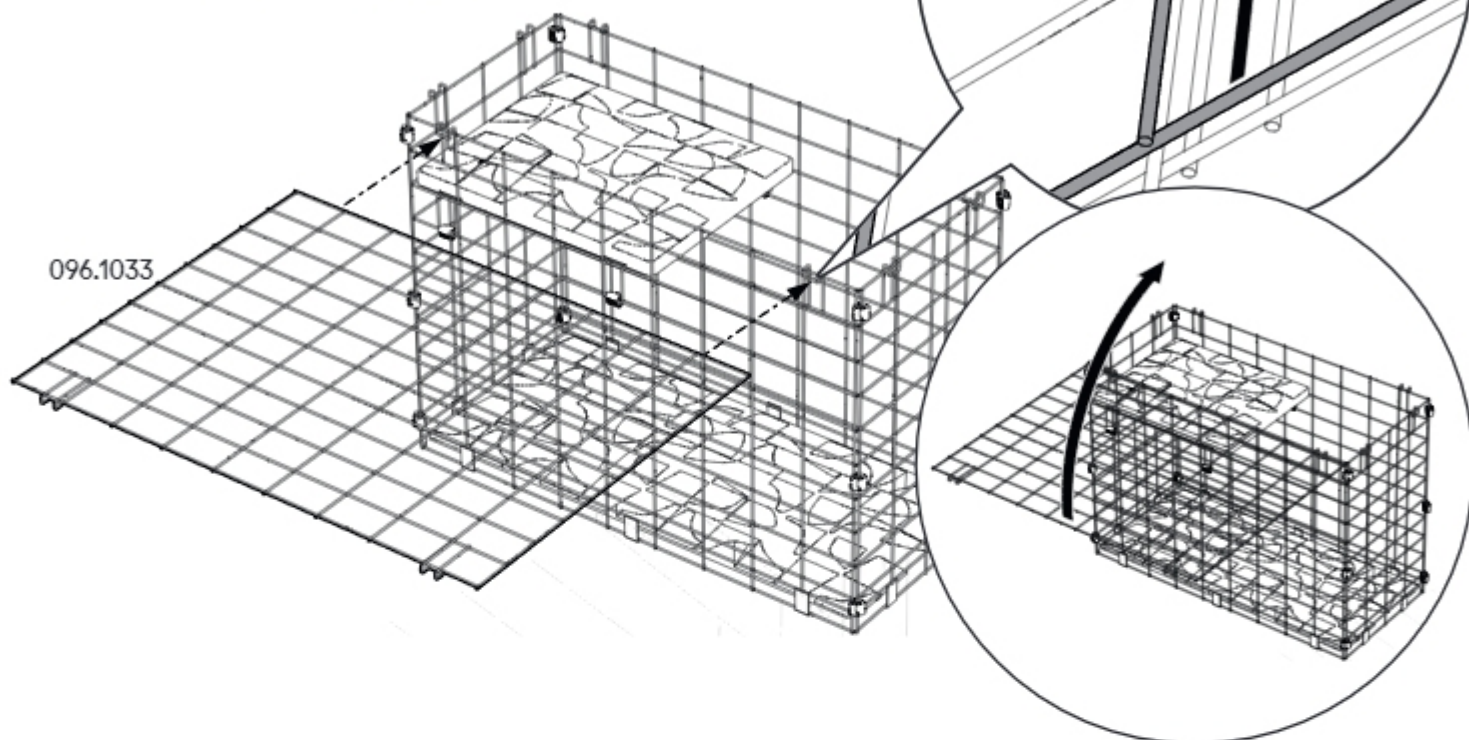

16



X6

810.0134

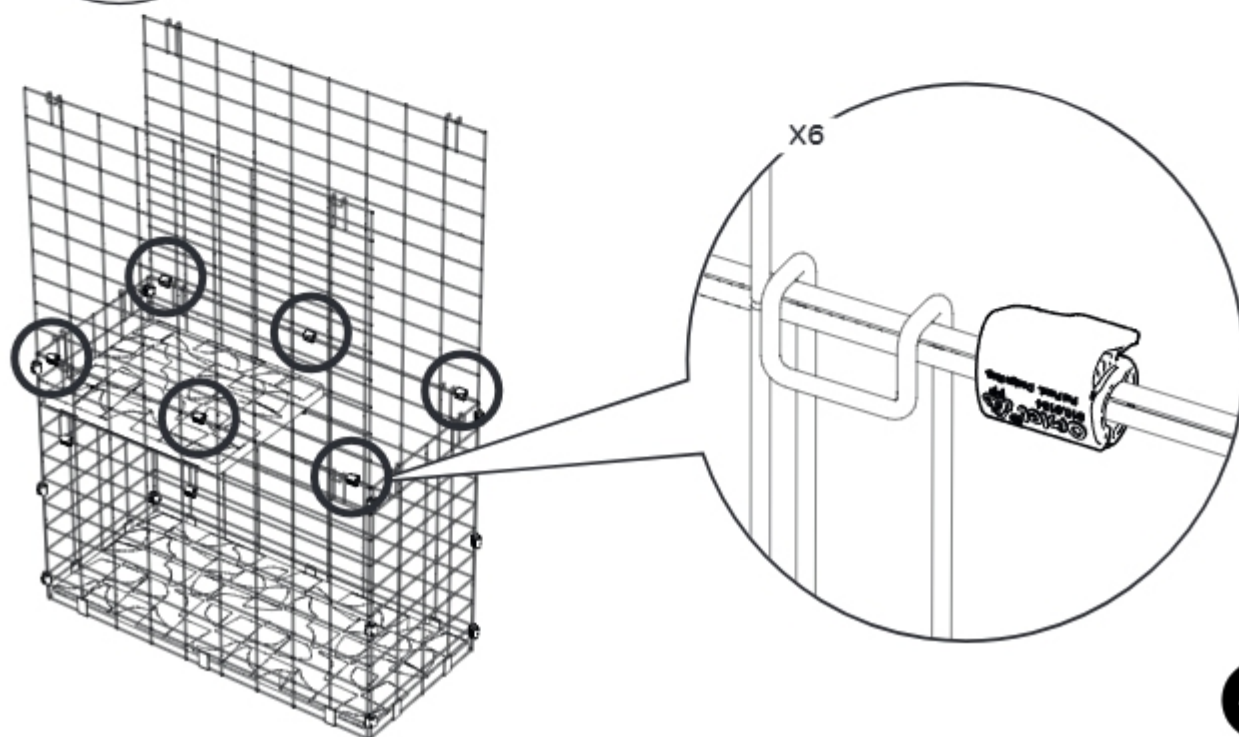

17

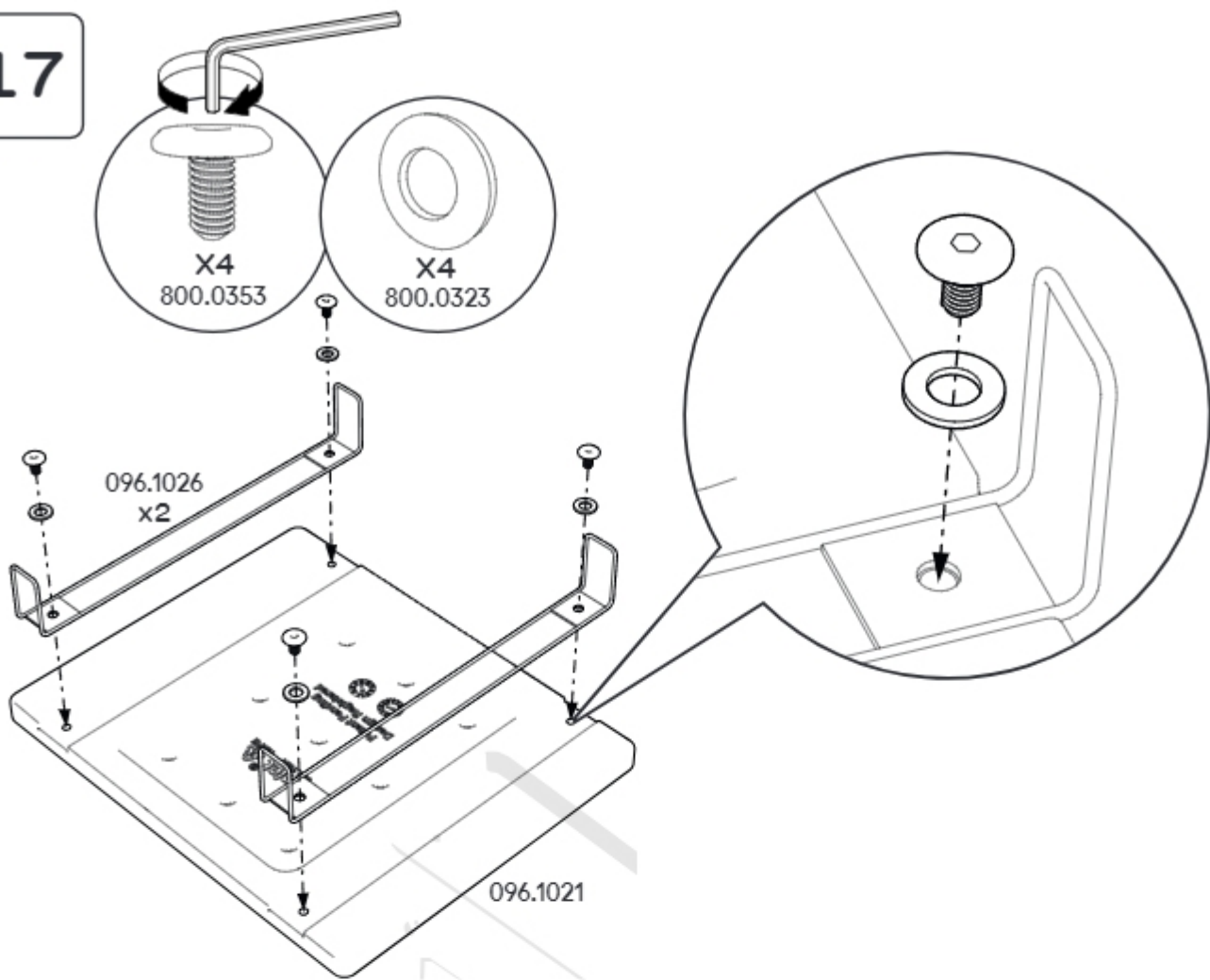

18

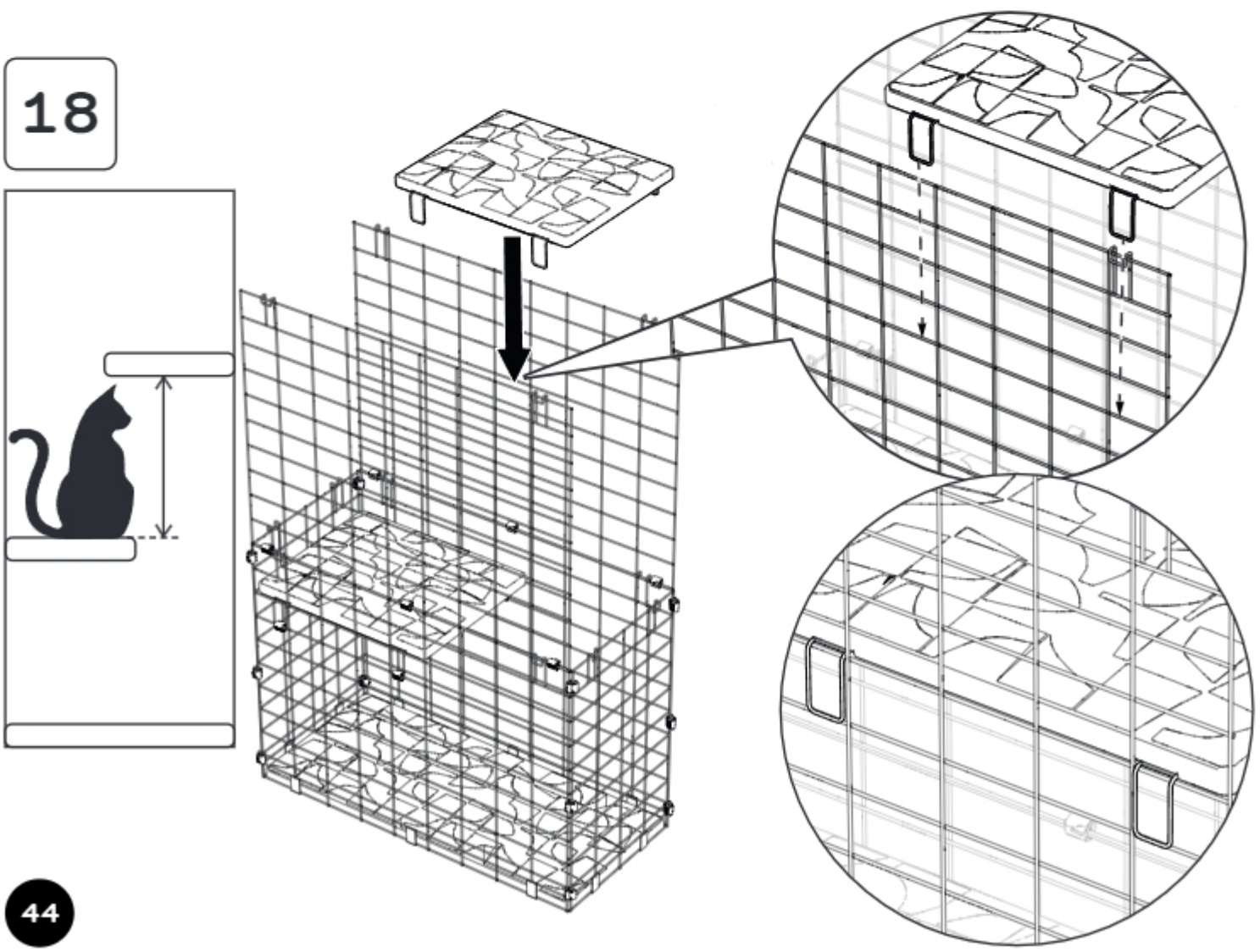

19

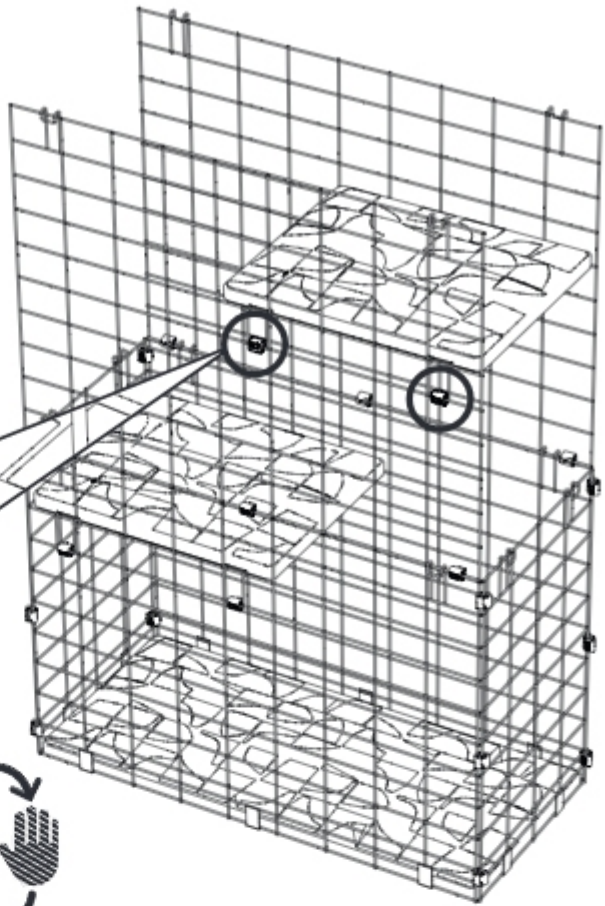
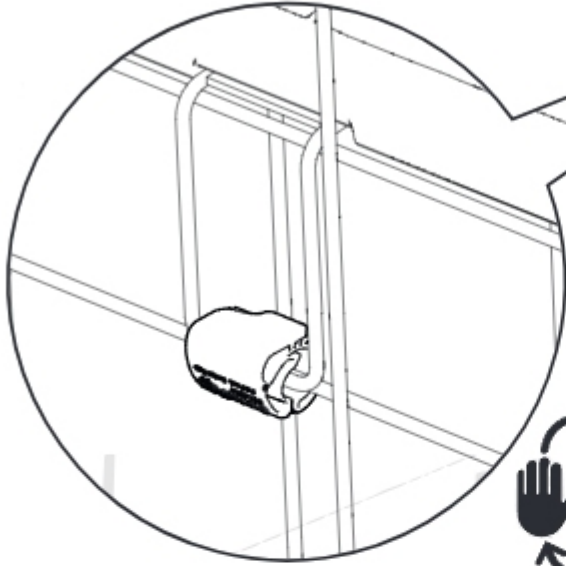

20

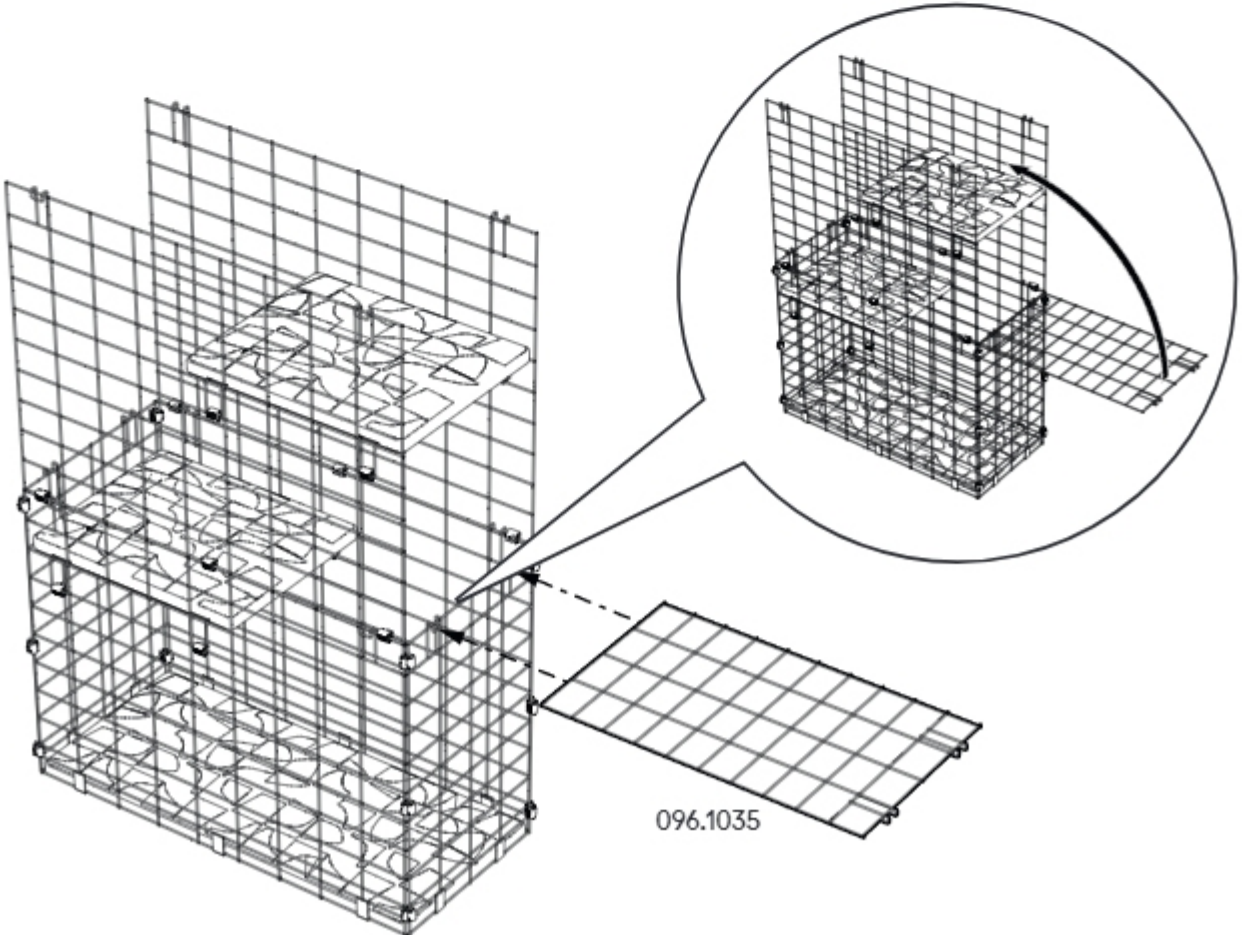

21

X16
810.0134

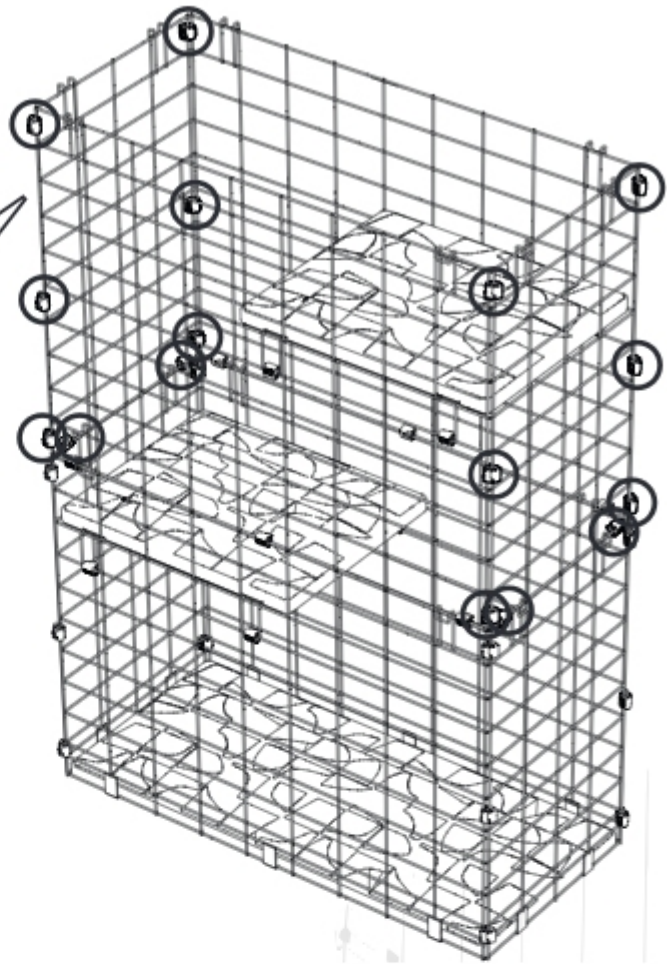
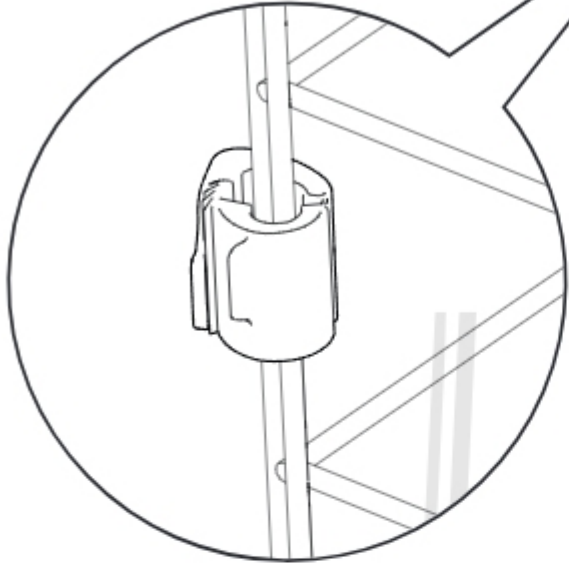

Repeat steps 15 to 21 for all extension levels - We recommend configuring your tower steps to suit the size and athleticism of your cat.

- **DE** Wiederholen Sie Schritte 15–21 für alle Erweiterungsebenen – wir empfehlen, die Stufen des Turms an die Größe und die Beweglichkeit Ihrer Katze anzupassen.
- **FR** Répétez les étapes 15 à 21 pour tous les niveaux d'extension. Nous vous recommandons de positionner les marches de votre tour en fonction de la taille et des capacités athlétiques de votre chat.
- **NL** Herhaal stappen 15 - 21 voor alle uitbreidingsniveaus - Wij raden aan de treden van de toren aan te passen aan de grootte en behendigheid van de kat.
- **IT** Ripetere gli step 15-21 per tutti i livelli di estensione - Consigliamo di posizionare i gradini della torre in base alle dimensioni e all'agilità del vostro gatto.
- **ES** Repita los pasos 15- 21 para todos los niveles de extensión - Recomendamos configurar los escalones de su torre para adaptarlos al tamaño y condición atlética de su gato.
- **SE** Upprepa steg 15-21 för alla förlängningsnivåer - Vi rekommenderar att du anpassar dina tornsteg för att passa din katts storlek och atletiska förmåga.
- **DK** Gentag trin 15-21 for alle forlængelsesniveauer - Vi anbefaler at konfigurere dine tårntrin, så de passer til din katts størrelse og atletik.
- **NO** Gjenta trinn 15-21 for alle utvidelsesnivåer - Vi anbefaler å konfigurere tårntrinnene dine for å passe kattens størrelse og atletikk.
- **PL** Powtórz kroki 15–21 dla wszystkich poziomów rozbudowy - zalecamy skonfigurowanie stopni wieży tak, aby odpowiadały rozmiarowi i stopniowi wysportowania kota.

22

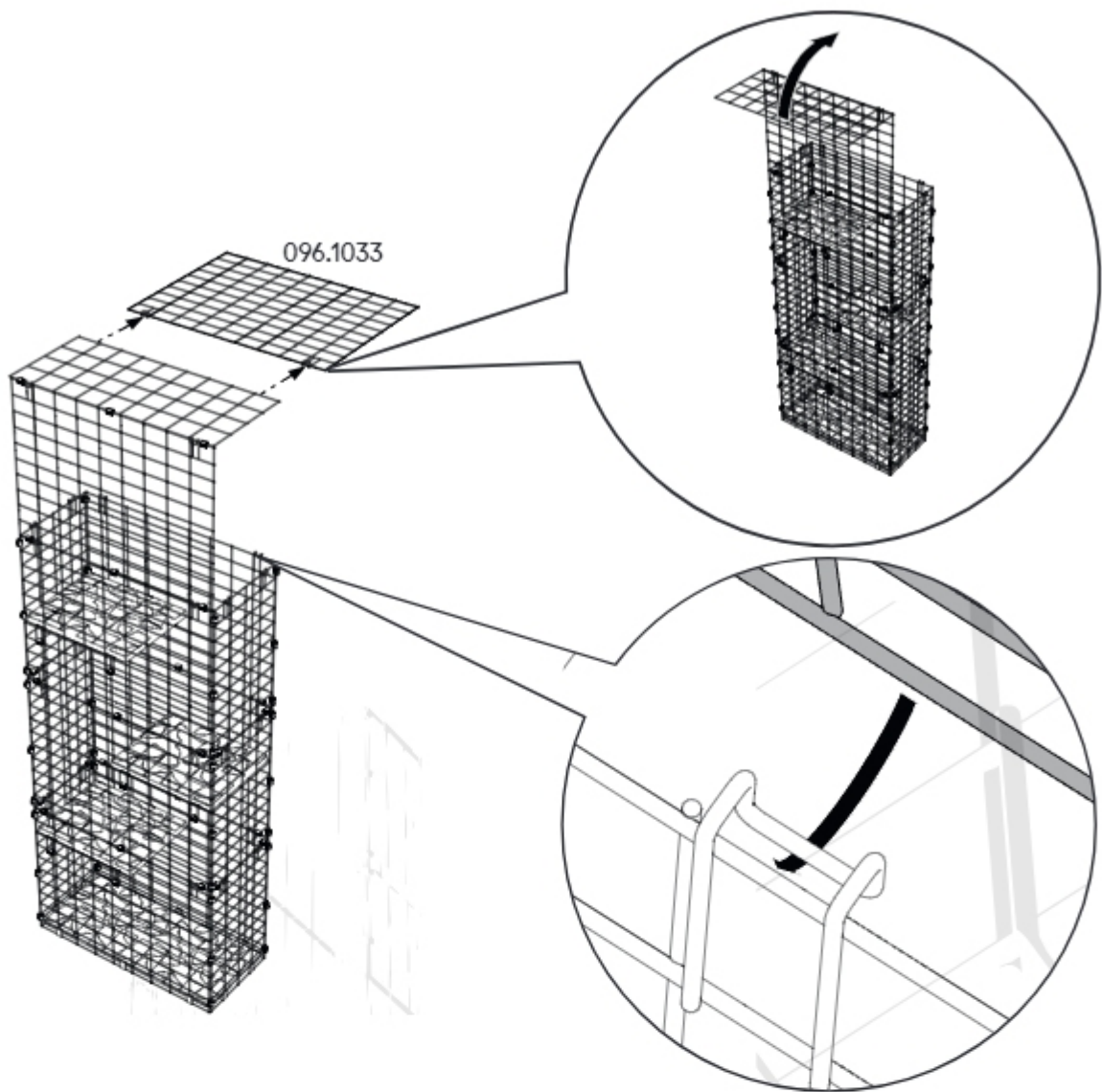

23

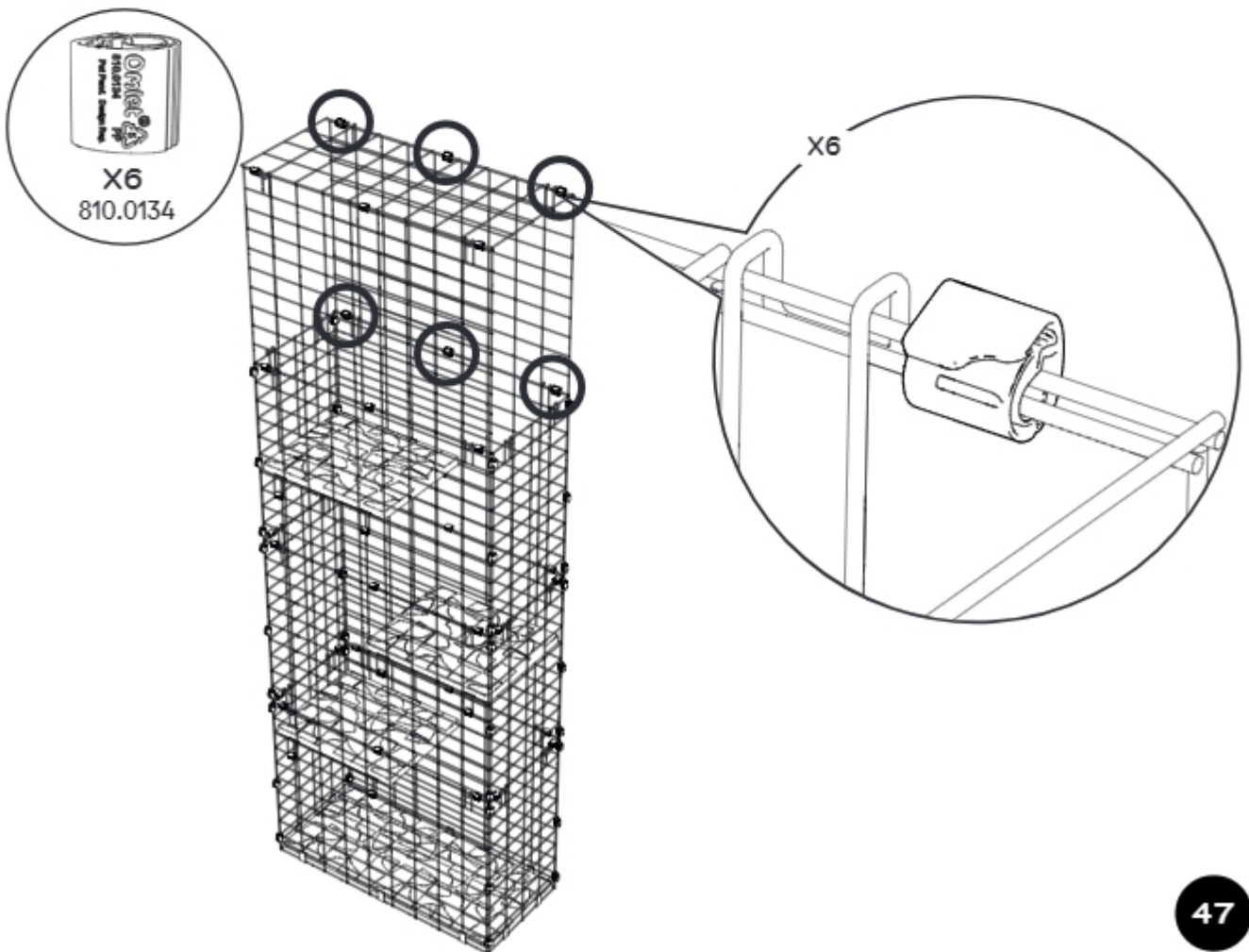

24

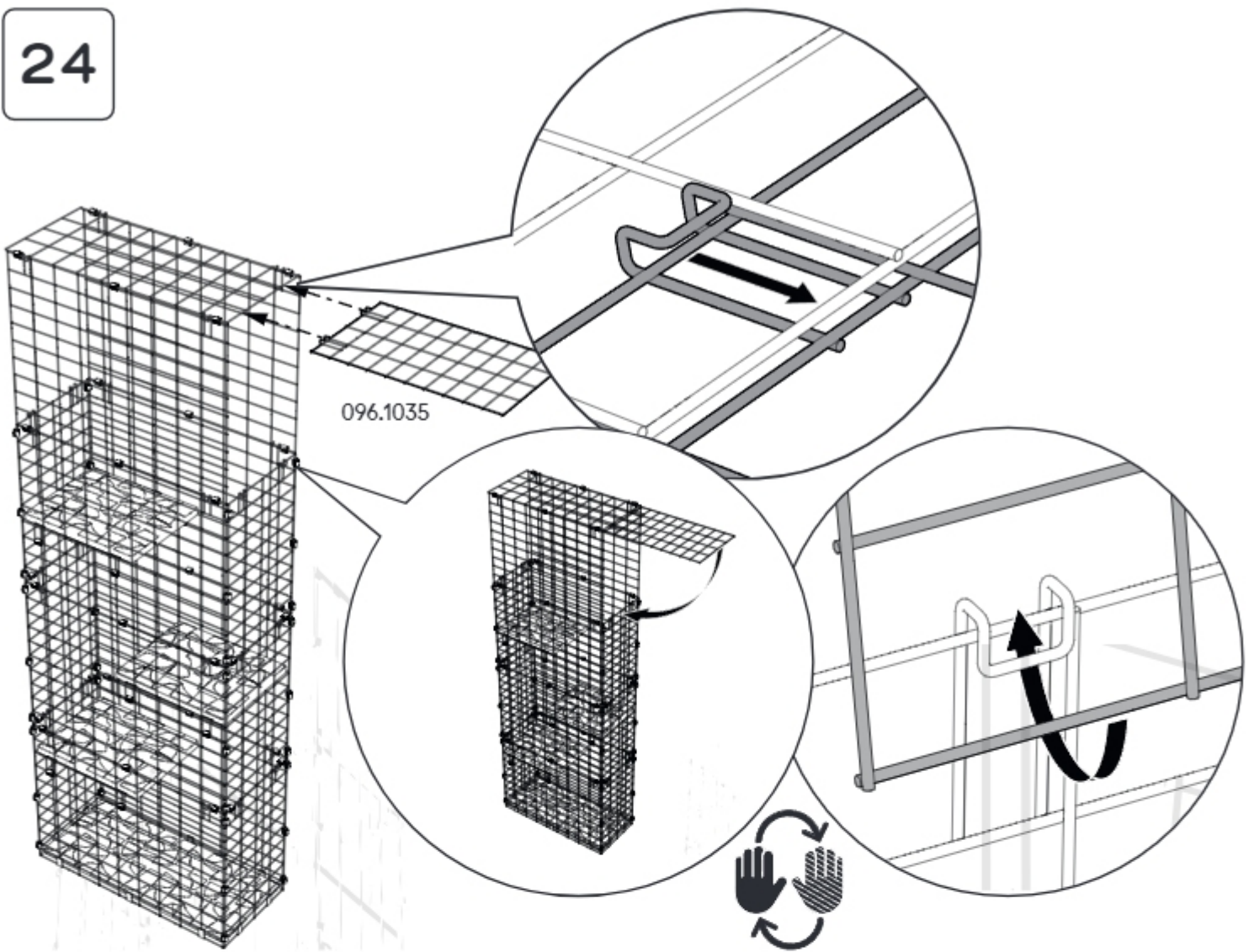

25

