

# WINDOW BOARD

## Module Assembly

DE Zusammenbau des Fenstereinsatzes · FR Assemblage du module Panneau de fenêtre  
NL Assemblage van vensterbordmodules · IT Assemblaggio del modulo pannello finestra  
ES Conjunto de módulo de tablero de ventana · SE Montering av fönsterbrädamodul  
DK Vinduesplademodulsamling · NO Window Board Modul Montering · PL Montaż modułu tablicy okiennej

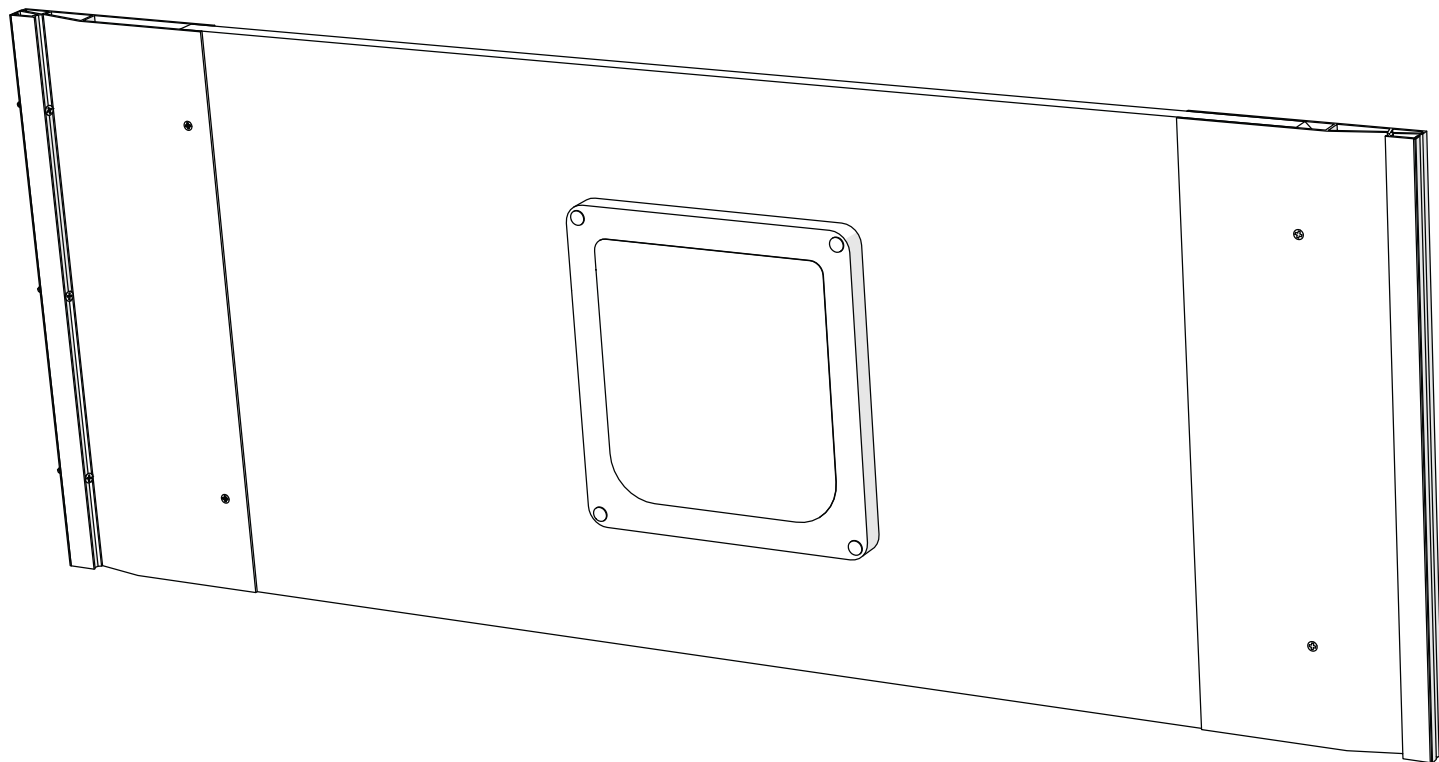

## What you have received

DE Das haben Sie erhalten · FR Ce que vous avez reçu · NL Wat u heeft ontvangen · IT Cosa hai ricevuto  
 ES Qué ha recibido · SE Vad du har fått · DK Du har modtaget · NO Hva du har mottatt · PL Co otrzymałeś/eś

### 096.0035 Boxed Window Board

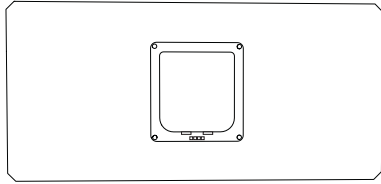

X1  
 Window Board and  
 Cat Door Assembly  
 096.0015

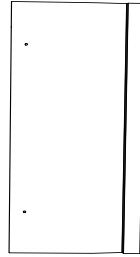

X2  
 Window Board Extrusion  
 with Insulation  
 096.0018



X1  
 Foam Top  
 Insulation Strip  
 096.1113

### 096.0111 : Fixings Pack Window Board

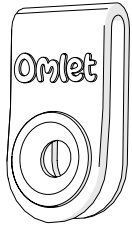

X8  
 Wall Mounting Clip  
 096.1045

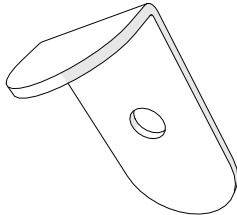

X2  
 Connection Hooks  
 096.1103

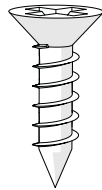

X16  
 Self tapping  
 plastite screw  
 800.0314

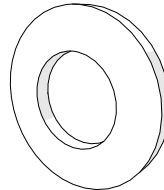

X2  
 Nylon Washer M6  
 800.0323

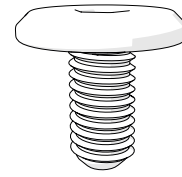

X2  
 M6 x 12mm Bolt  
 800.0353



X6  
 3 x 35mm  
 Woodscrew  
 800.0476

## You will need...

DE Das brauchen Sie... · FR Vous aurez besoin de... · NL Wat u nodig heeft... · IT Avrai bisogno...  
 ES Necesitará... · SE Du behöver... · DK Du skal bruge... · NO Du vil trenge... · PL Czego potrzebujesz...

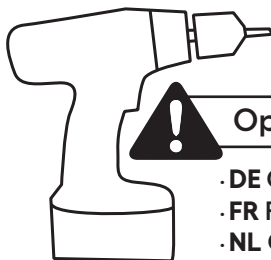
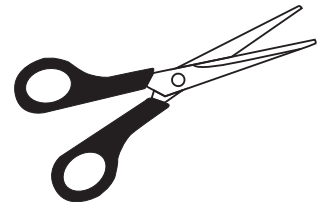
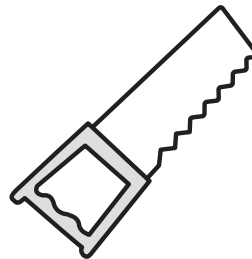
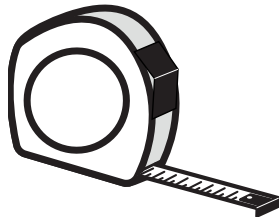
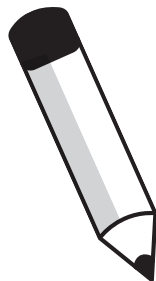
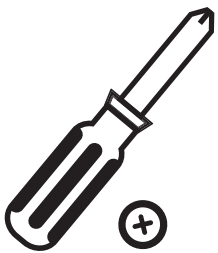

Optional

- DE Optional
- FR Facultatif
- NL Optioneel
- IT Opzionale
- SE Valfri
- DK Valgfri
- NO Valgfritt
- PL Opcjonalnie

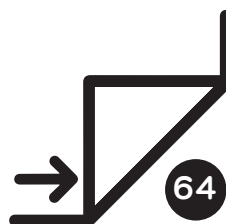

**1****Please measure from the inside of the window track**

- DE Bitte messen Sie von der Innenseite der Fensterschiene aus
- FR Veuillez mesurer depuis l'intérieur du rail de la fenêtre
- NL Meet vanaf de binnenkant van de raamrail
- IT Si prega di misurare dall'interno del binario della finestra
- ES Mida desde el interior del riel de la ventana
- SE Vänligen mät från insidan av fönsterspåret
- DK Mål venligst fra indersiden af vinduessporet
- NO Mål fra innsiden av vindussporet
- PL Proszę mierzyć od wewnętrznej strony prowadnicy okna

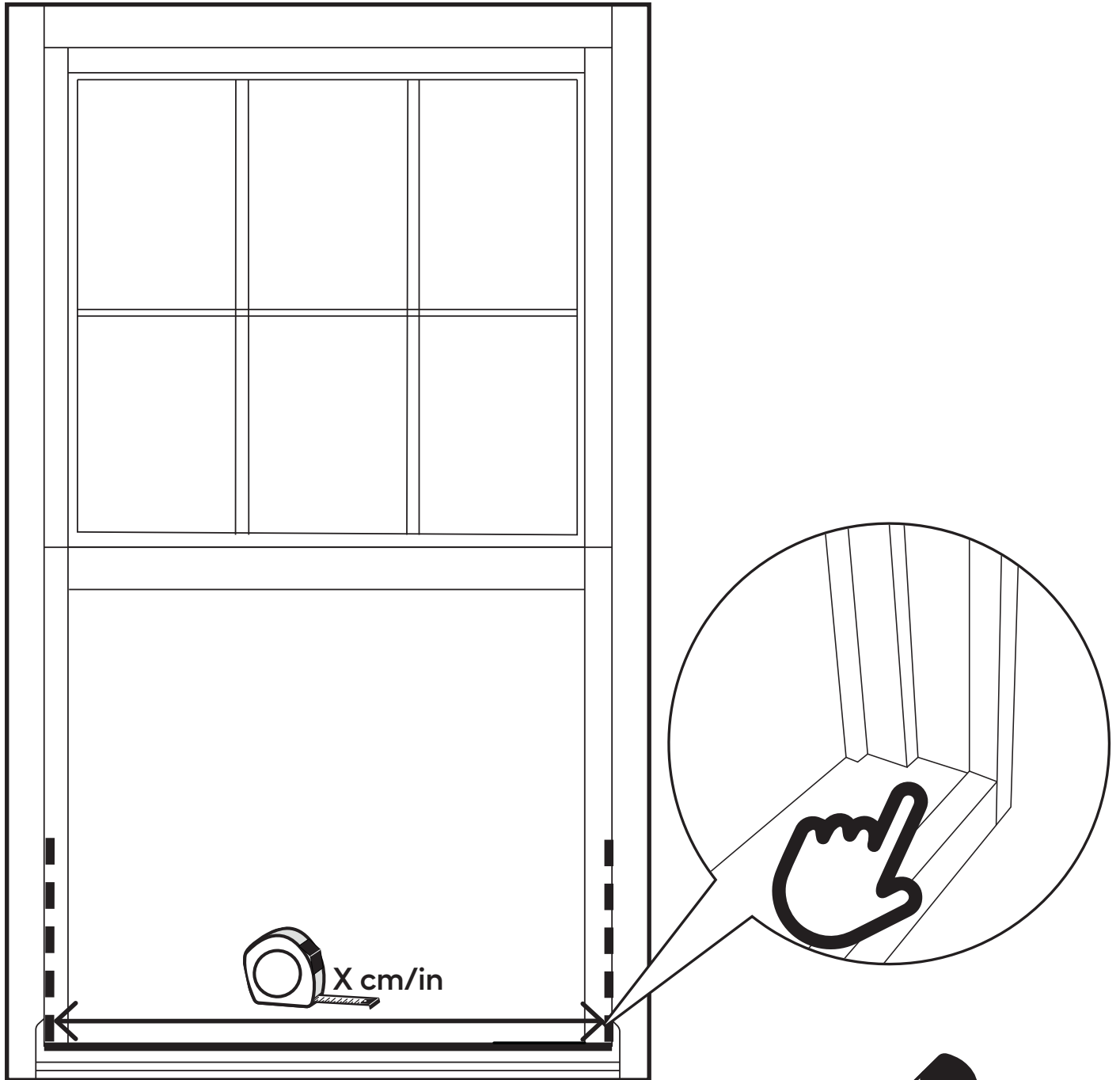
 X cm/inX =  cm/in

2

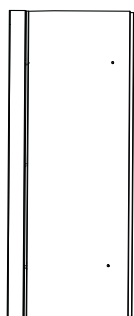
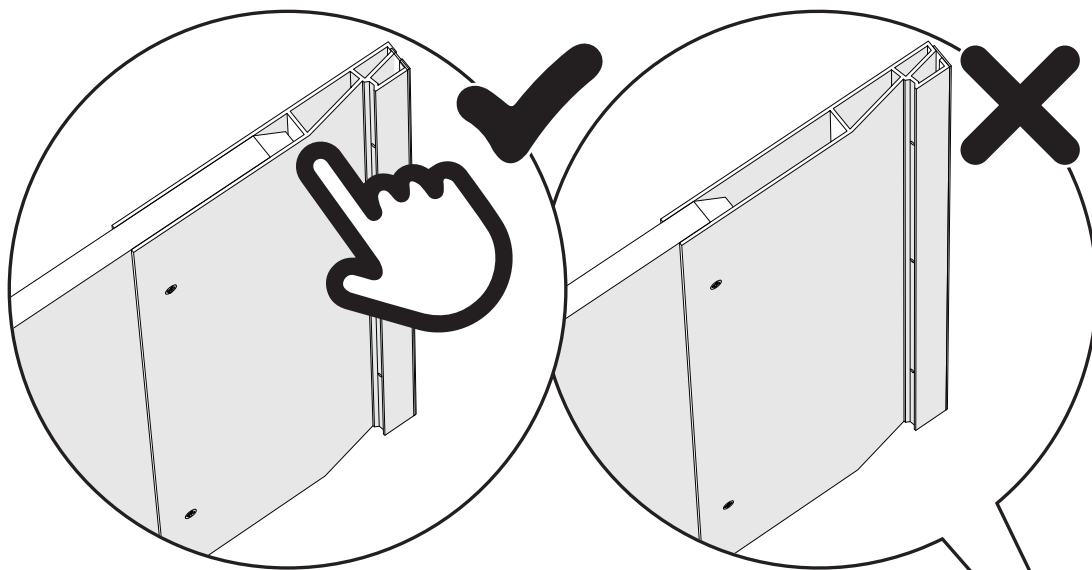

096.0018

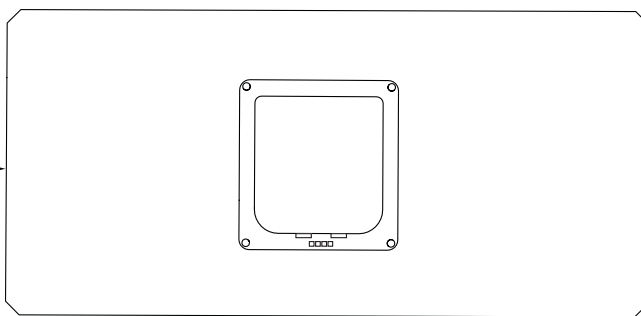

096.0015

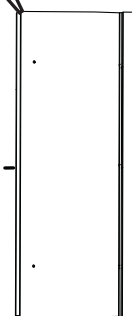

096.0018

3

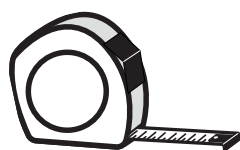

Y cm/in

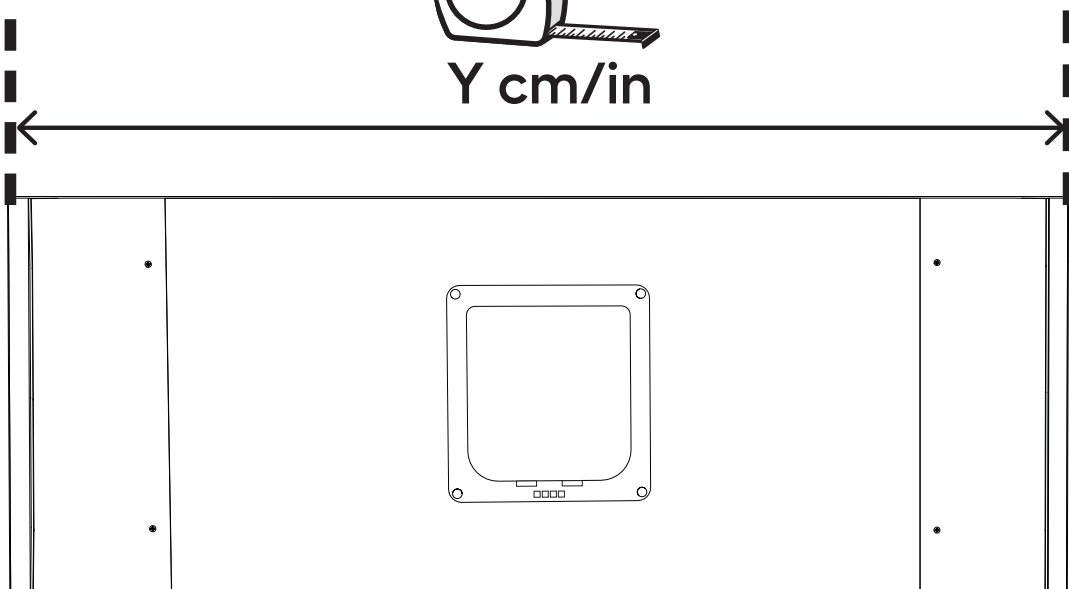

Y =

cm/in

4

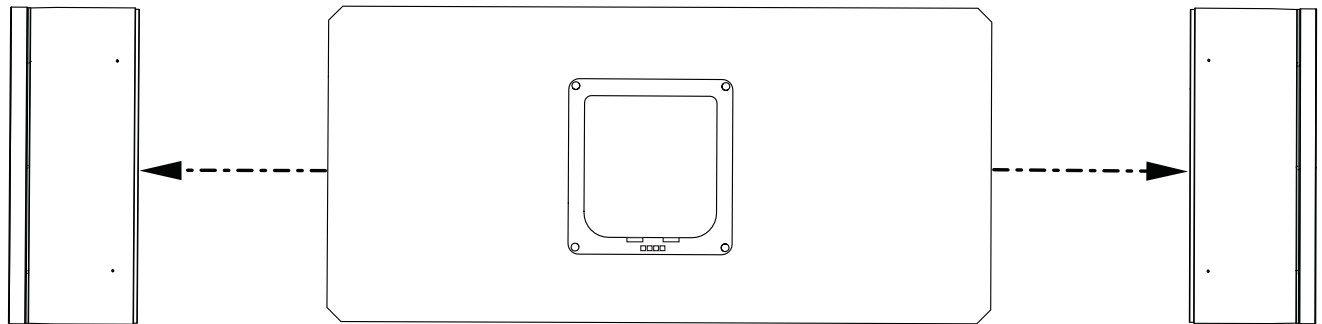

5

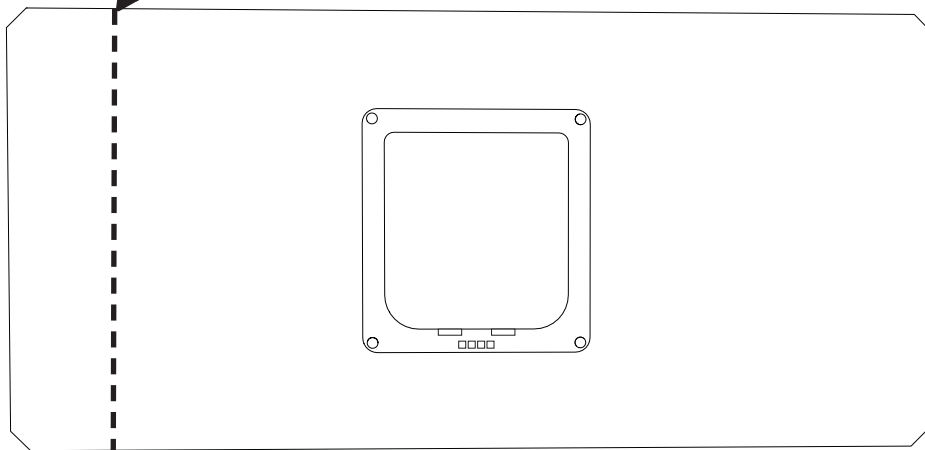
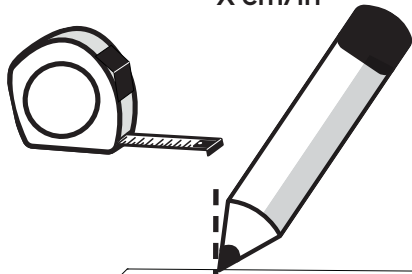
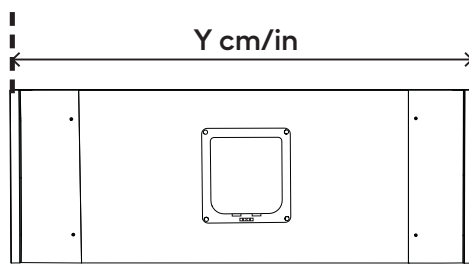
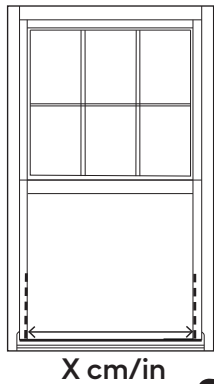

$$(Y-X) \div 2 = Z$$

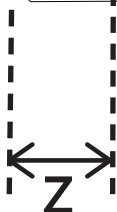

EN Repeat on other side  
 DE Auf der anderen Seite wiederholen  
 FR Répétez l'opération de l'autre côté  
 NL Herhaal aan het andere zijde  
 IT Ripetere sul lato opposto  
 ES Repetir en la otra cara  
 SE Upprepa på andra sidan  
 DK Gentag på den anden side  
 NO Gjenta på den andre siden  
 PL Zrób to samo po drugiej stronie

$$\left( \boxed{\phantom{00}} \text{ cm/in} - \boxed{\phantom{00}} \text{ cm/in} \right) \div 2 = \boxed{\phantom{00}} \text{ cm/in}$$

6

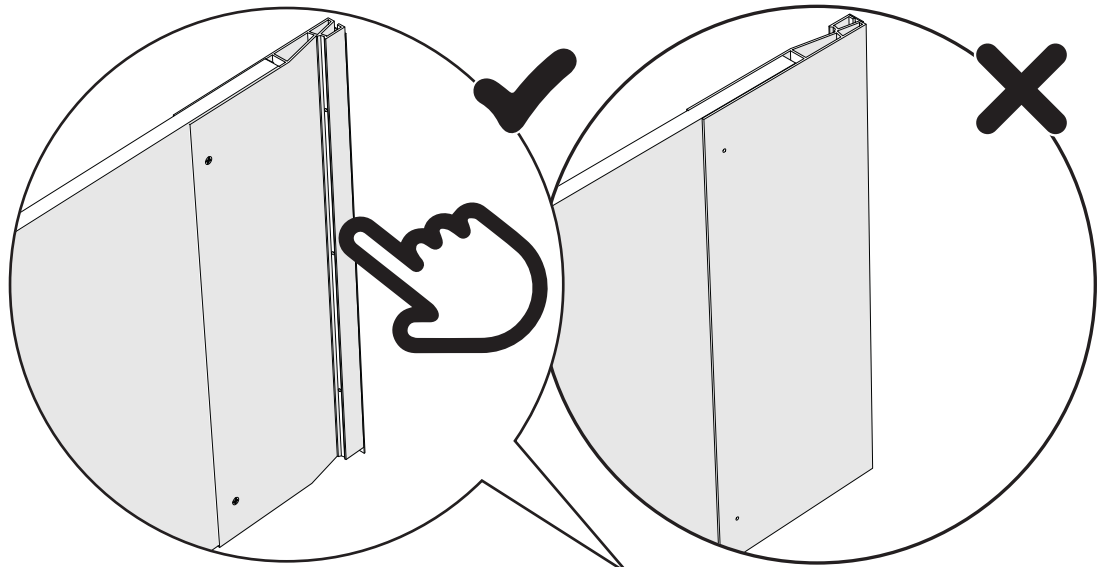
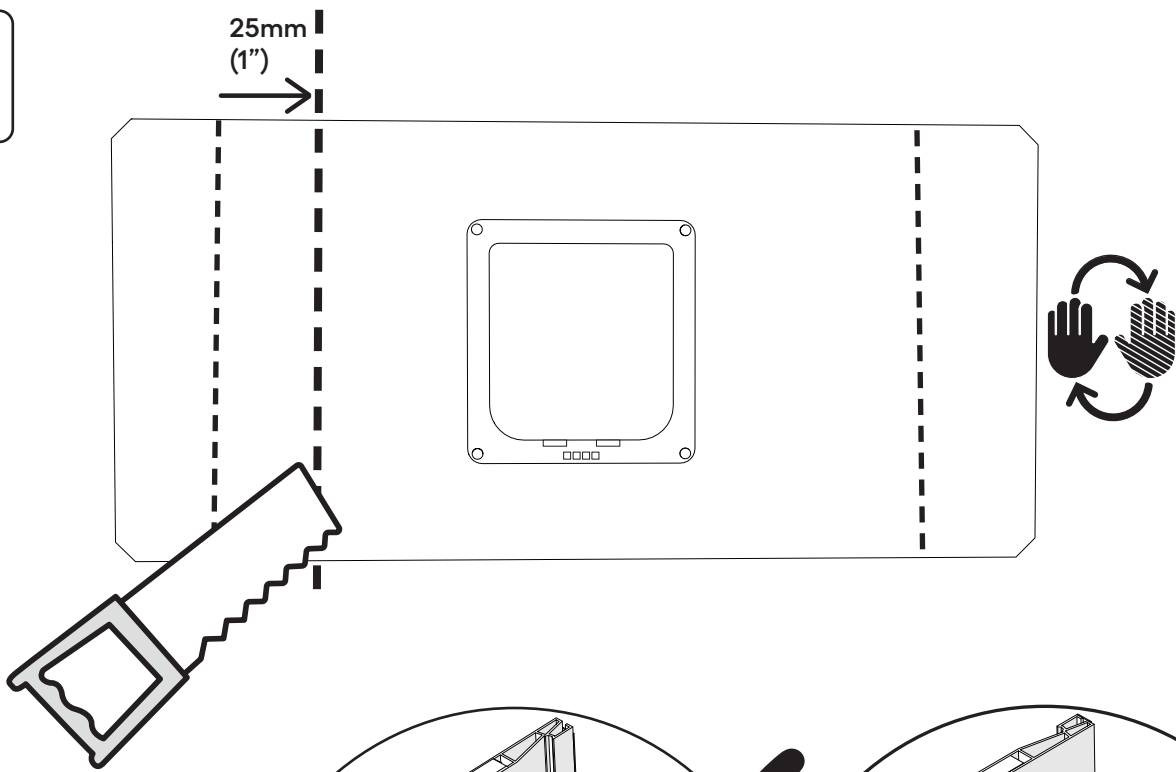

7

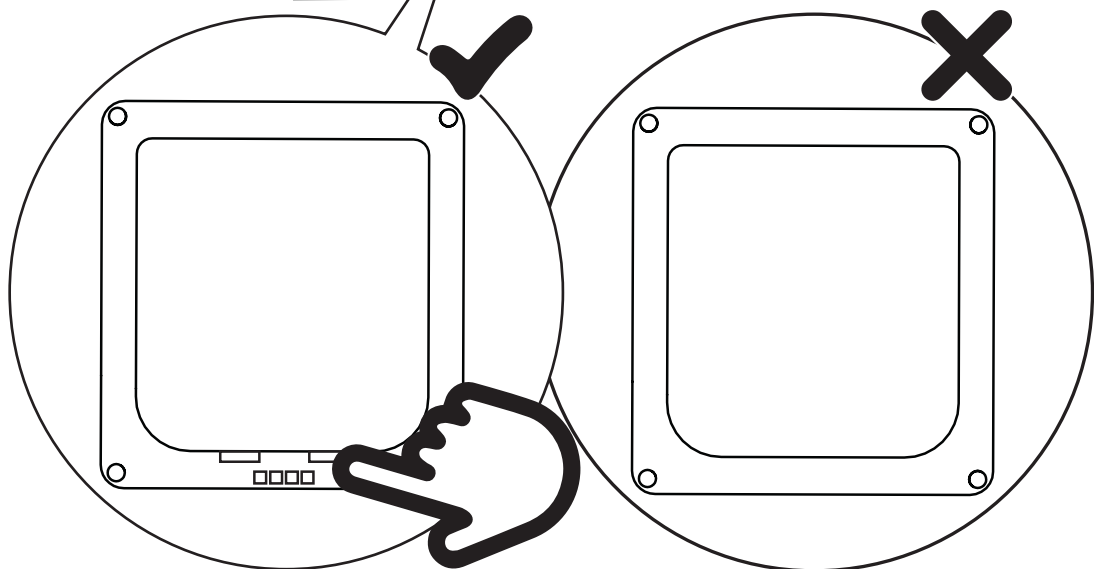
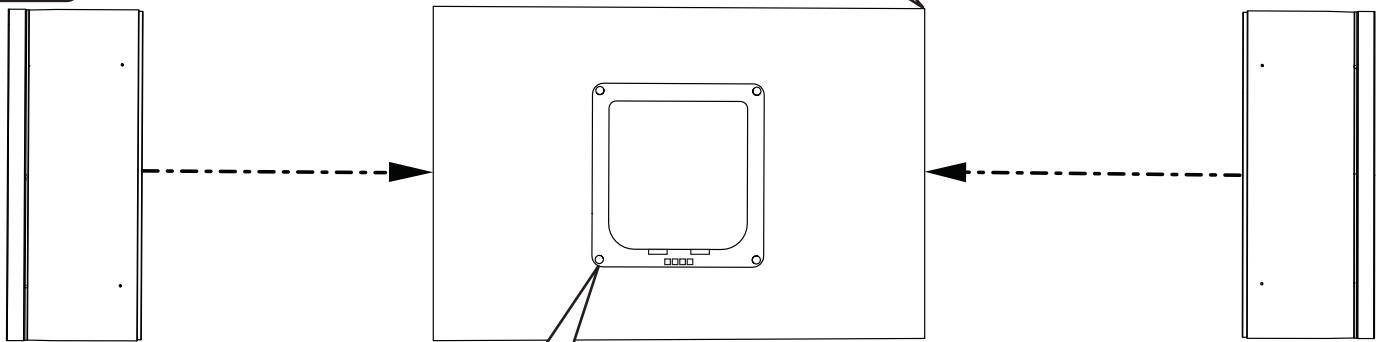

8

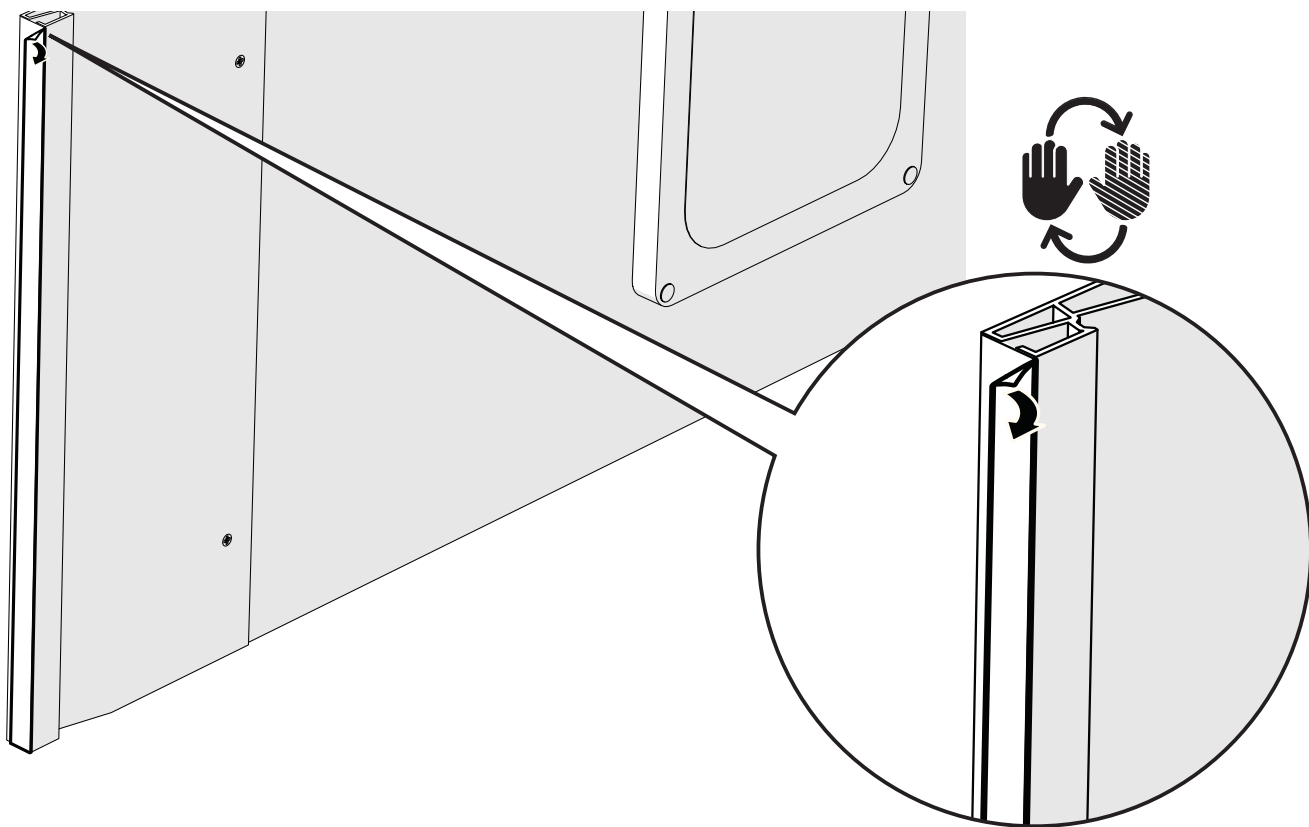

9

Inside the building

DE Im Gebäude · FR à l'intérieur du bâtiment  
 NL In het gebouw · IT All'interno dell'edificio  
 ES Dentro del edificio SE Inne i byggnaden  
 DK Inde i bygningen · NO Inne i bygget · PL W środku budynku

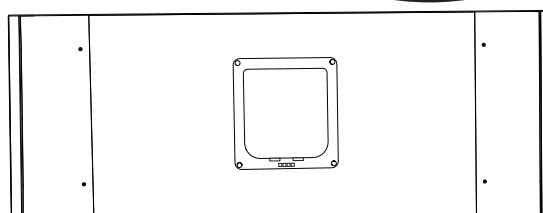
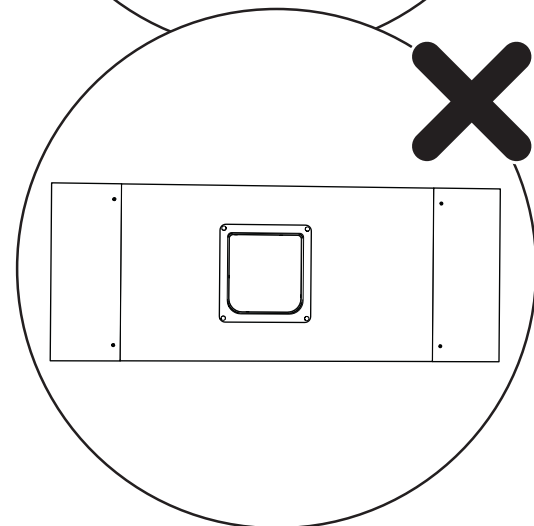
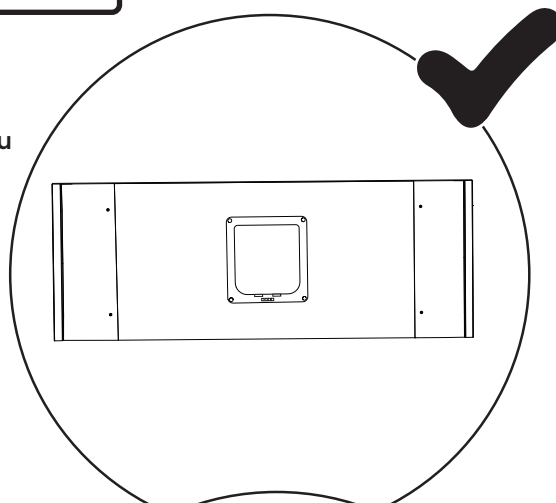
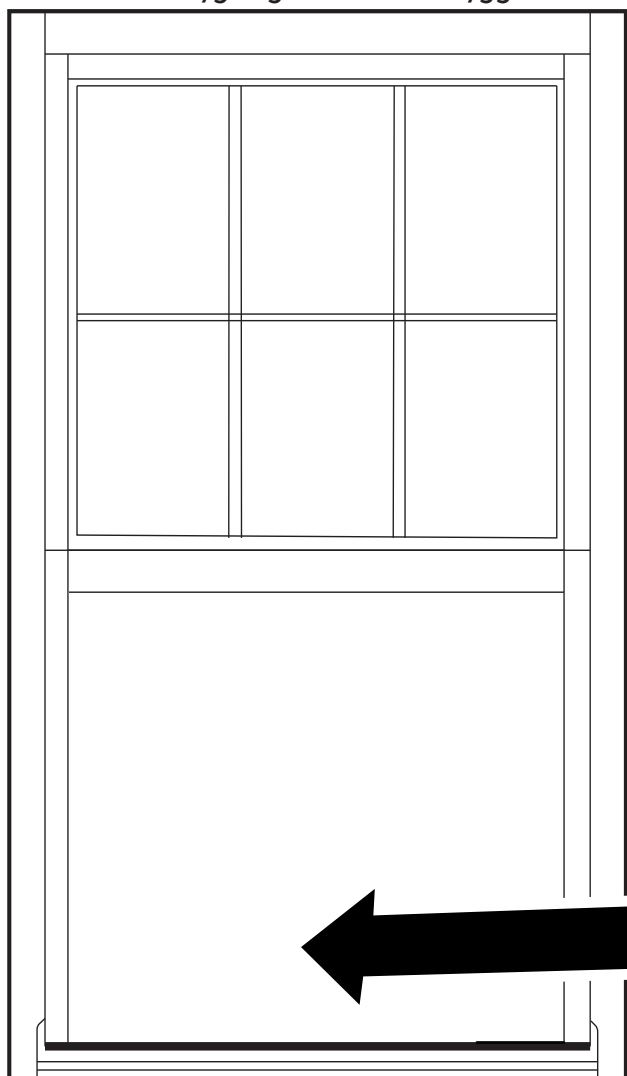

10

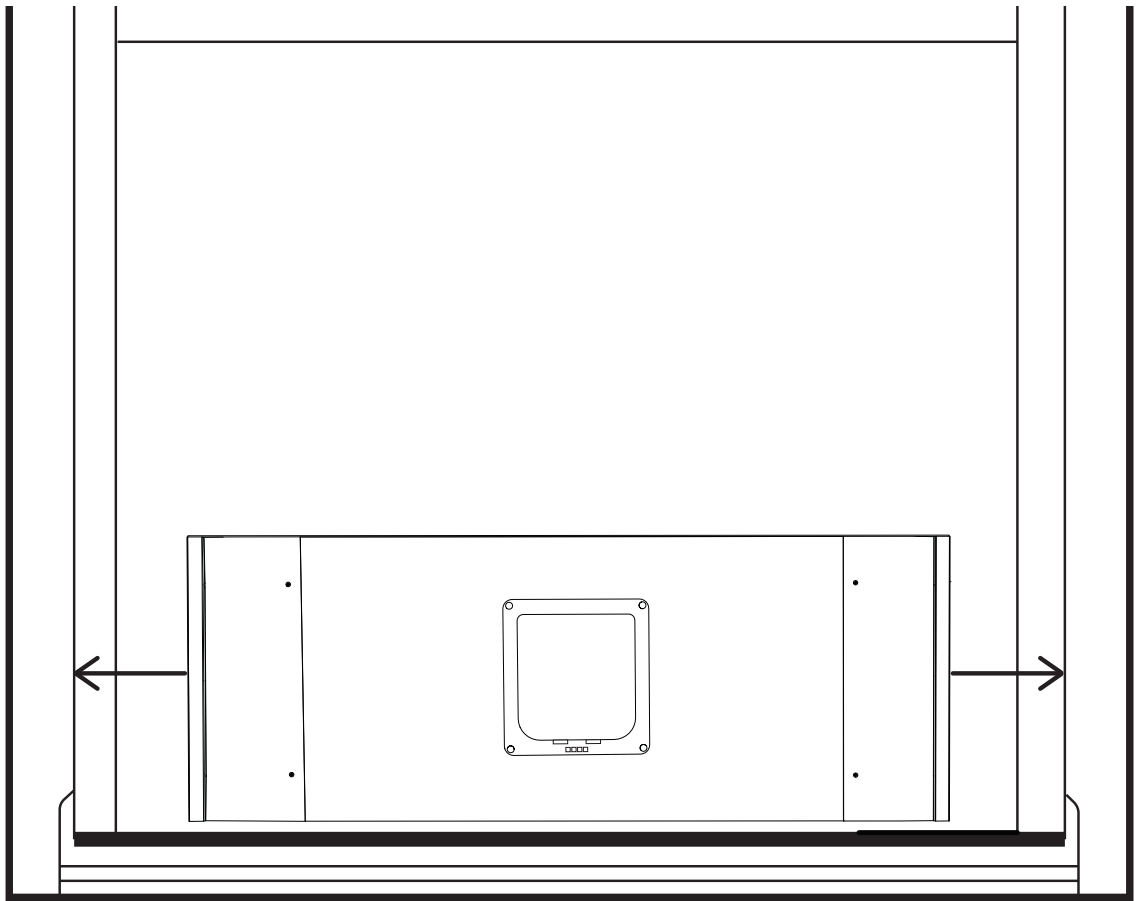

11

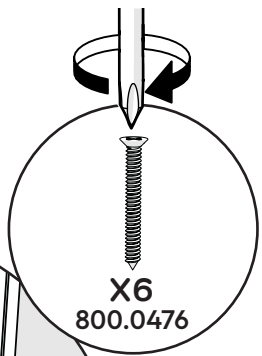
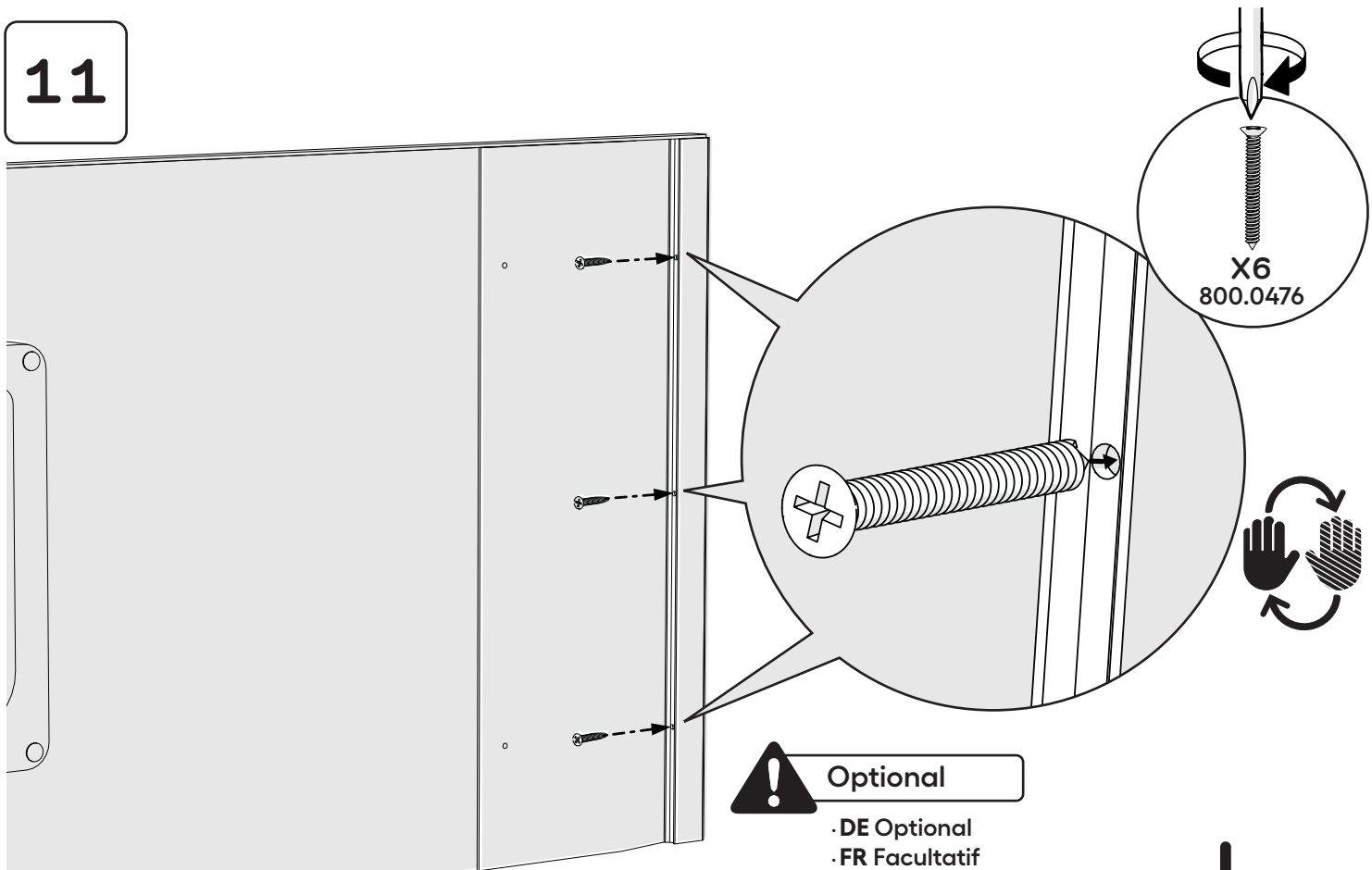

**!** Optional

- DE Optional
- FR Facultatif
- NL Optioneel
- IT Opzionali
- SE Valfri
- DK Valgfri
- NO Valgfritt
- PL Opcjonalnie

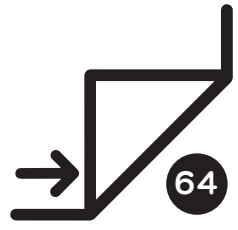



**12****Inside the building**

DE Im Gebäude · FR à l'intérieur du bâtiment · NL In het gebouw · IT All'interno dell'edificio  
ES Dentro del edificio · SE Inne i byggnaden · DK Inde i bygningen · NO Inne i bygget · PL W środku budynku

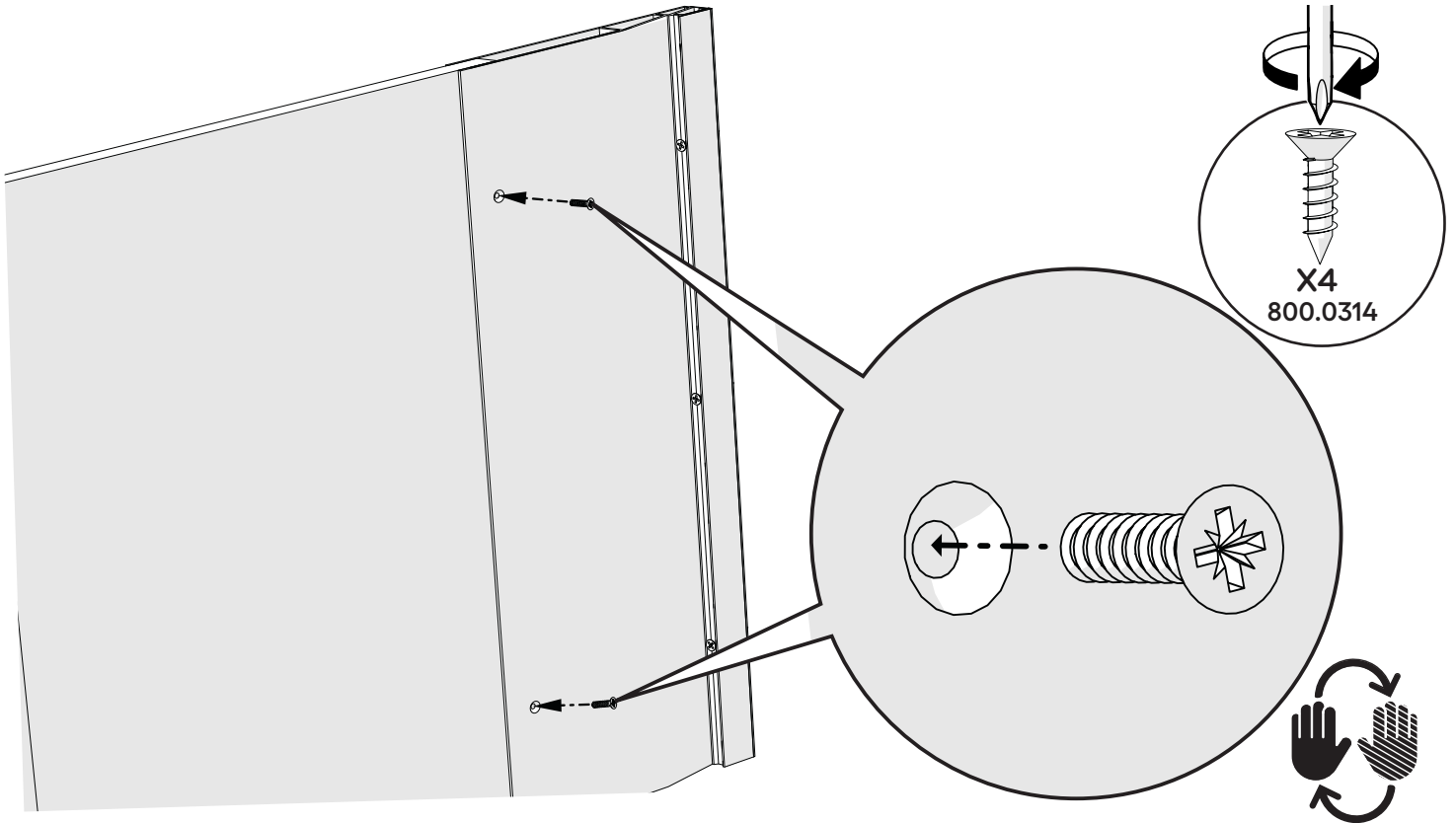
**13****Outside the building**

DE außerhalb des Gebäudes · FR à l'extérieur du bâtiment · NL buiten het gebouw  
IT all'esterno dell'edificio · ES afuera del edificio · SE utanför byggnaden · DK uden for bygningen  
NO utenfor bygget · PL na zewnątrz budynku

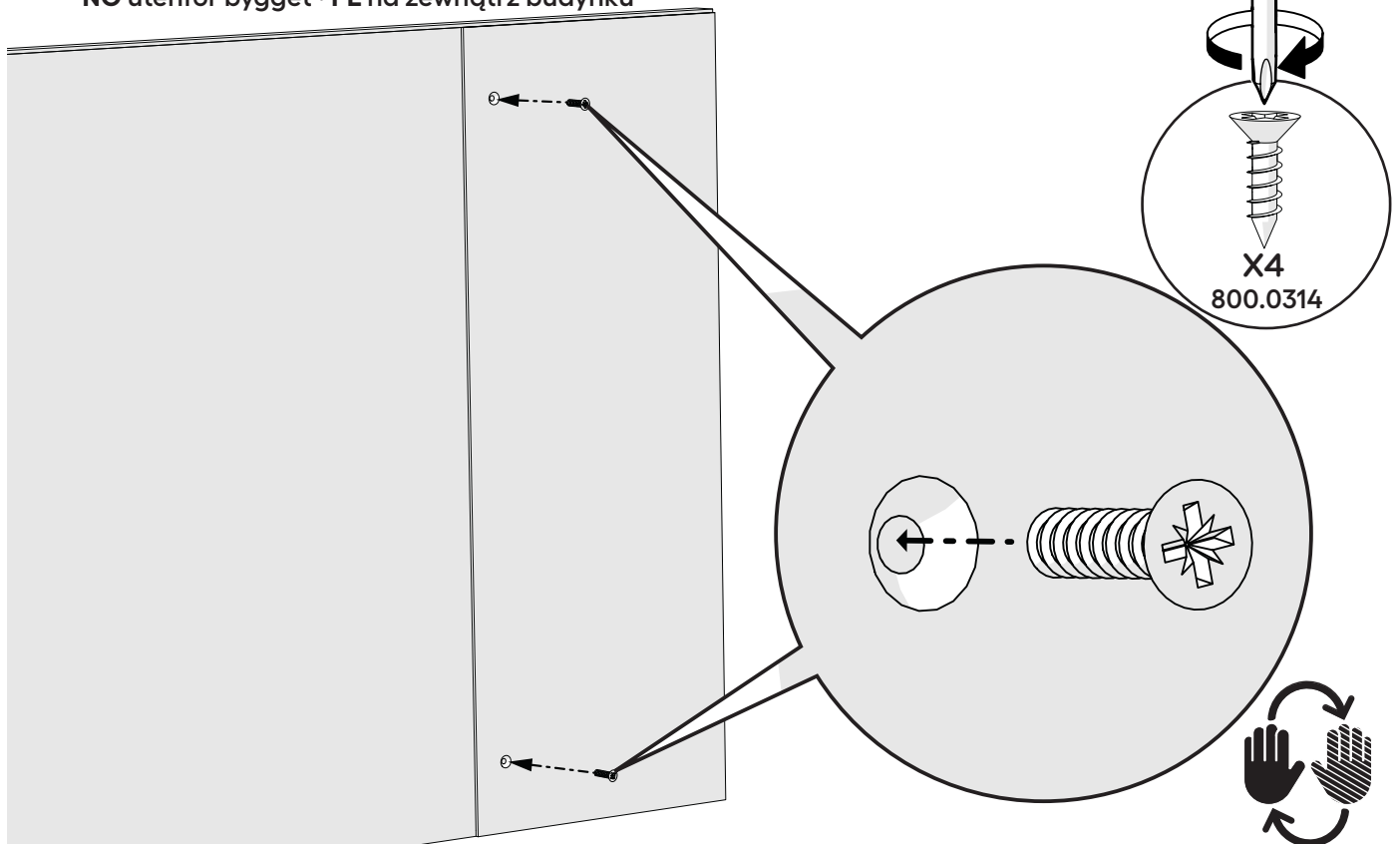

14

= X cm/in

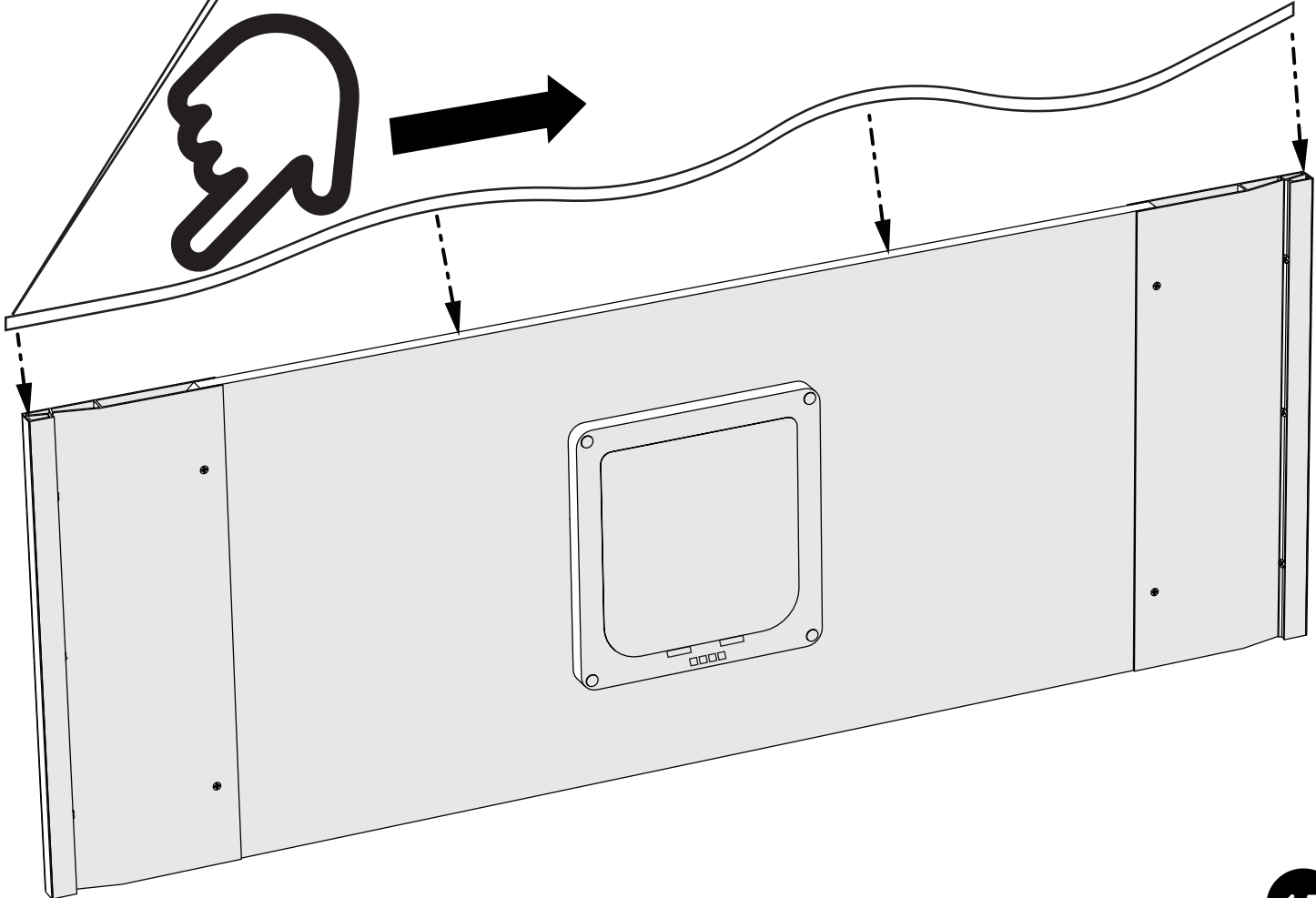
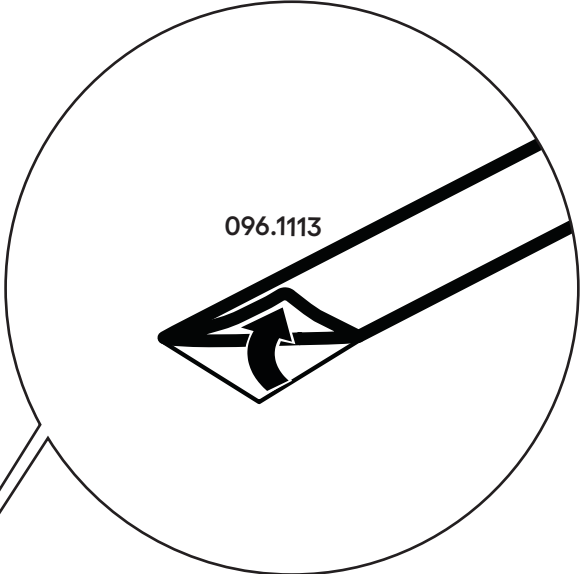
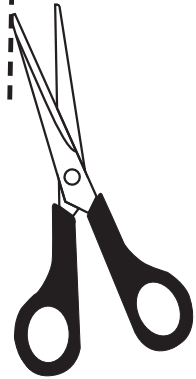
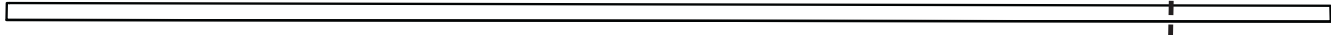
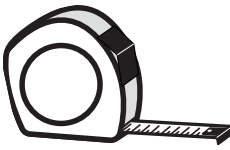

DE SchlieÙe das Fenster · FR Fermez la fenêtre · NL Doe het raam dicht · IT Chiudi la finestra  
ES Cerrar la ventana · SE Stång fönstret · DK Luk vinduet · NO Lukke vinduet · PL Zamknij okno

