

EGLU GO UP

Frame assembly guide



Omlet

What you have received

017.0055: Eglu Go Up Coop Frame Assembly Box

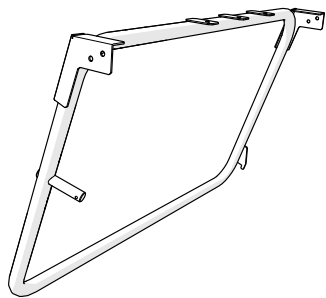

X1

Frame Side Right
017.0045

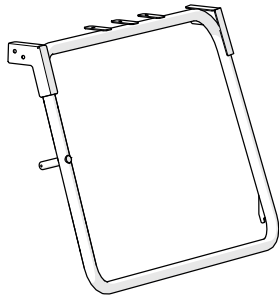

X1

Frame Side Left
017.0046

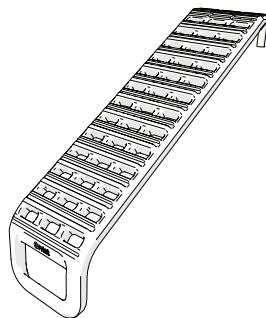

X1

Ladder
114.0075

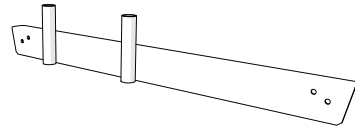

X1

Frame Front
017.0047

017.0060: Fastener Pack

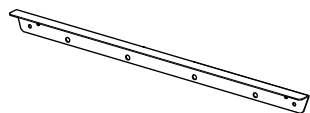

X1

Frame Rear
017.1056

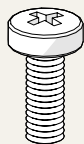

X14

M6 x
16mm
Screw
800.0037



X14

Wing Nut
800.0040



X4

Fixings
Plate
017.1059



X2

Location
Plate
017.1065

You will need...



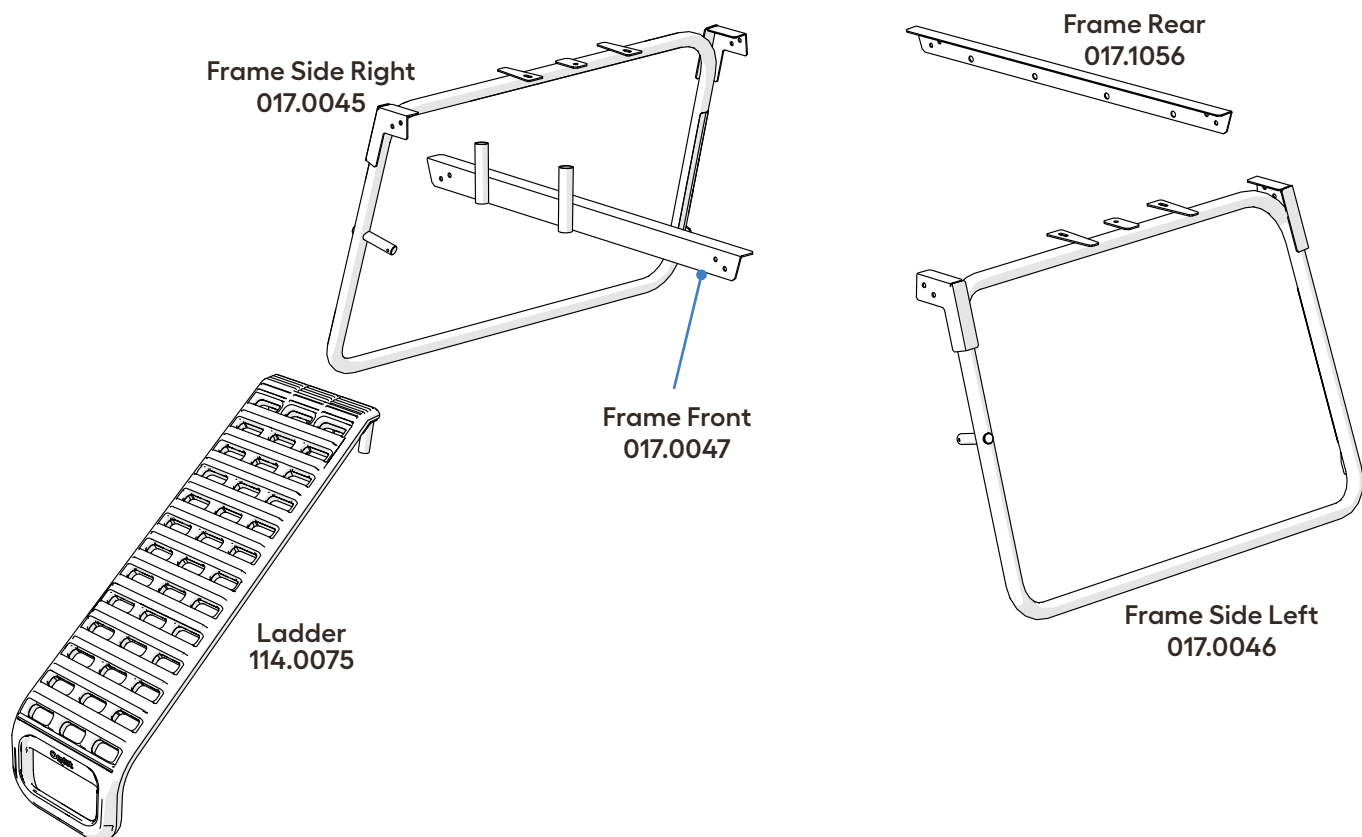

1

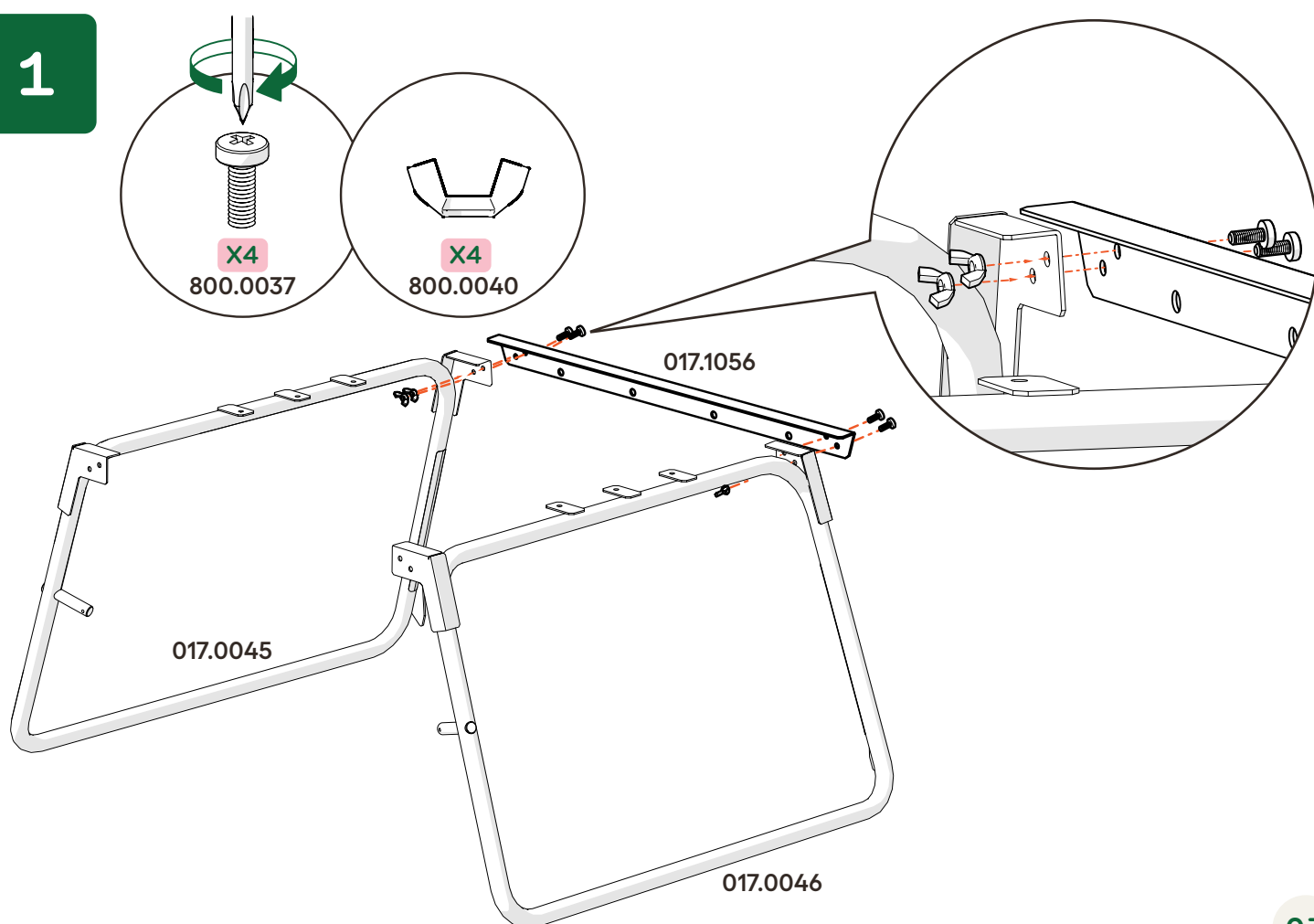

2

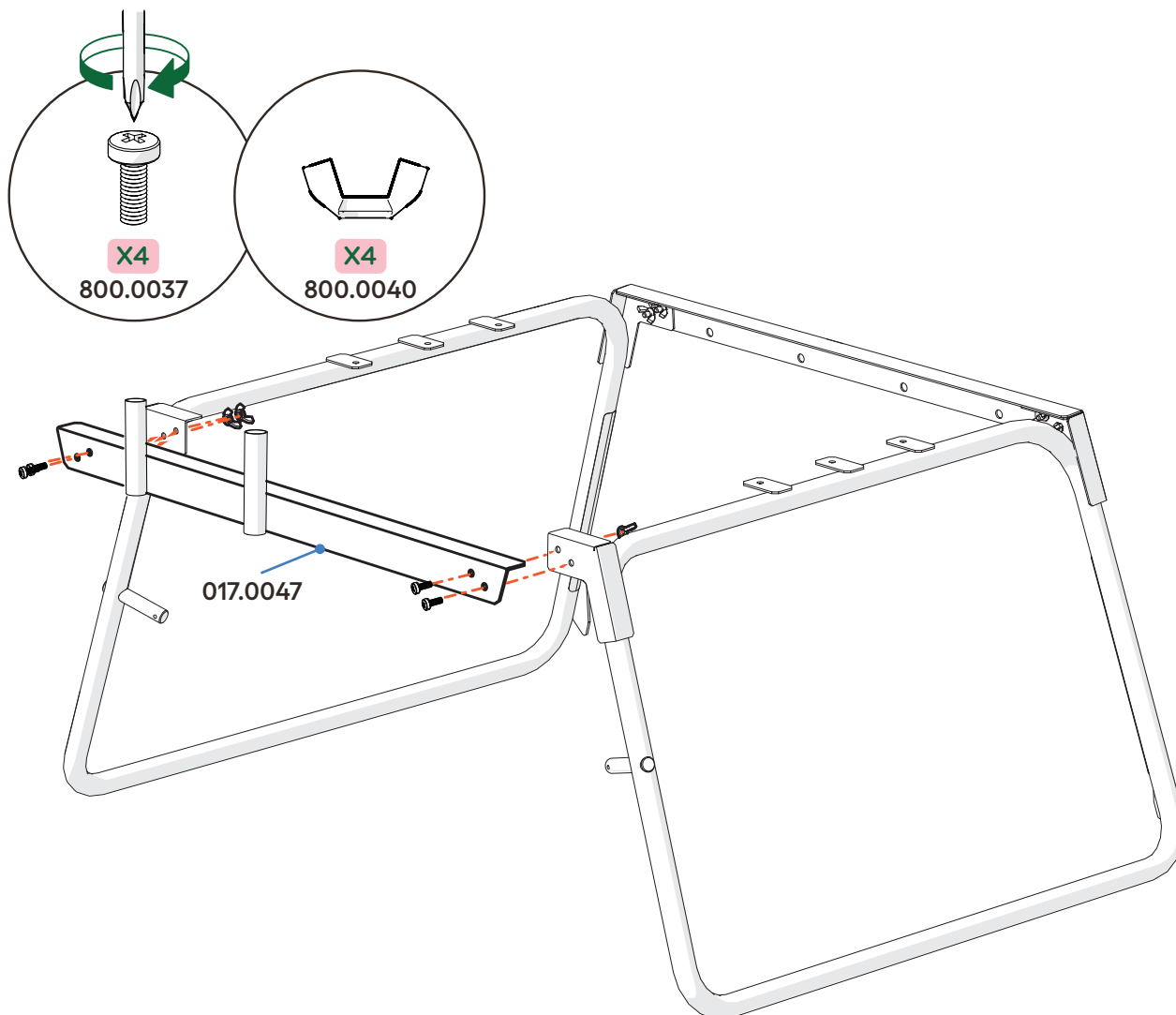

3

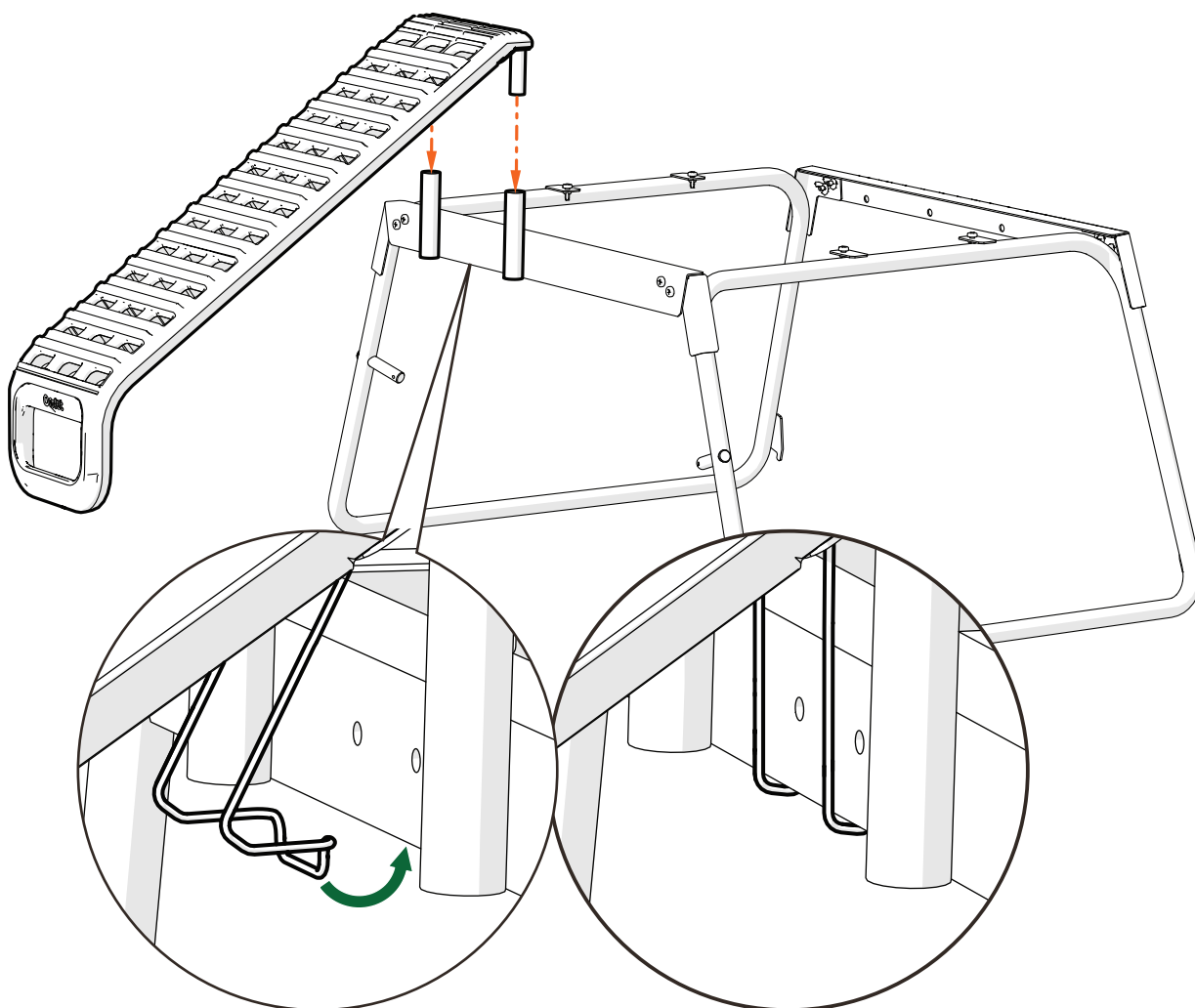

4

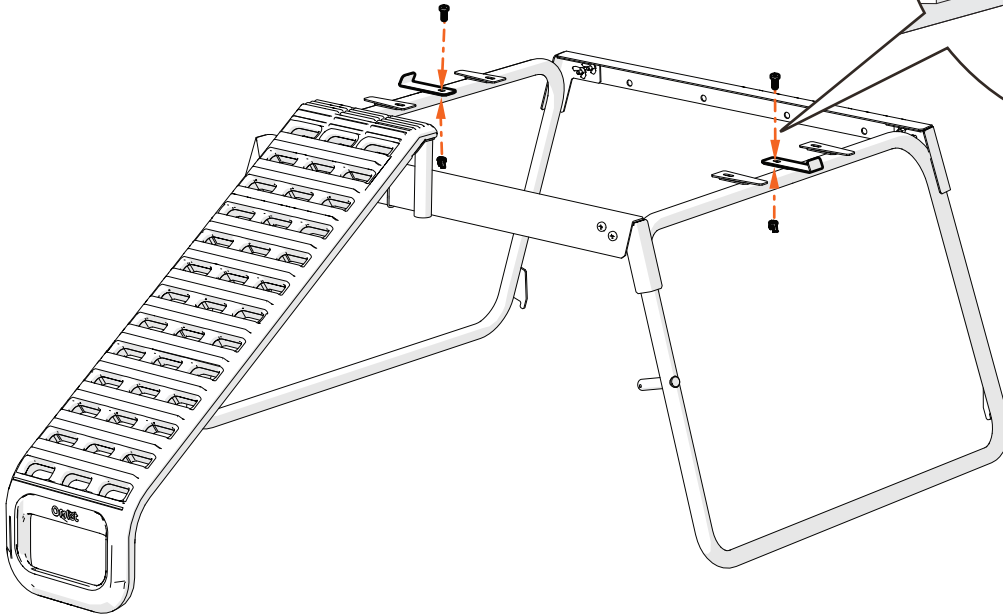
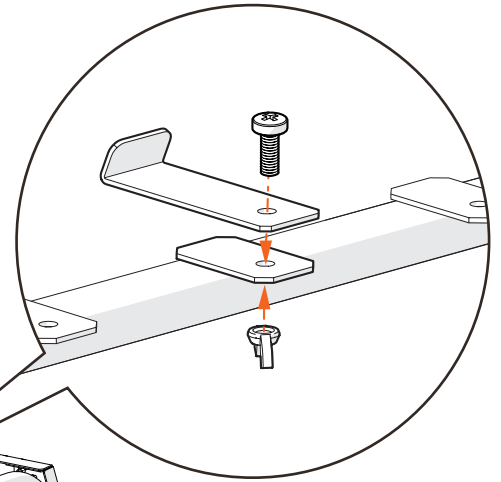
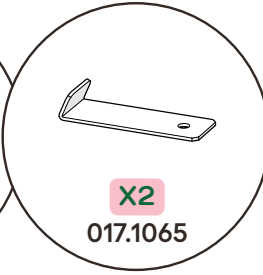
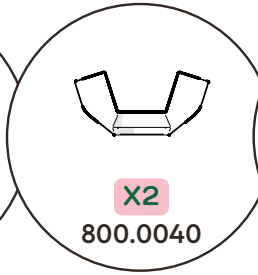
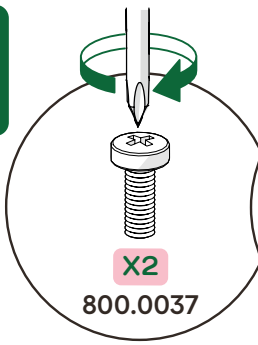

If you have Eglu Go Up Wheels please refer to these instructions now and then return here to attach your Eglu Go Coop to the Eglu Go Up Frame



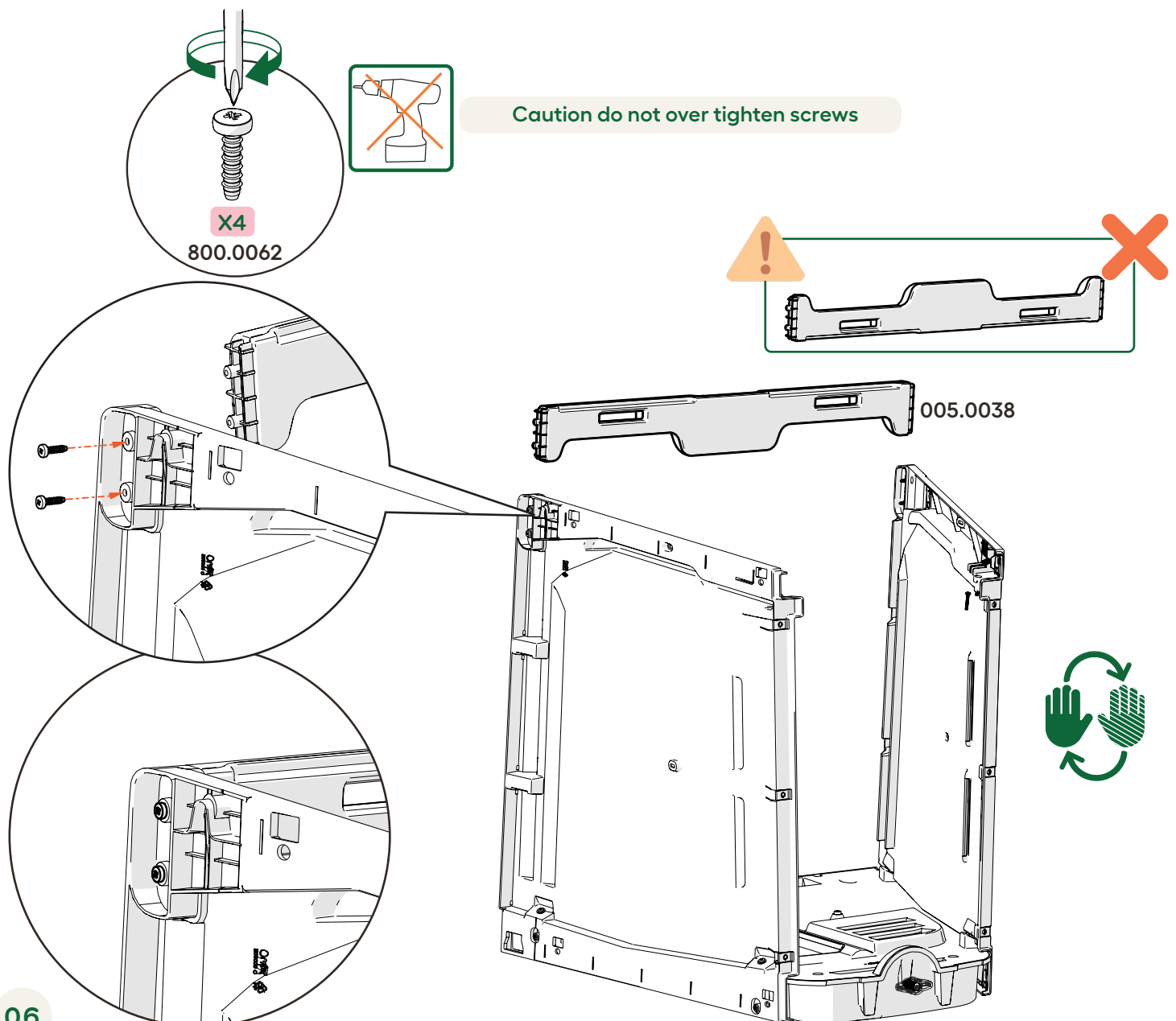
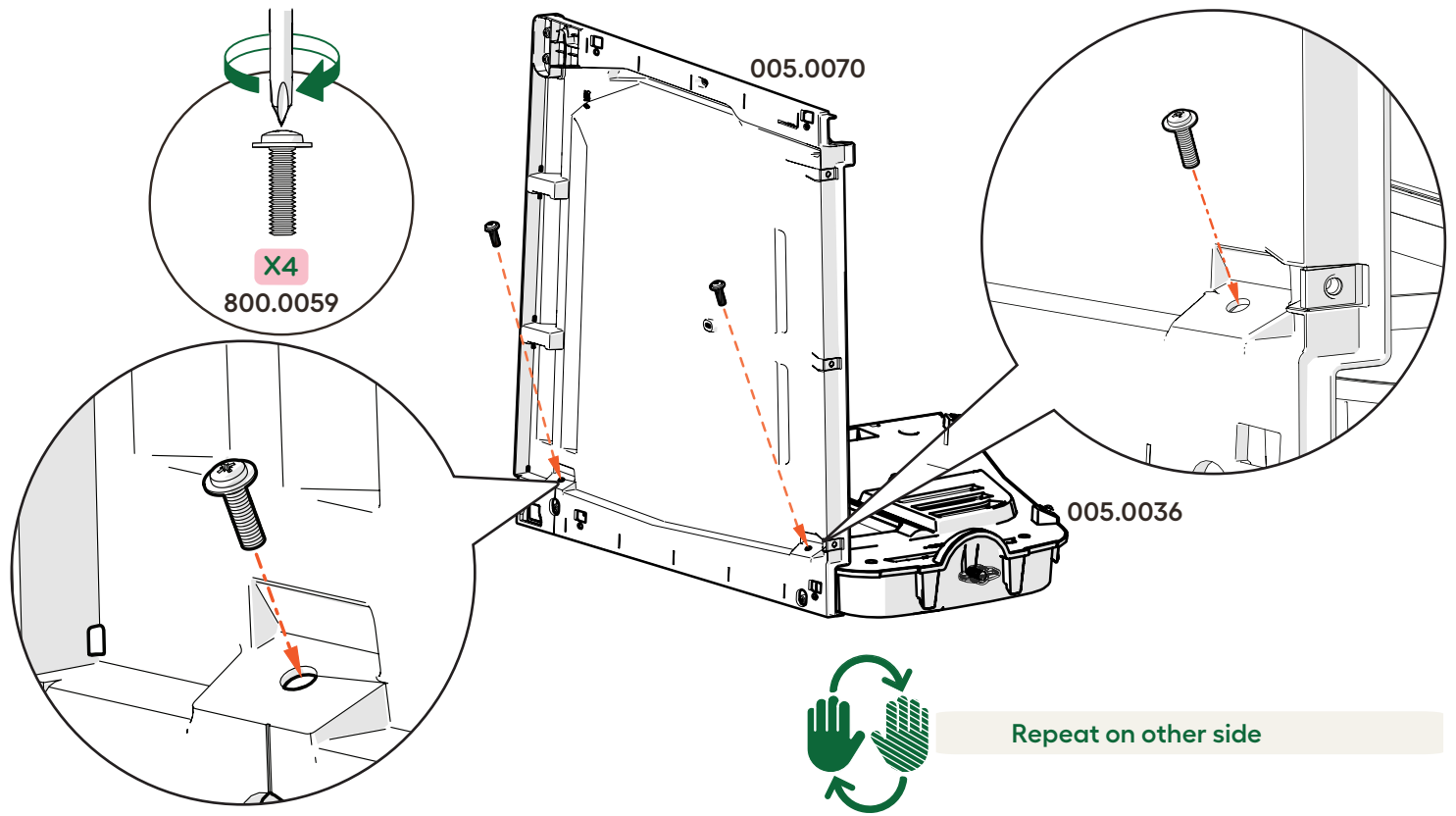

3

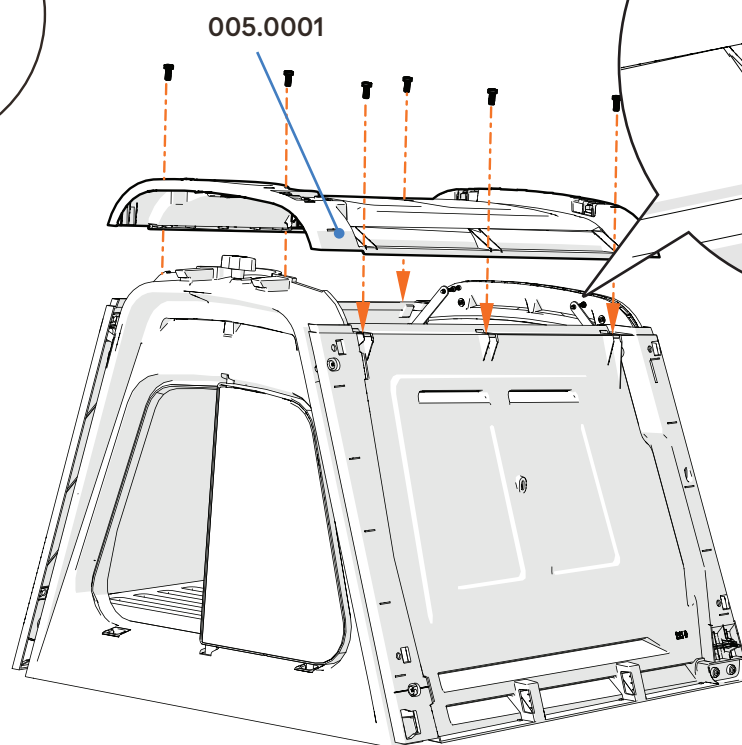
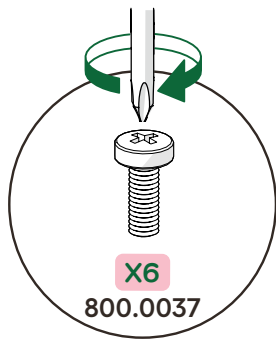

4

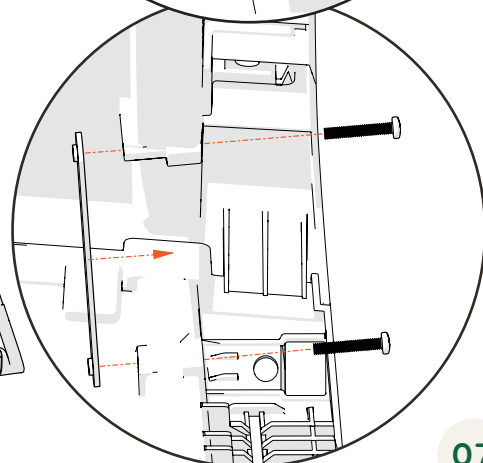
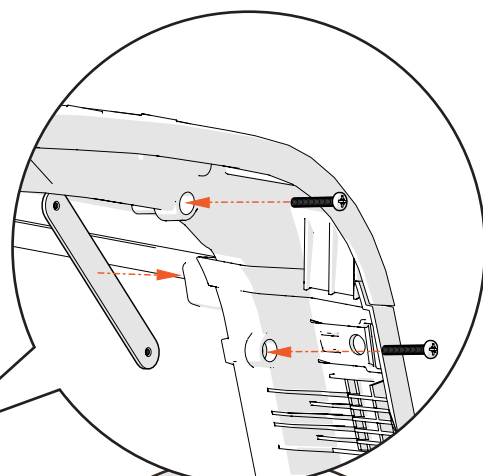
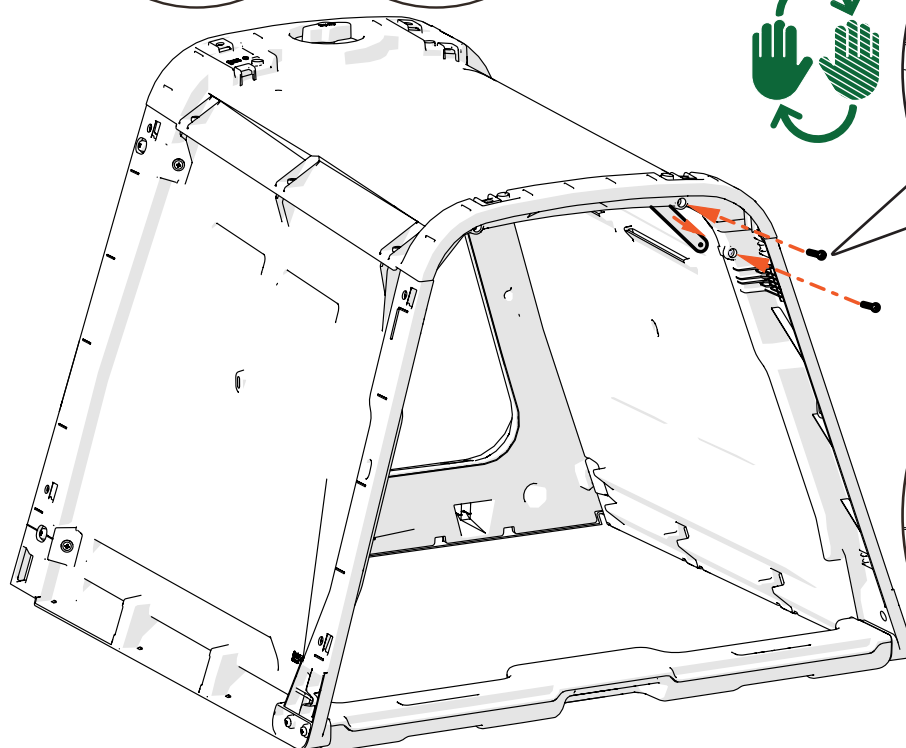
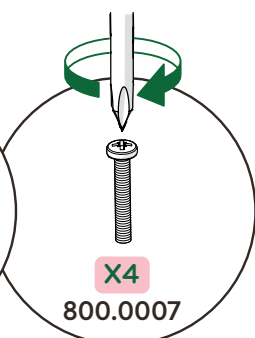
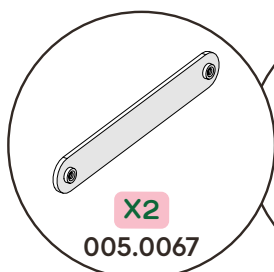

5

Attaching your Eglu Go Coop to the Eglu Go Up Frame - If you came to this manual from the Eglu Go Coop manual go to step 9

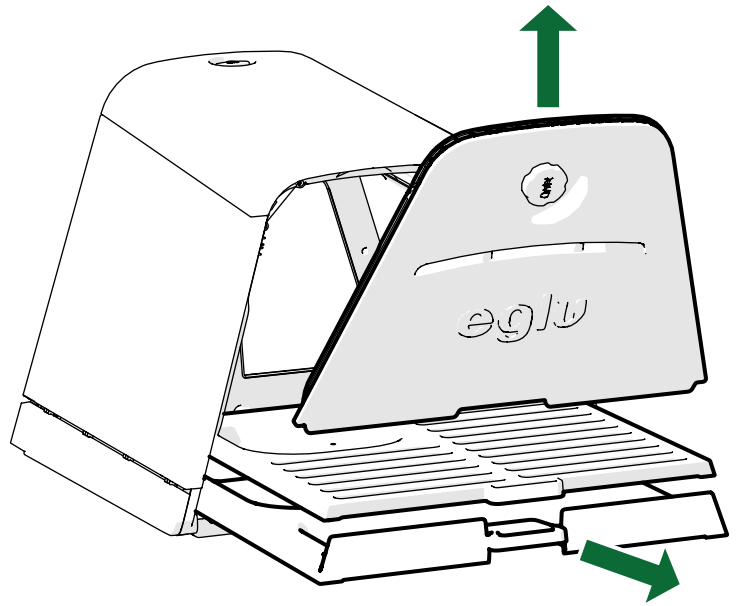

6

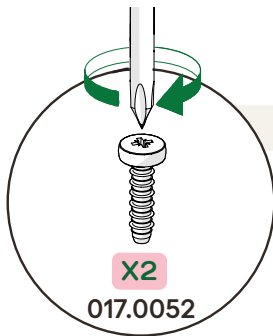

Keep Safe until step 15

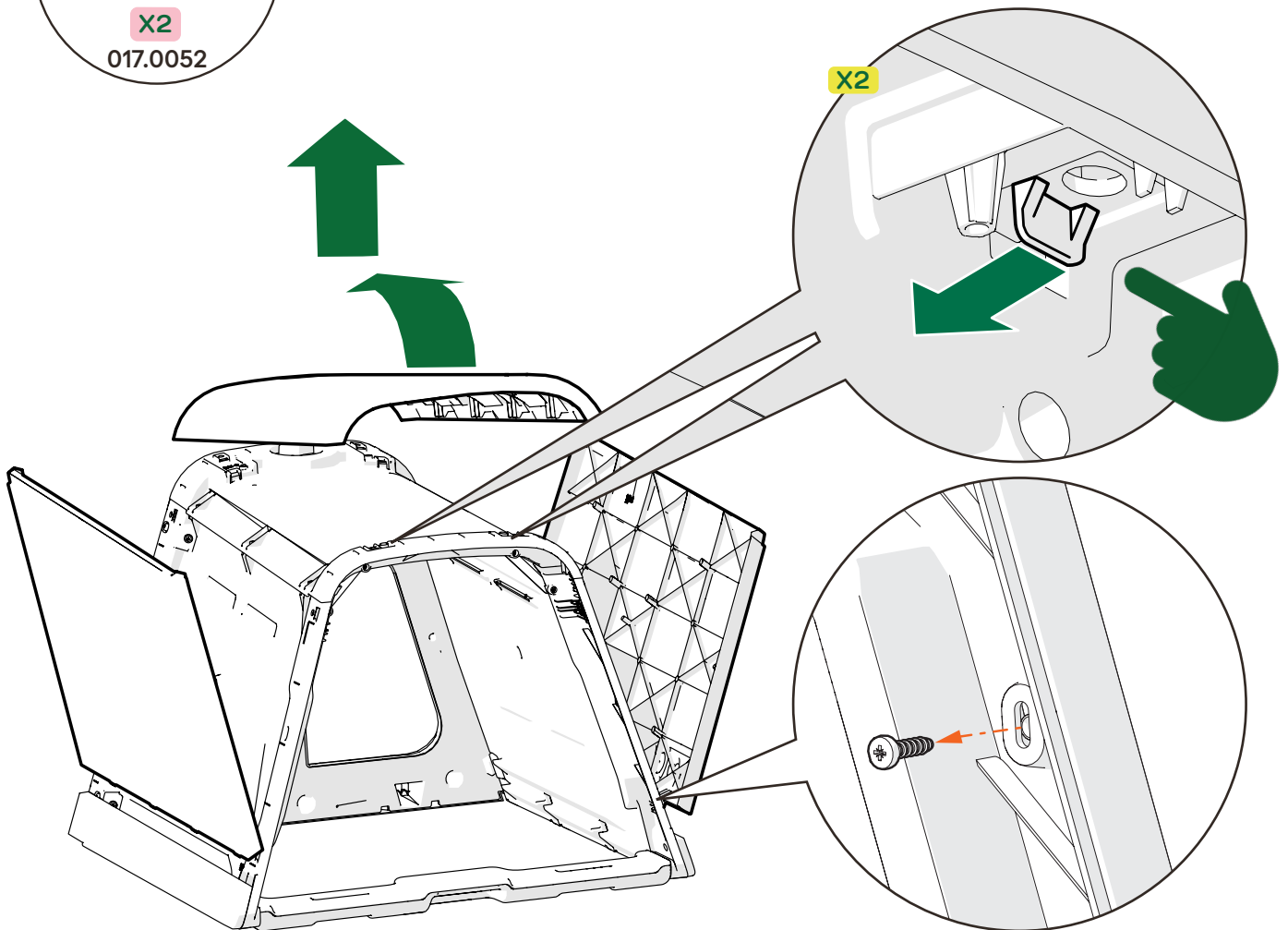

7

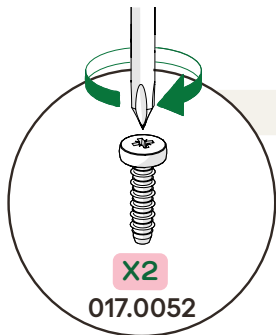

Keep Safe until step 13

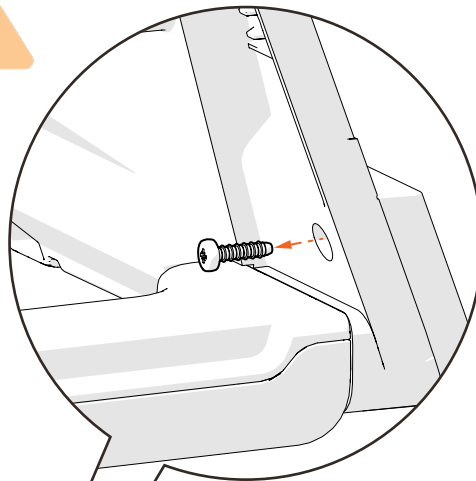

Repeat on other side

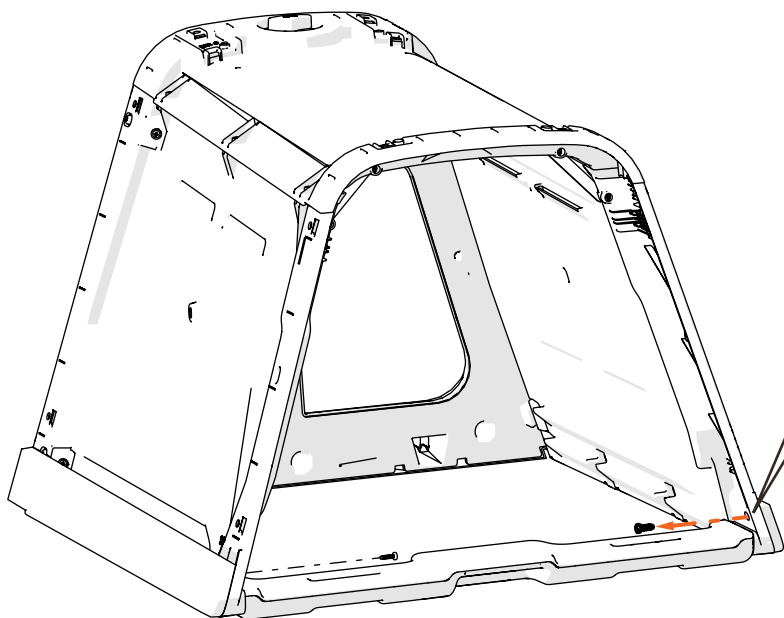

8

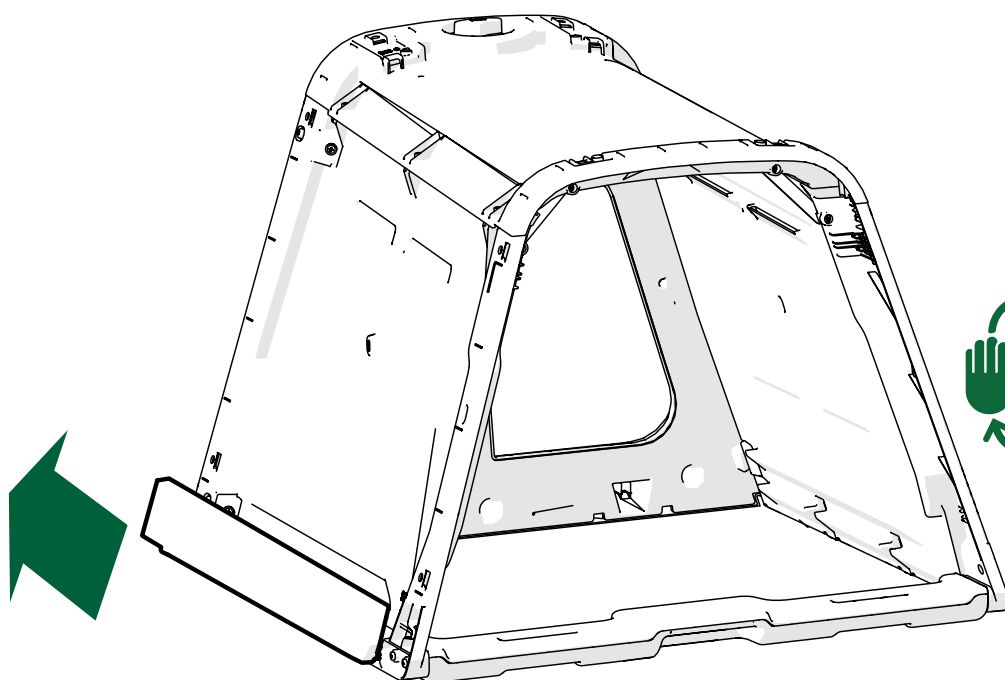

9

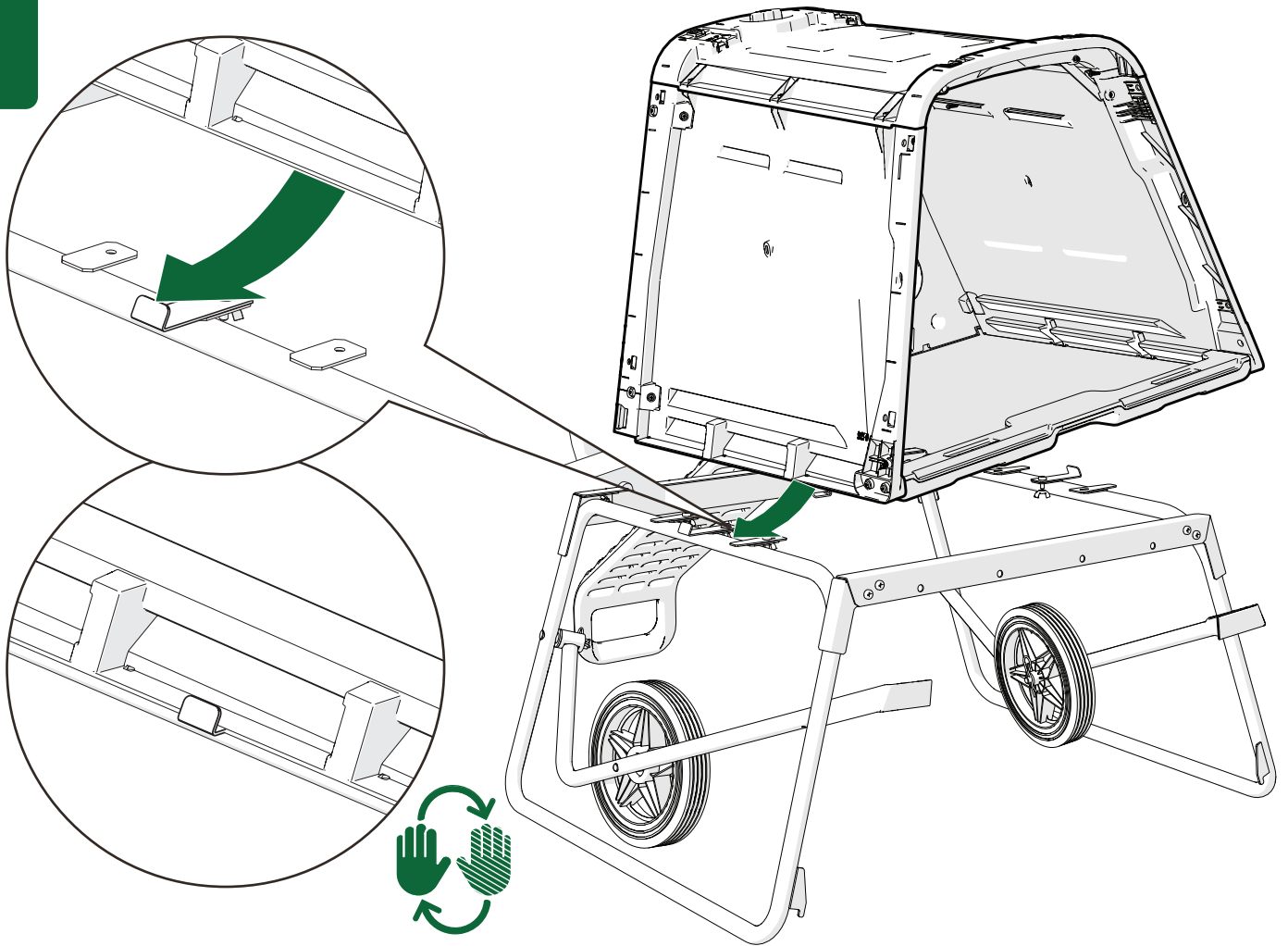

10

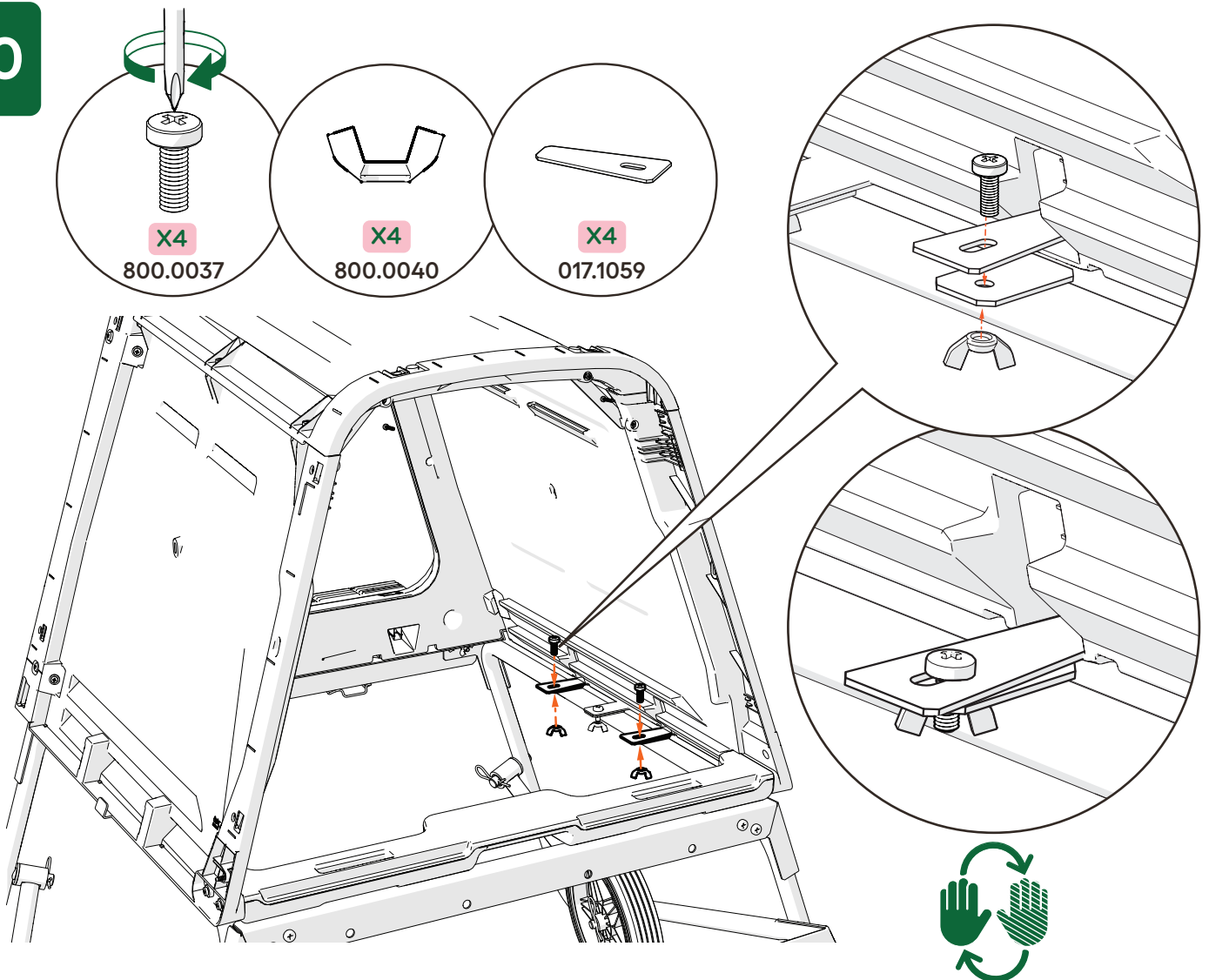

10

005.0039



x2
017.0052



13

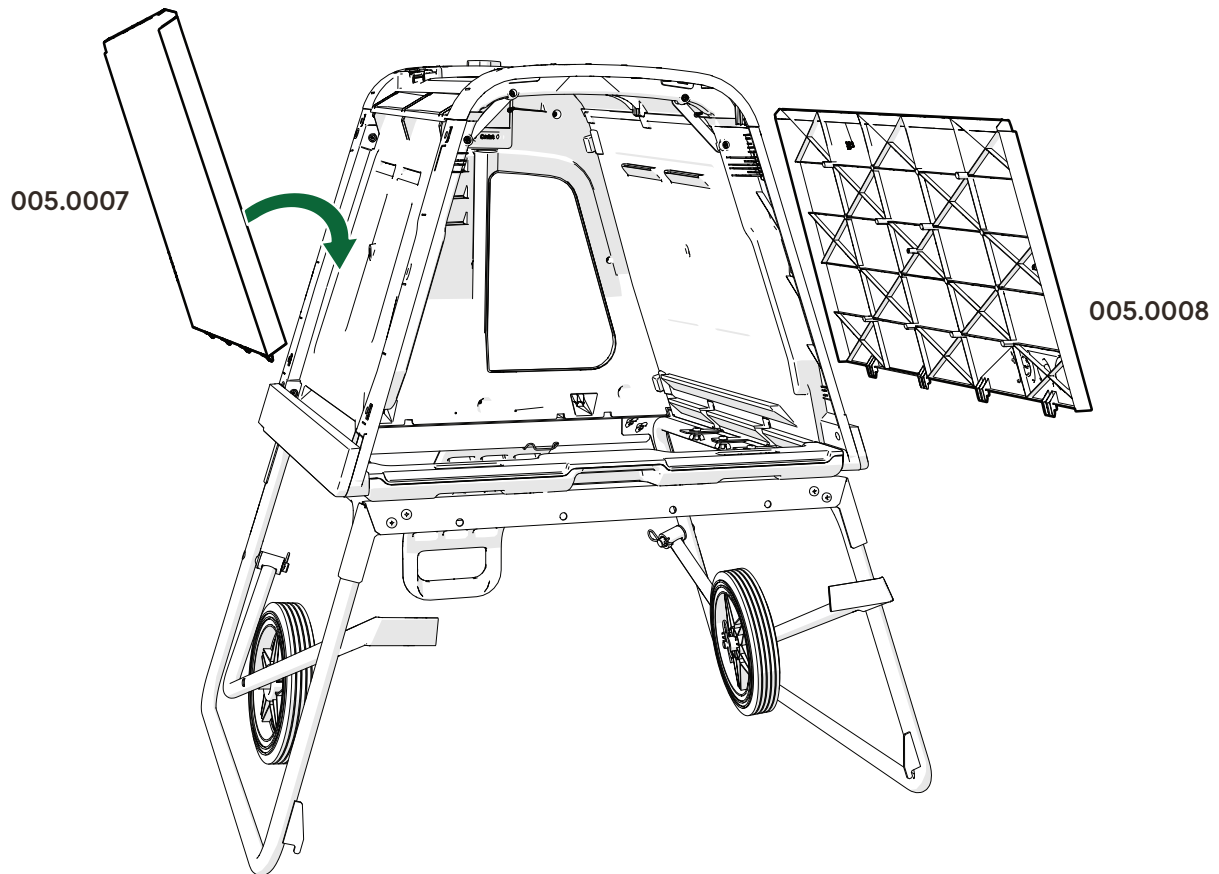

14

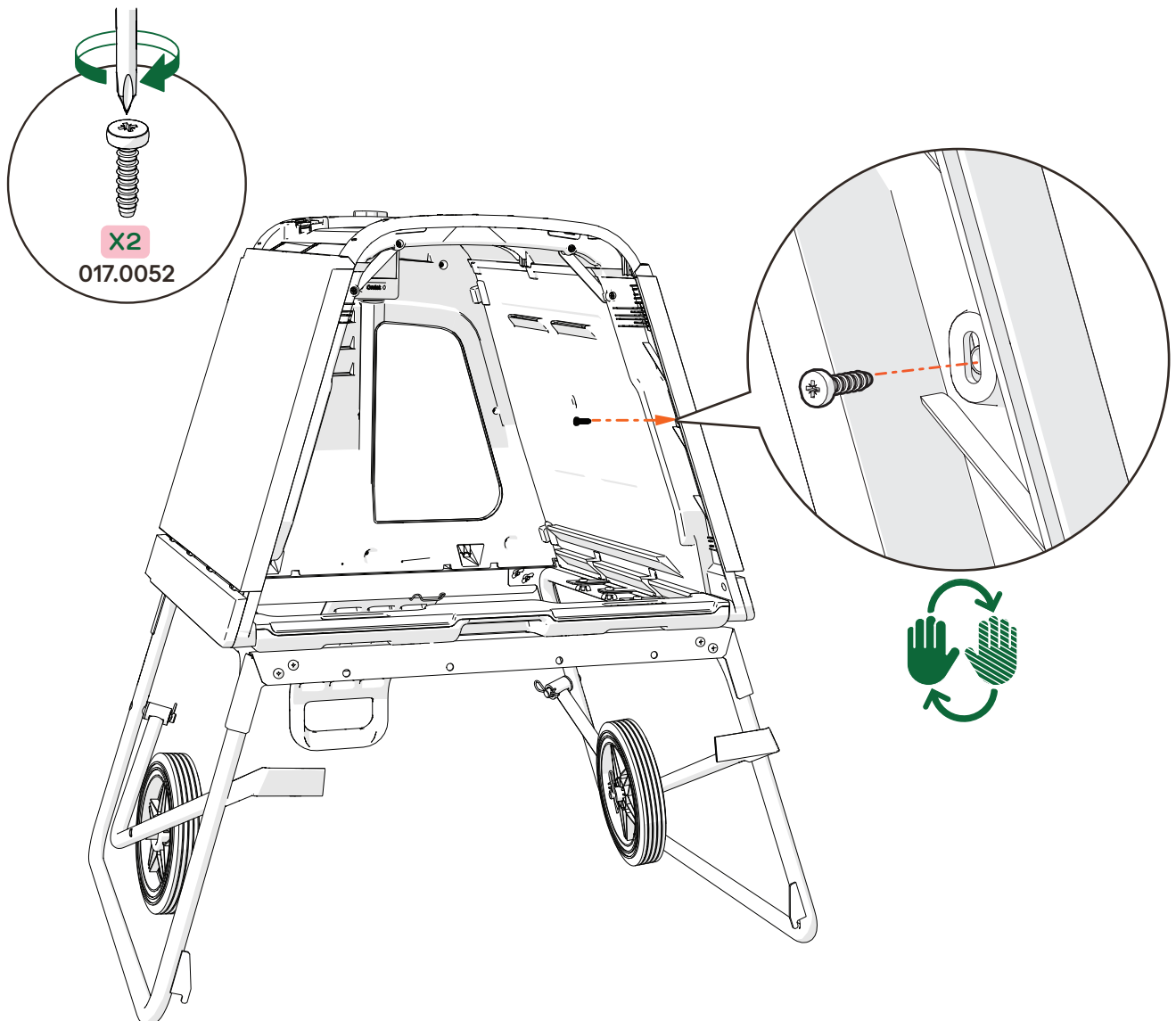

12

15

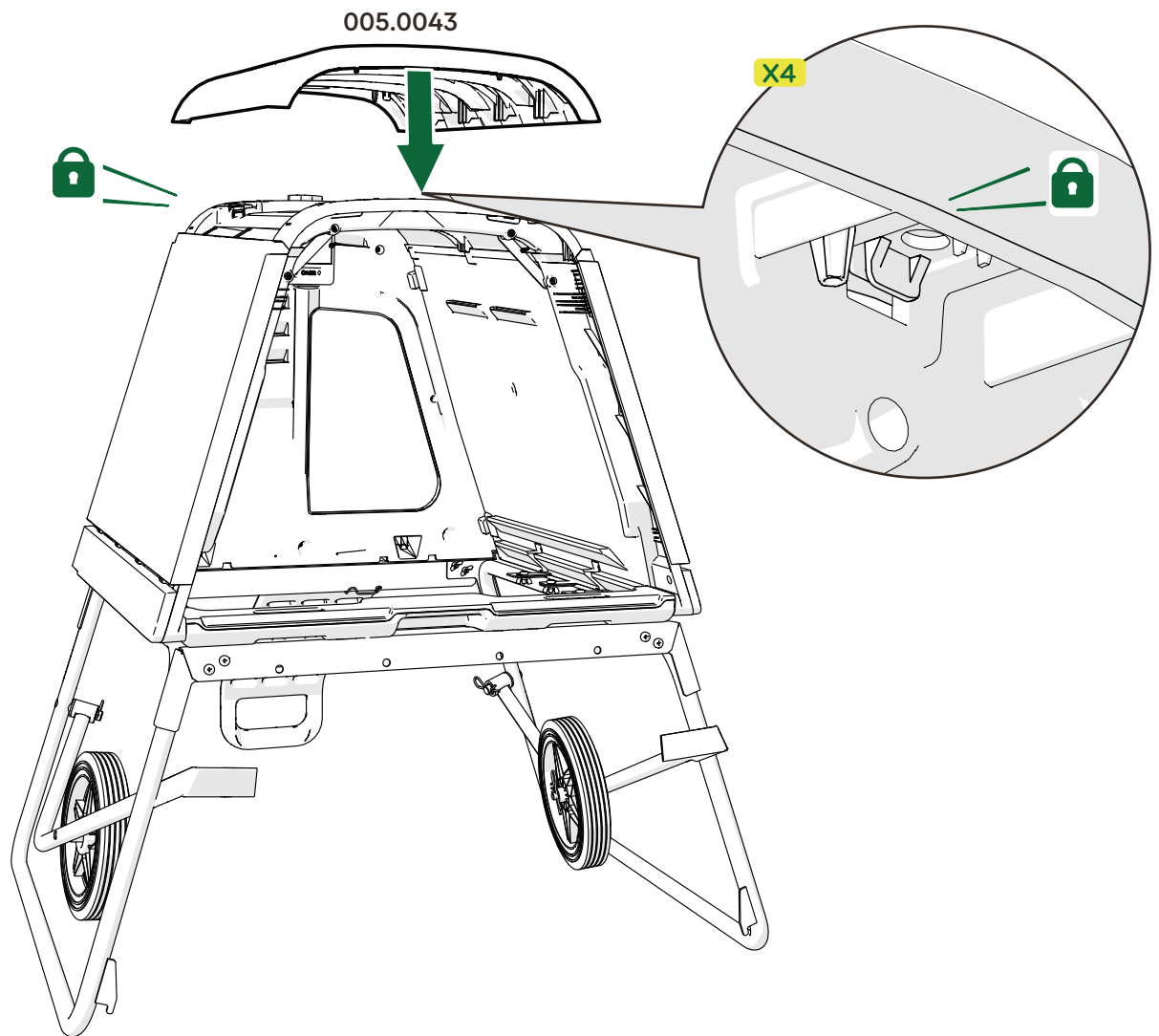

16

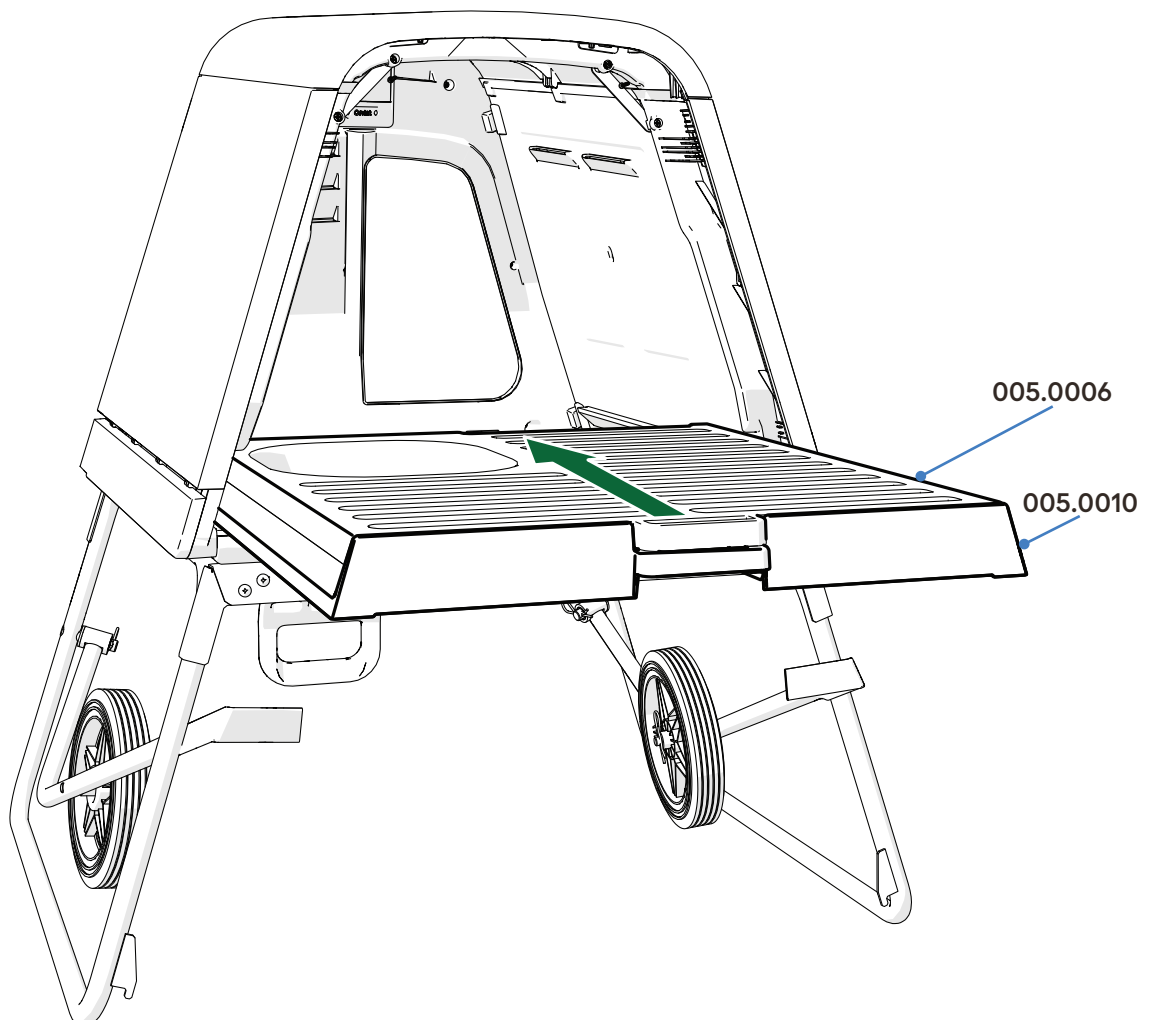

17

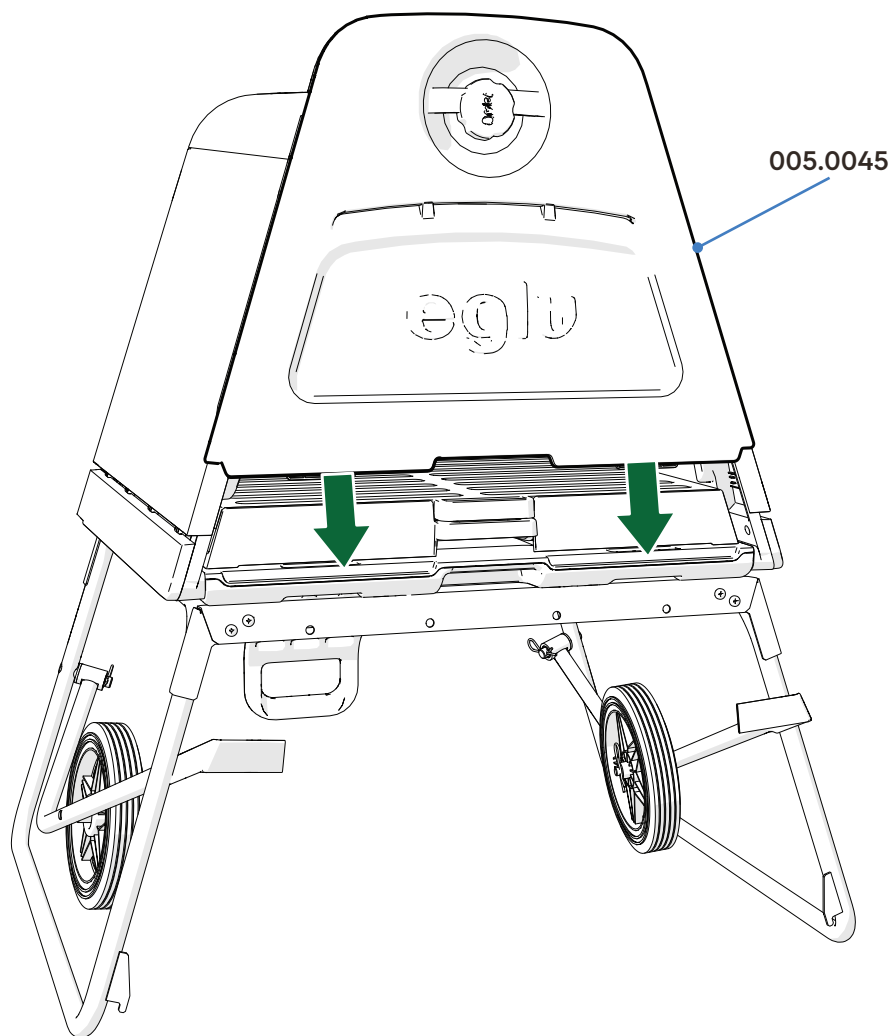

18

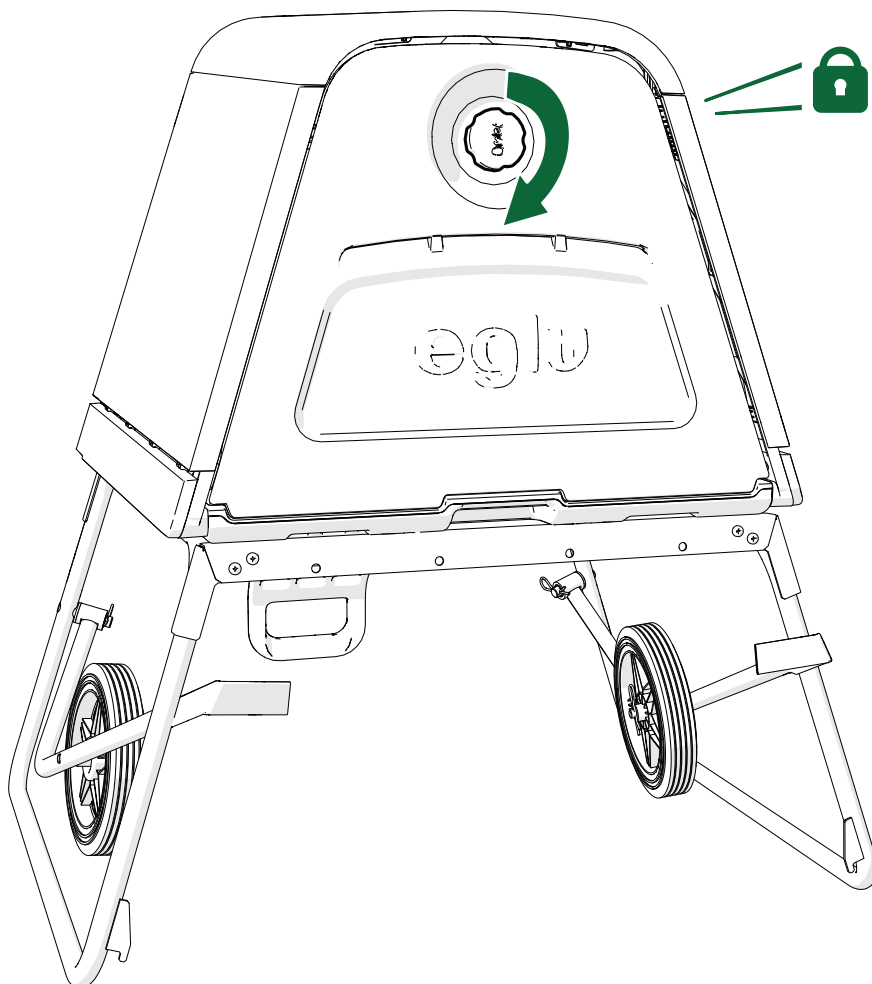

WE ASK. WE INVENT.



Omlet



Please
reuse &
recycle.

© Copyright Omlet Ltd. 2025
Design registered, patent pending
Omlet and Eglu are registered trademarks of Hebe Studios Ltd.
820.2180_Instruction Manual Eglu Go Up Frame 23/04/2025

