

Cleaning the Autodoor

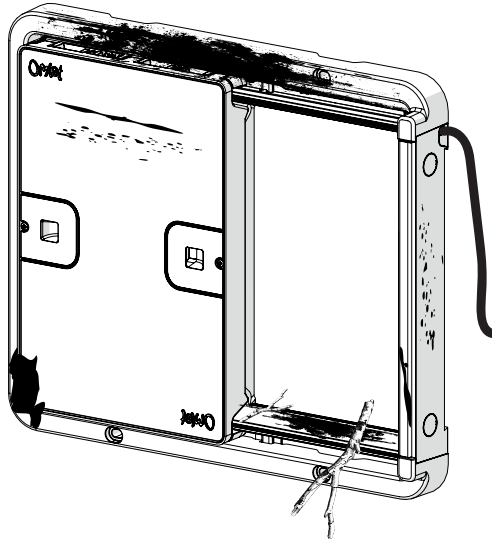

Please avoid cleaning your Autodoor with industrial chemicals or a jet wash. We recommend cleaning only with soap and water or a pet safe disinfectant and treating red mite with powder only. For more detailed instructions, please visit www.omlet.co.uksupport/



1

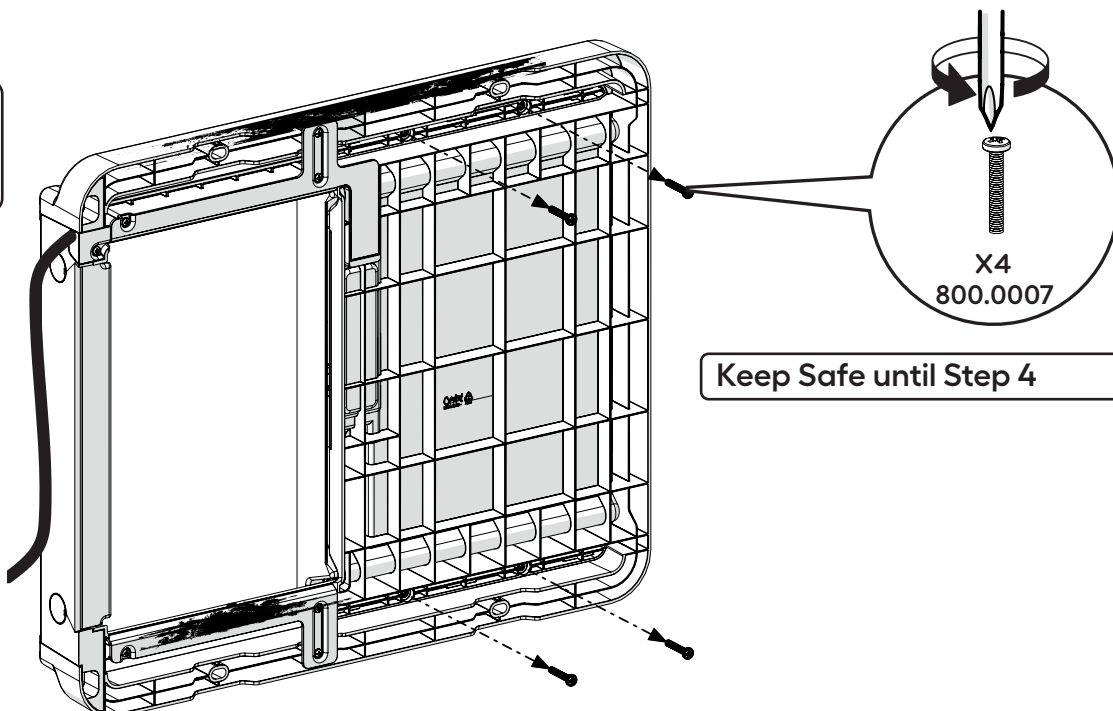

Keep Safe until Step 4



2

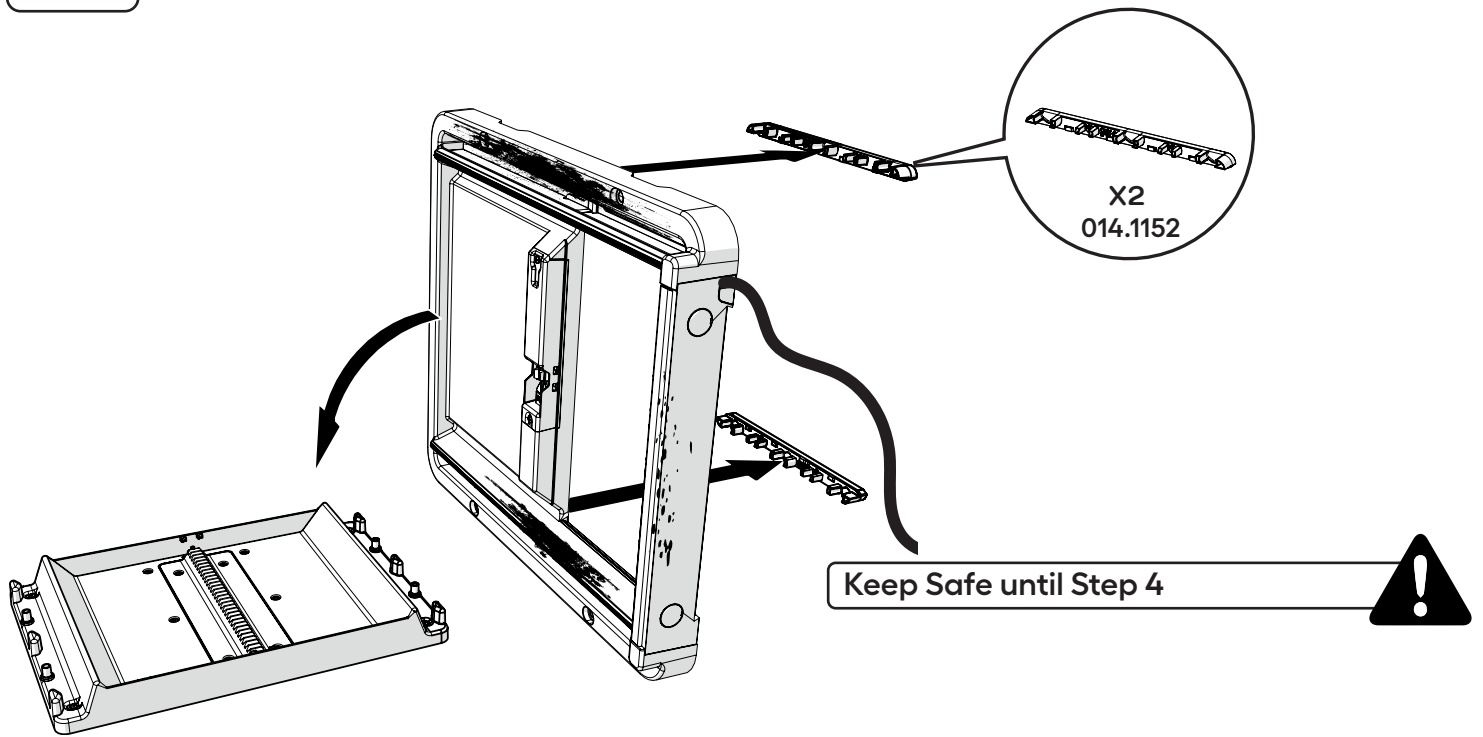

3

Avoid getting water into the Gear Module

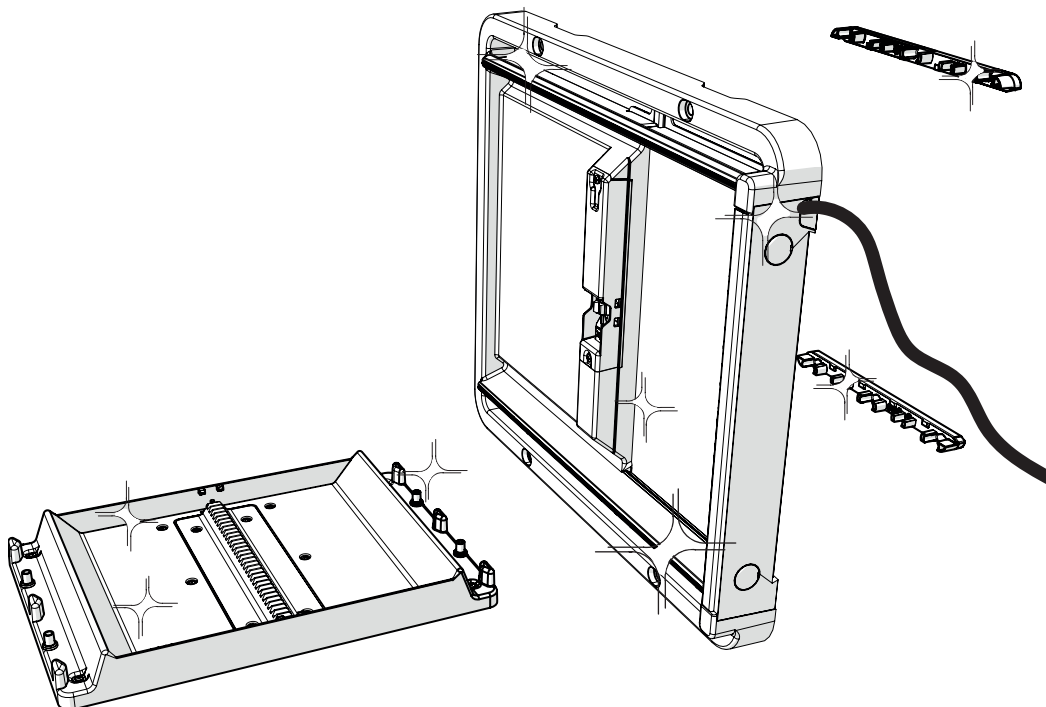

4

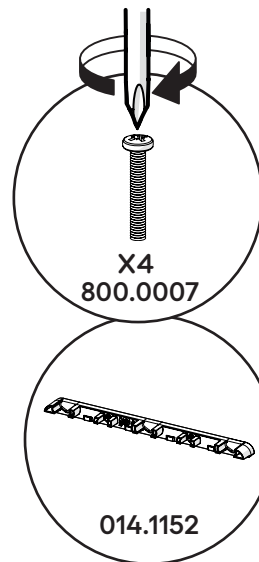
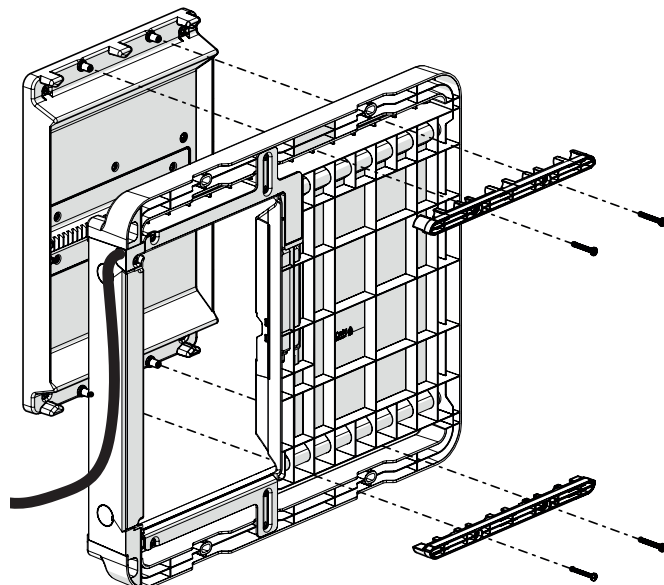

5

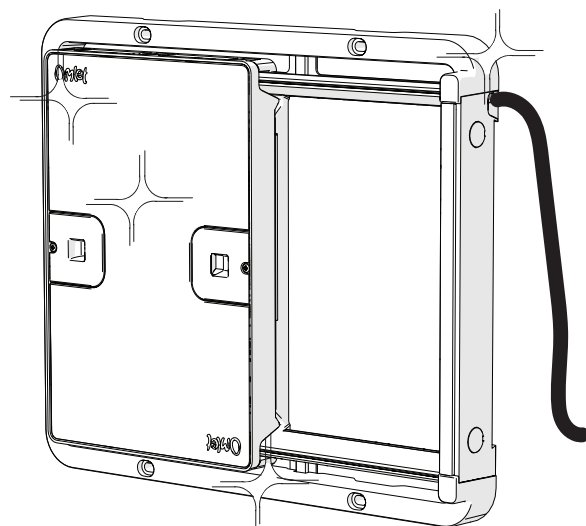

After rain in freezing temperatures, sleet or snow you may need to defrost your Autodoor to restore proper function to moving parts. To do this we recommend pouring warm (not boiling) water over any affected parts and then drying them.



Additional steps for Deep Cleaning

6

Frame

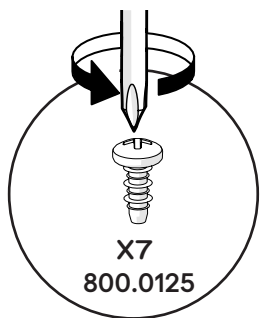

Keep the Parts safe until Step 8

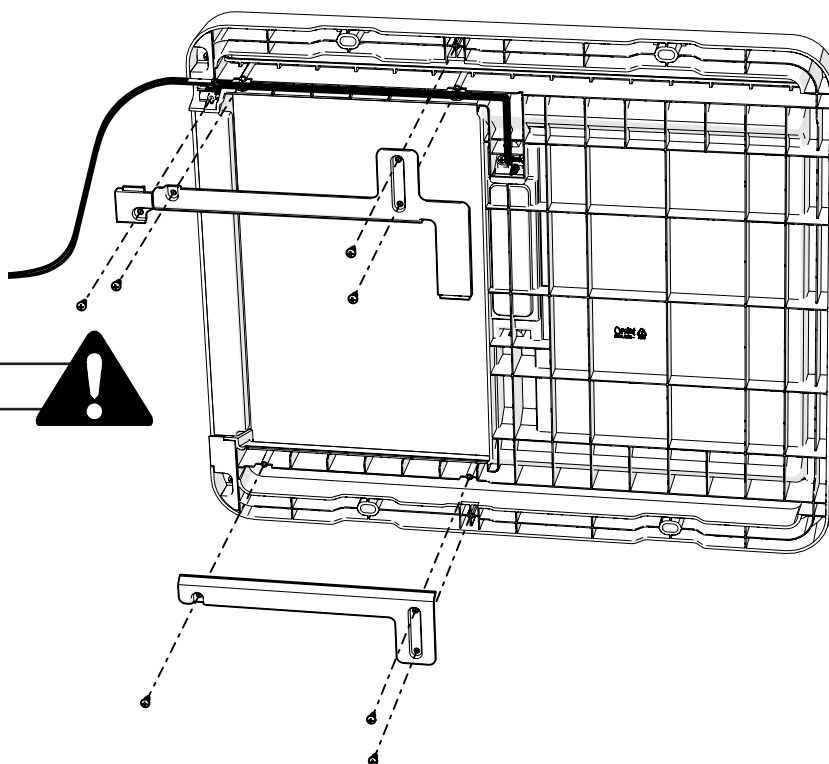

7

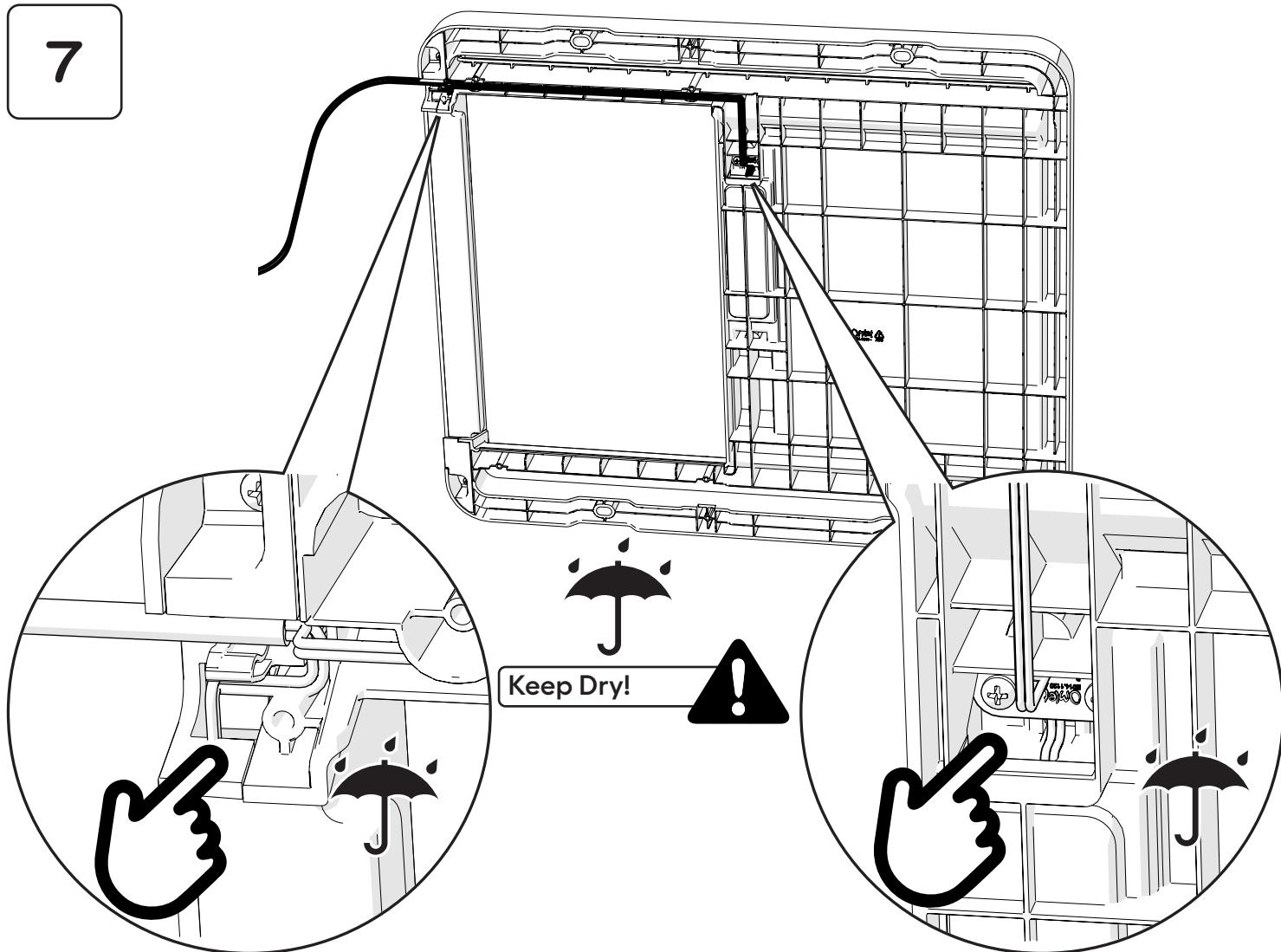

8

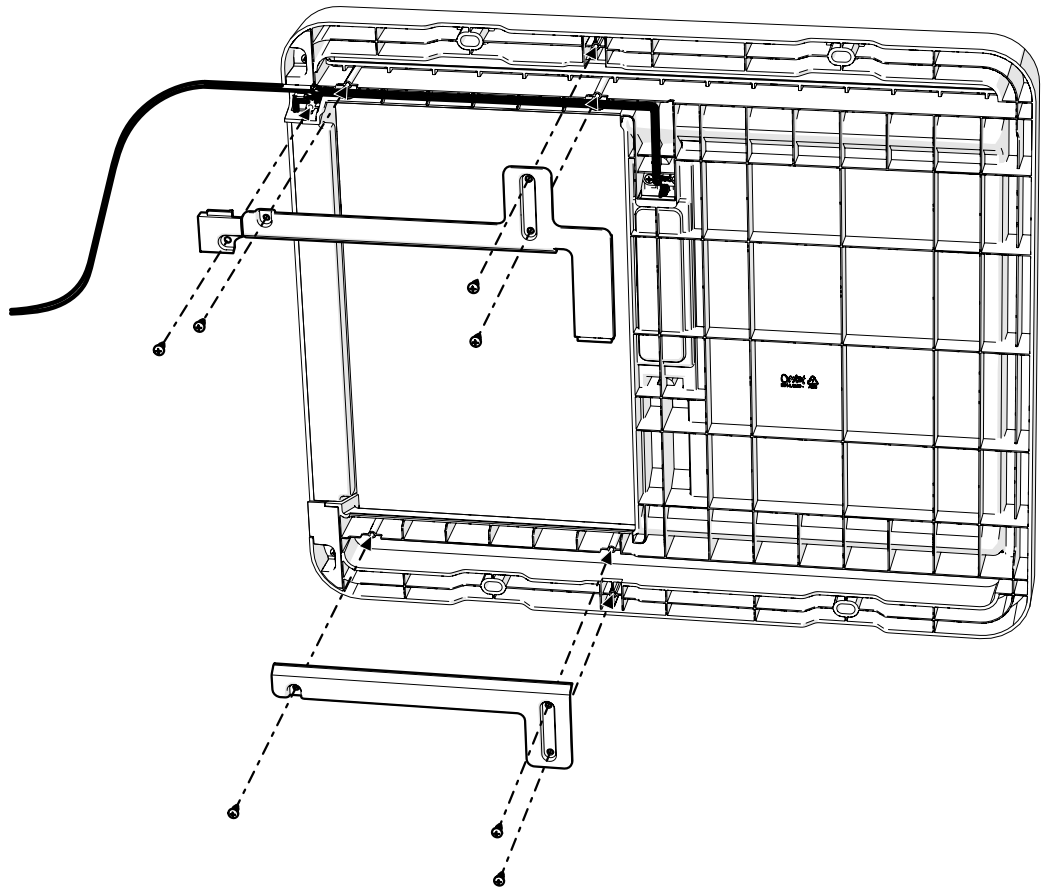
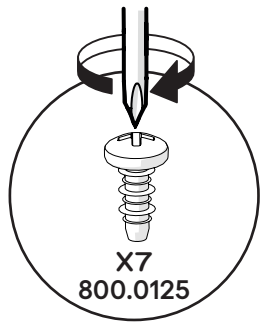

9

Safety Sensor

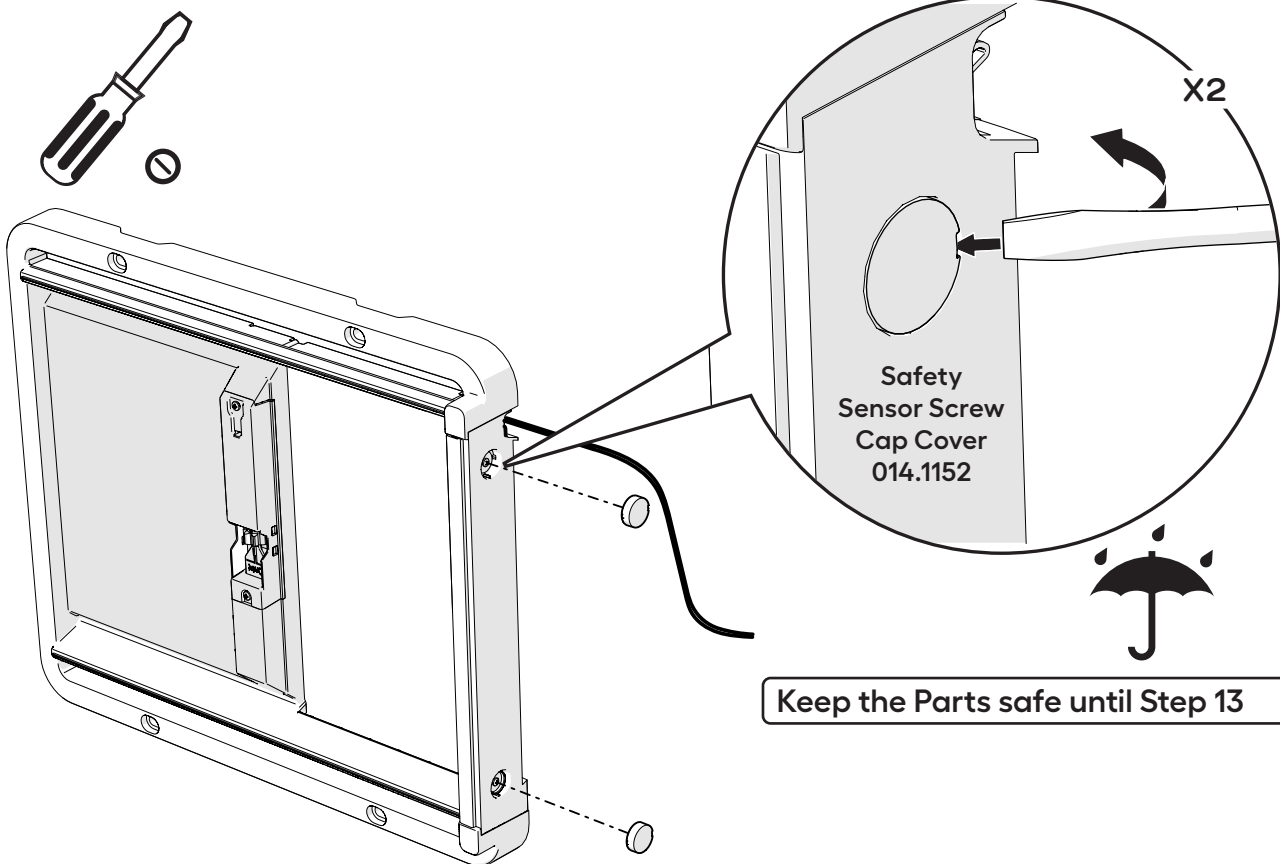

Keep the Parts safe until Step 13



10

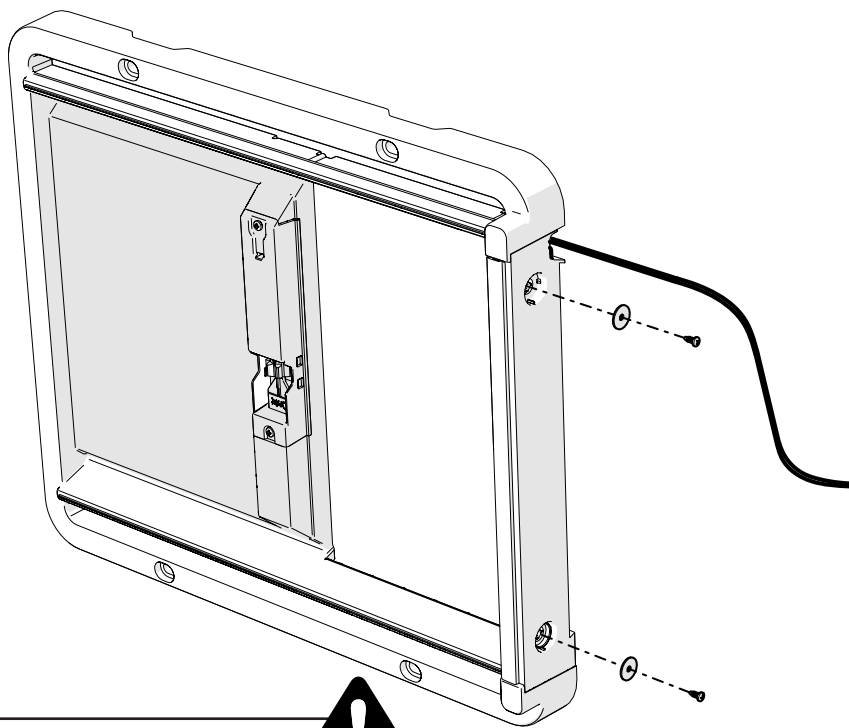
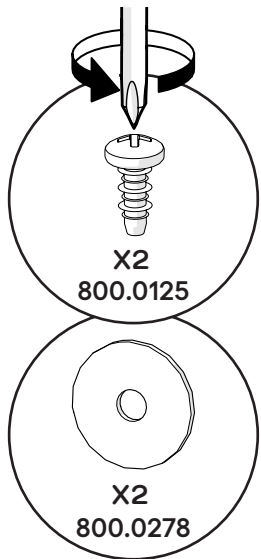

Keep the Parts safe until Step 13



11

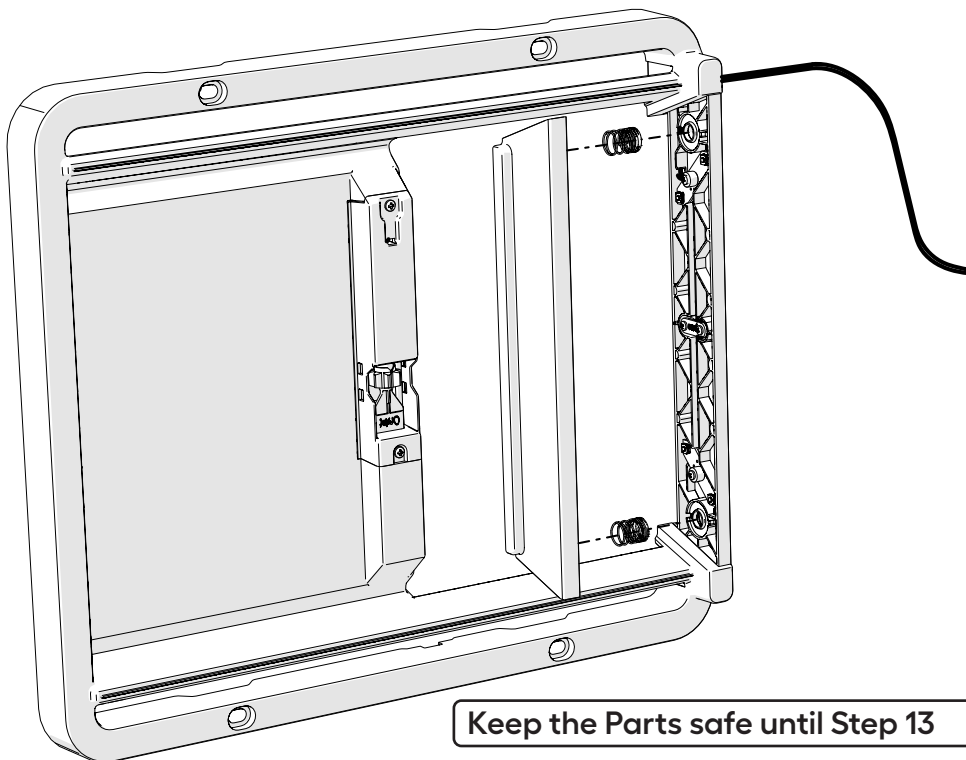
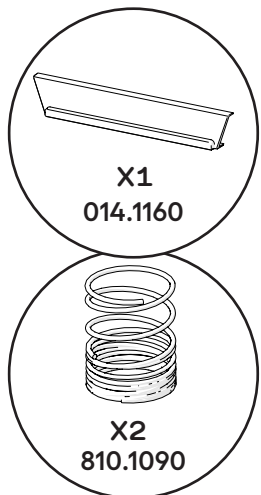

Keep the Parts safe until Step 13



12

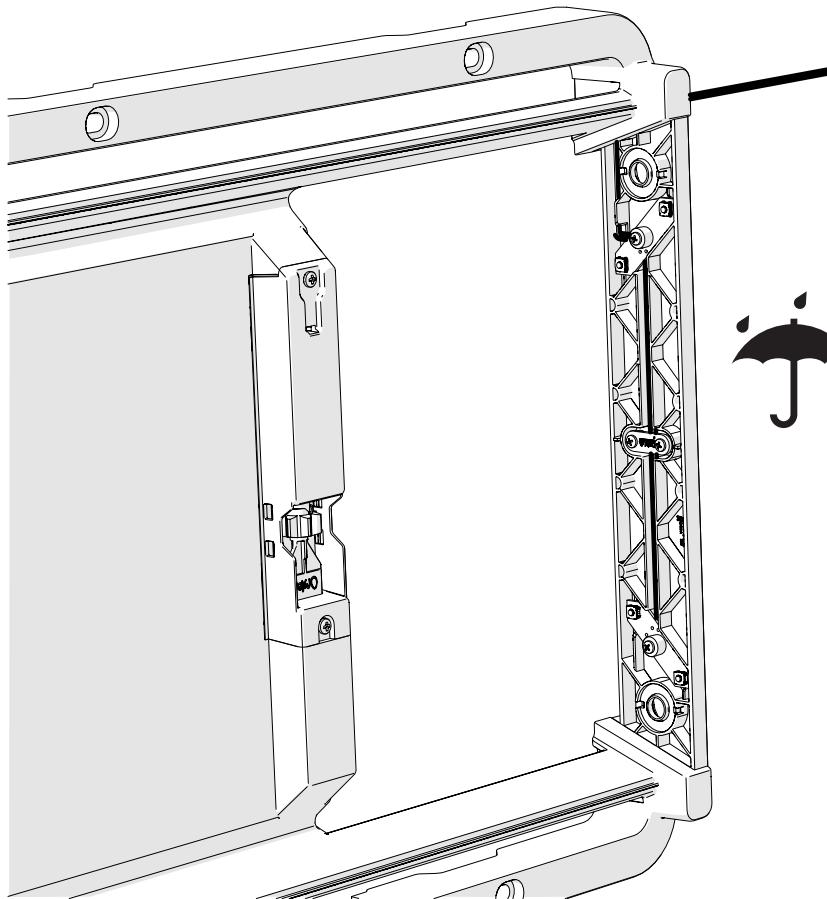

13

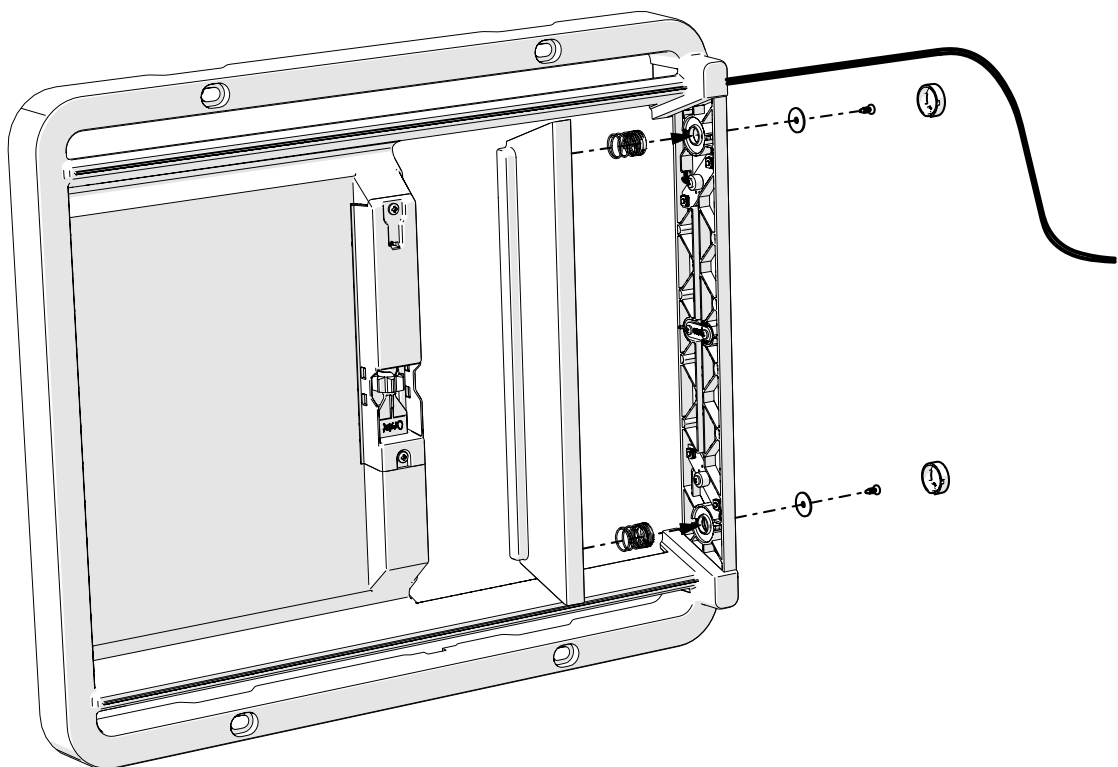
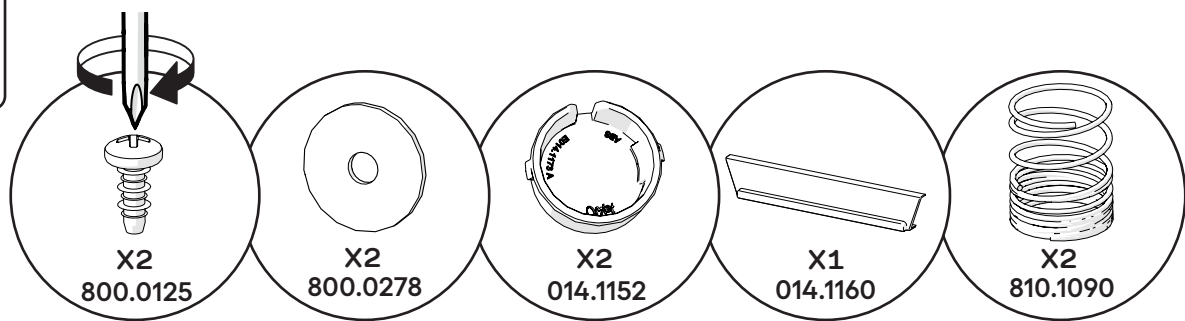

14

Motor Case

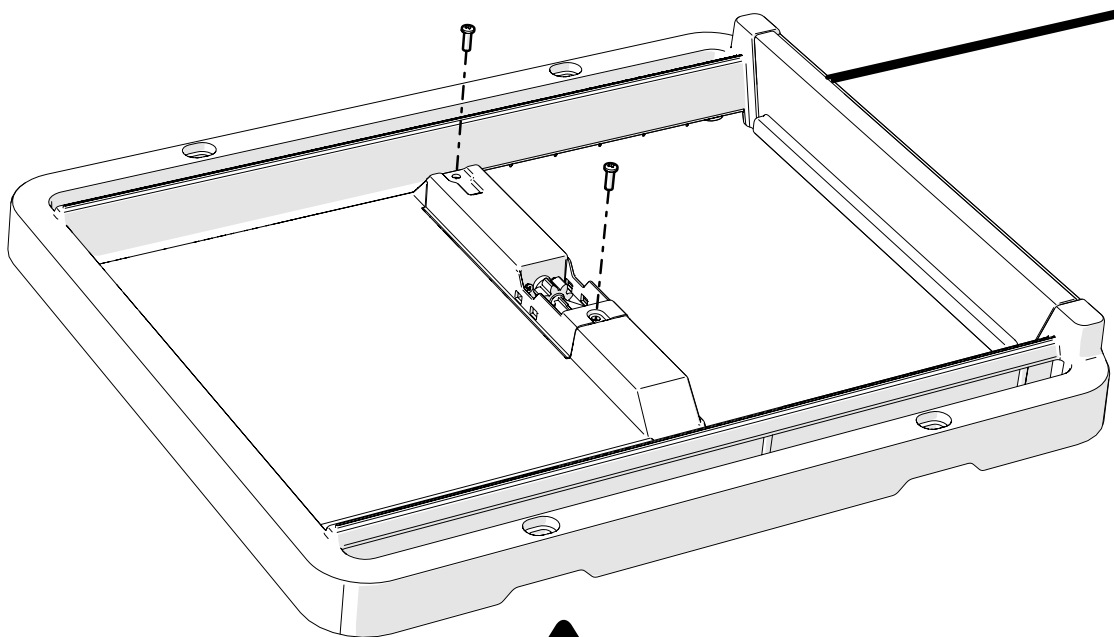
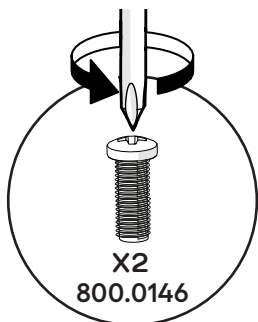

Keep the Parts safe until Step 16



15

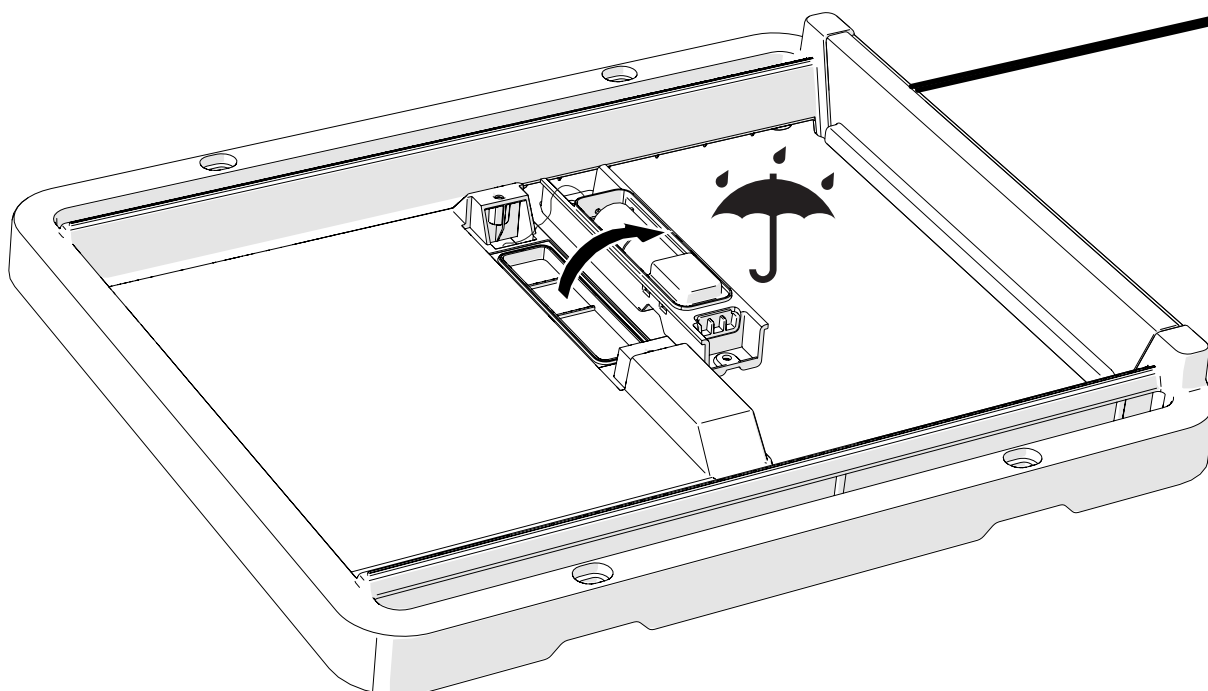

16

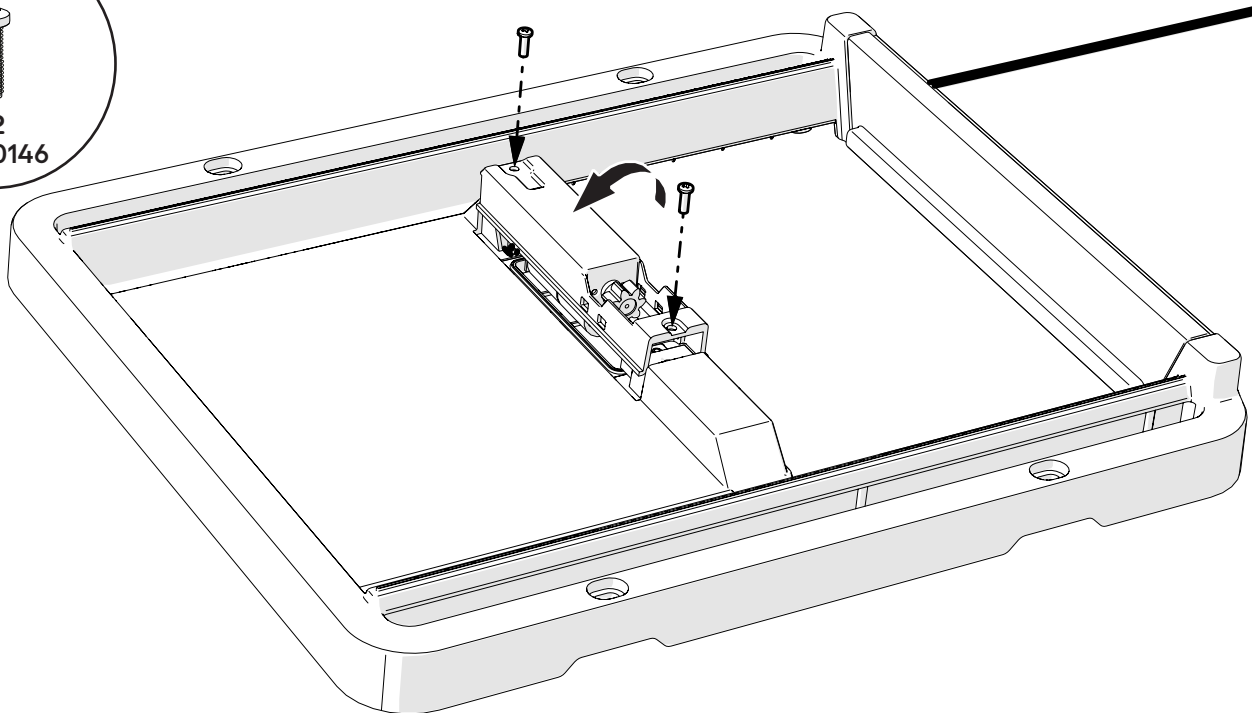
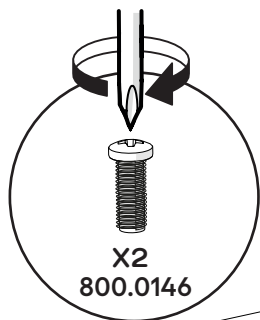

17

Door

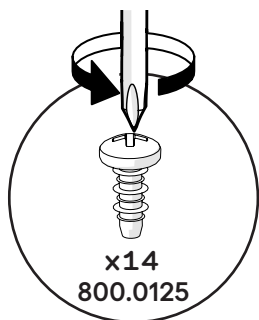

Keep the Parts safe until Step 23

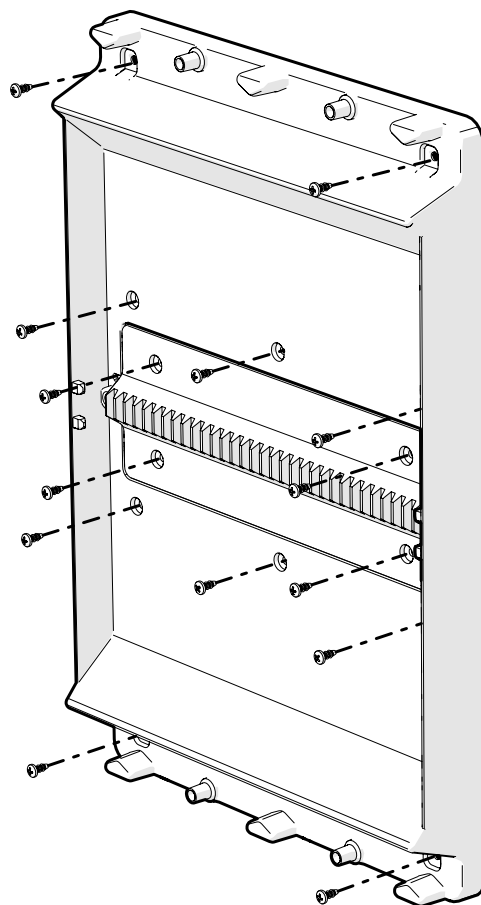

18

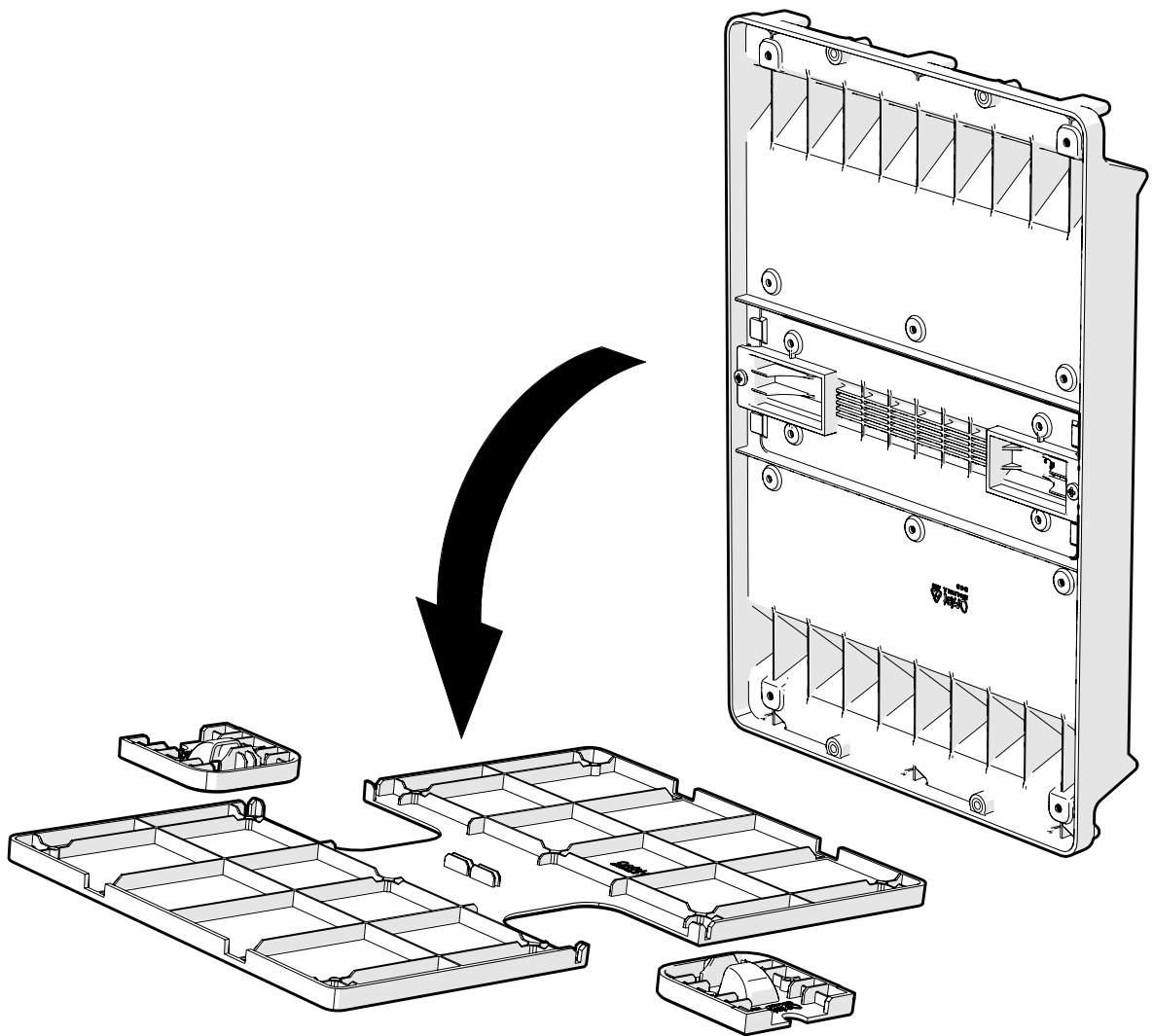

19

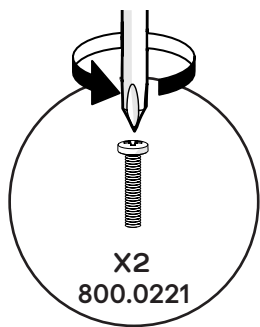

Keep the Parts safe until Step 21

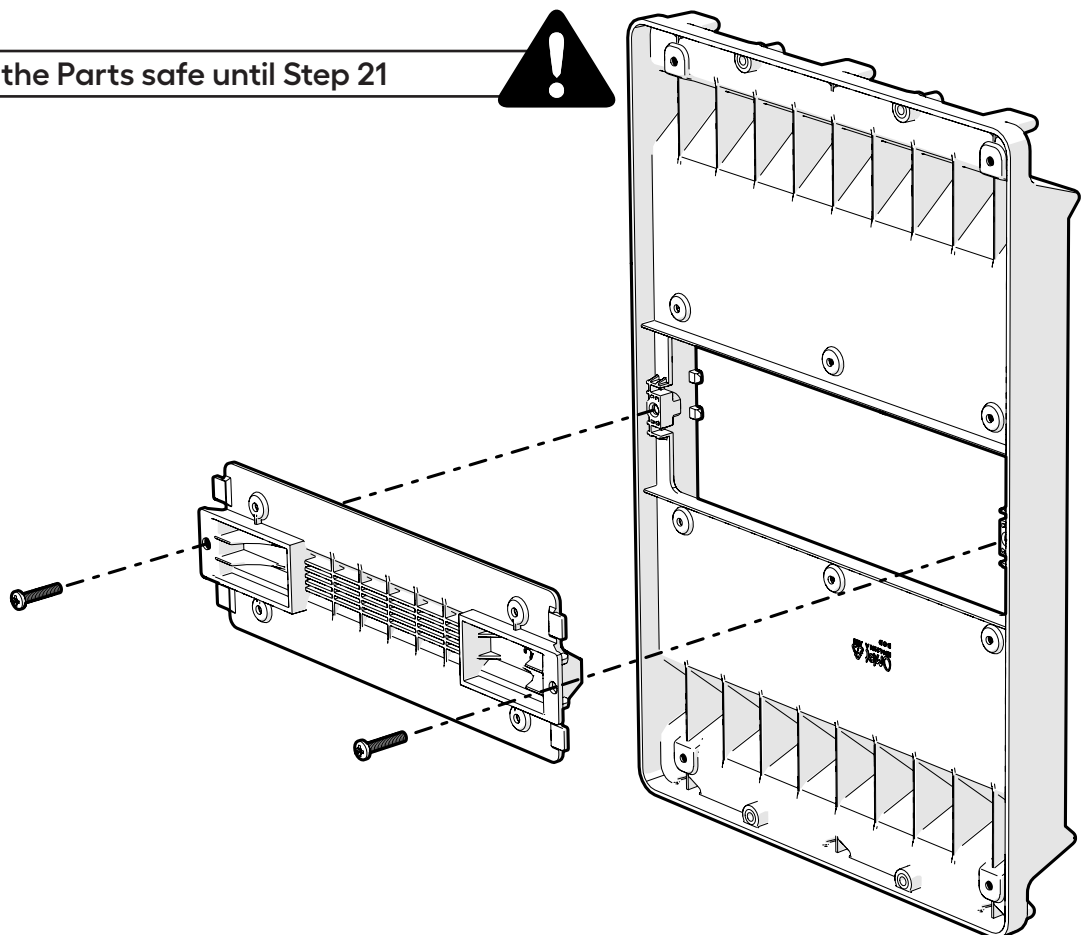

20

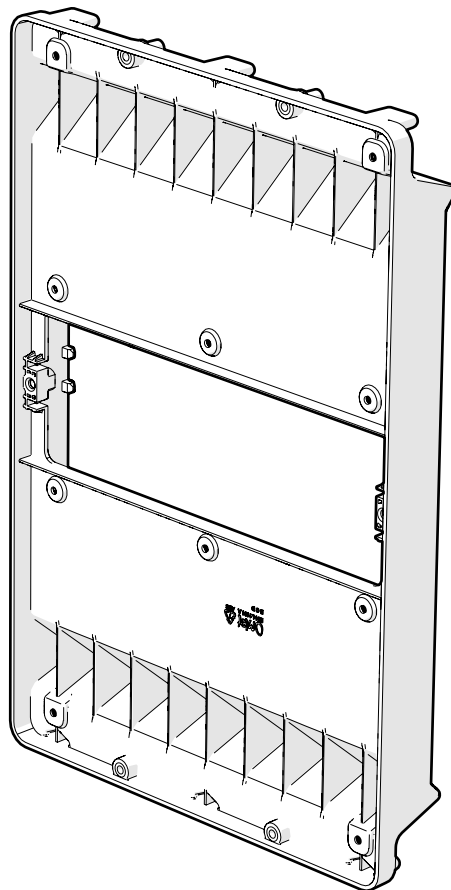
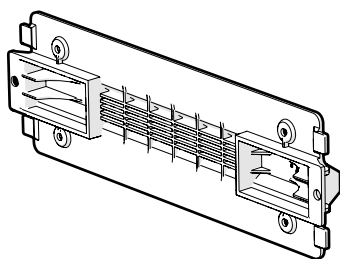

21

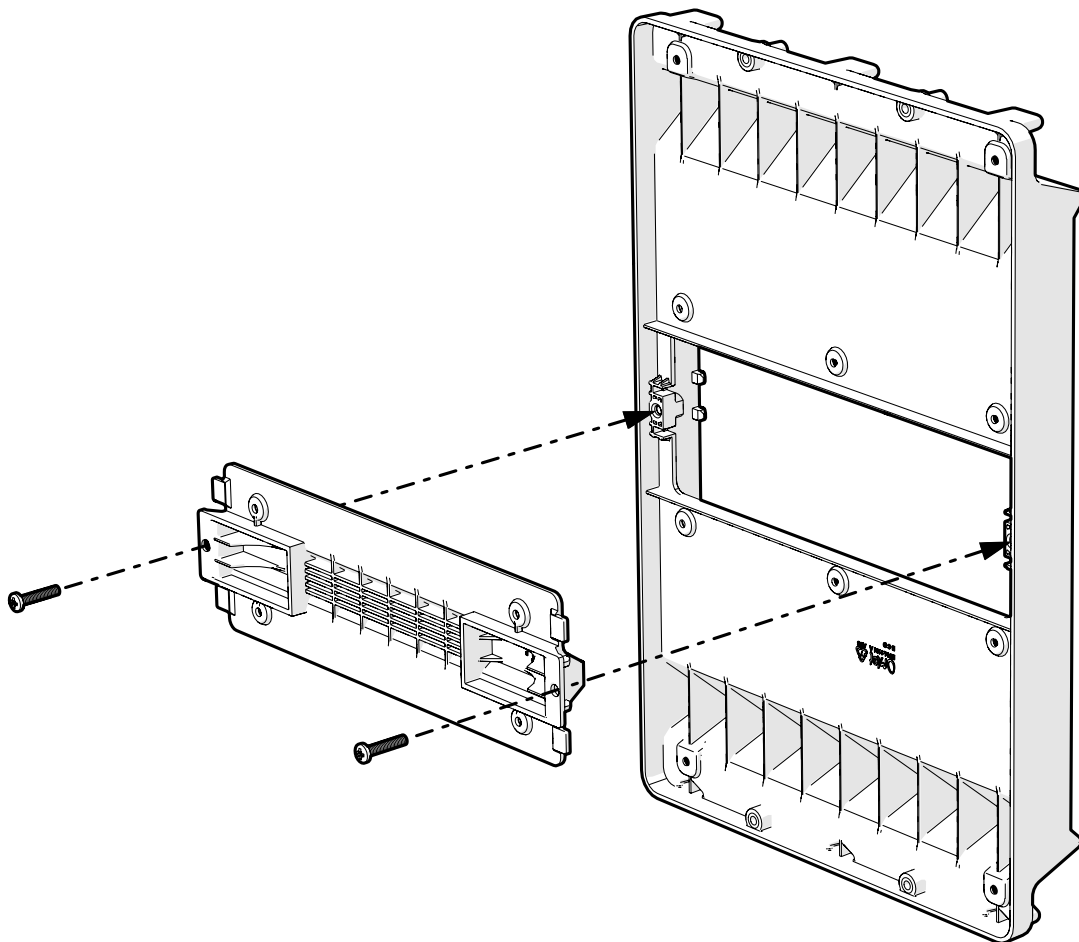
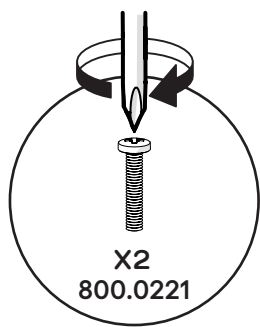

22

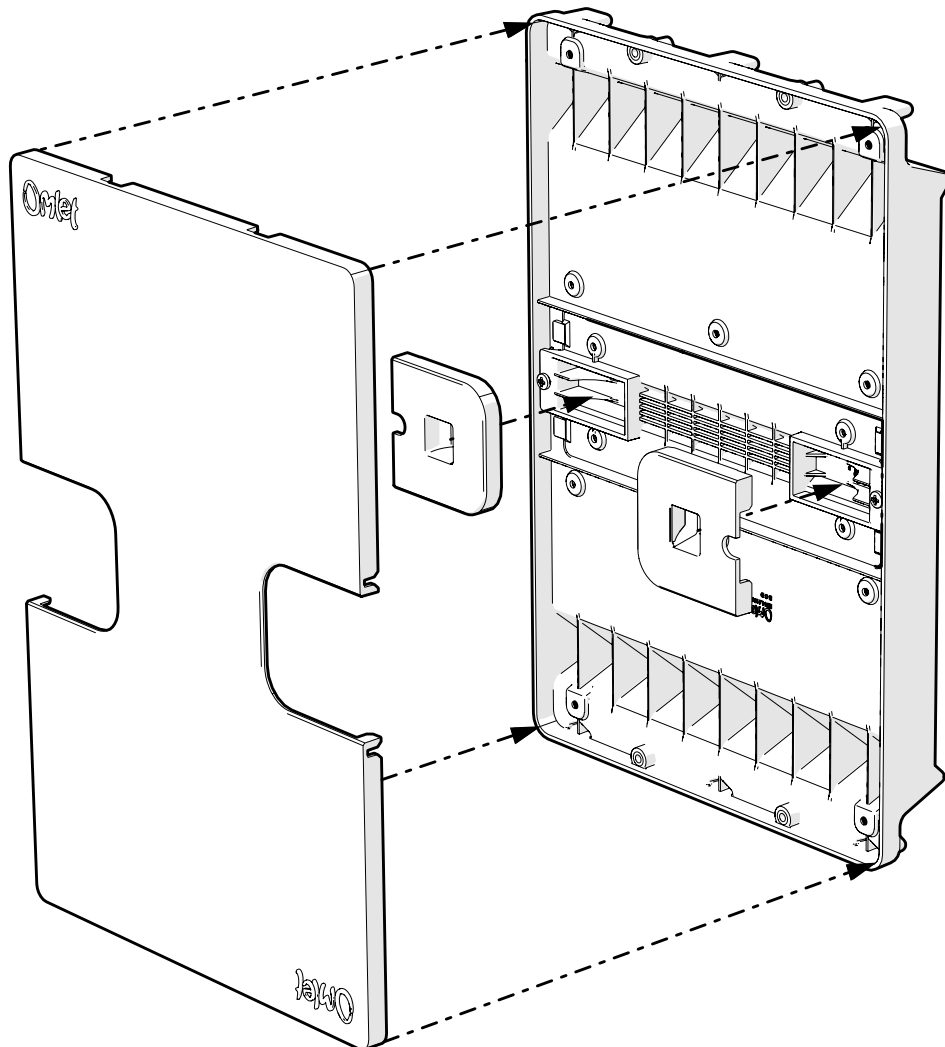

23

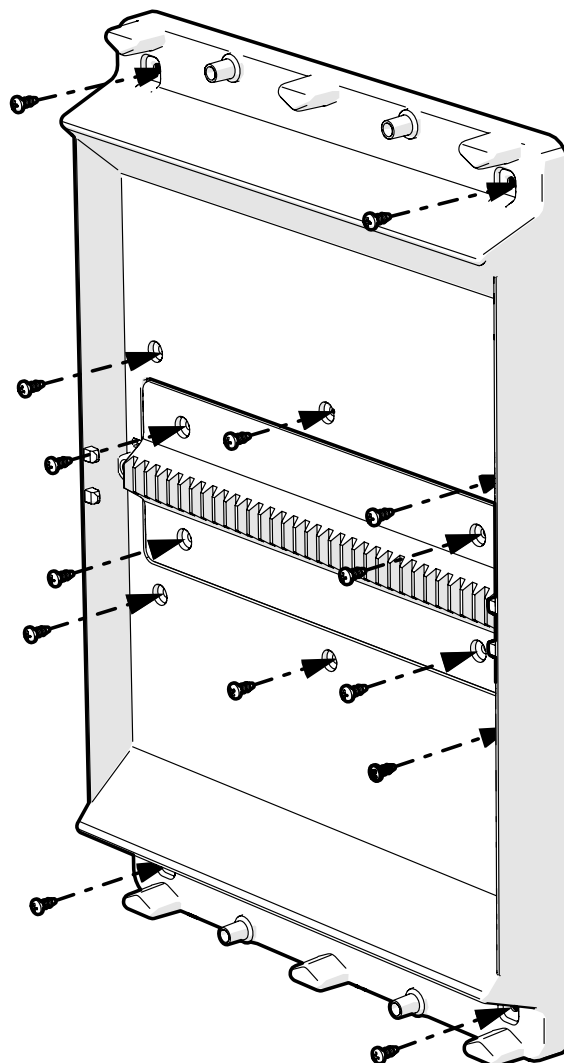
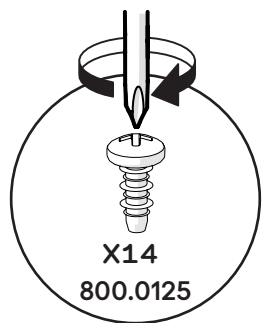

24

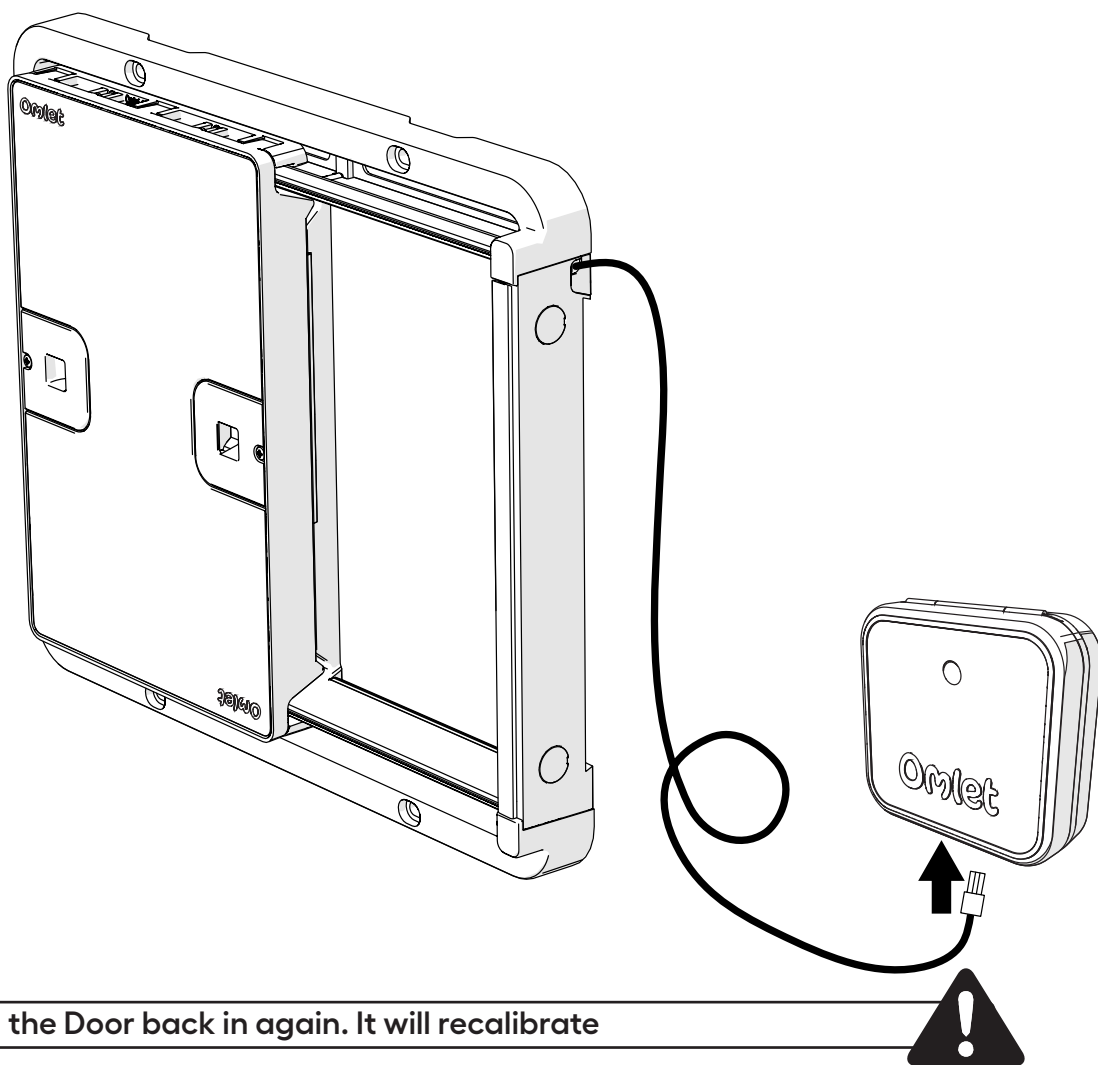
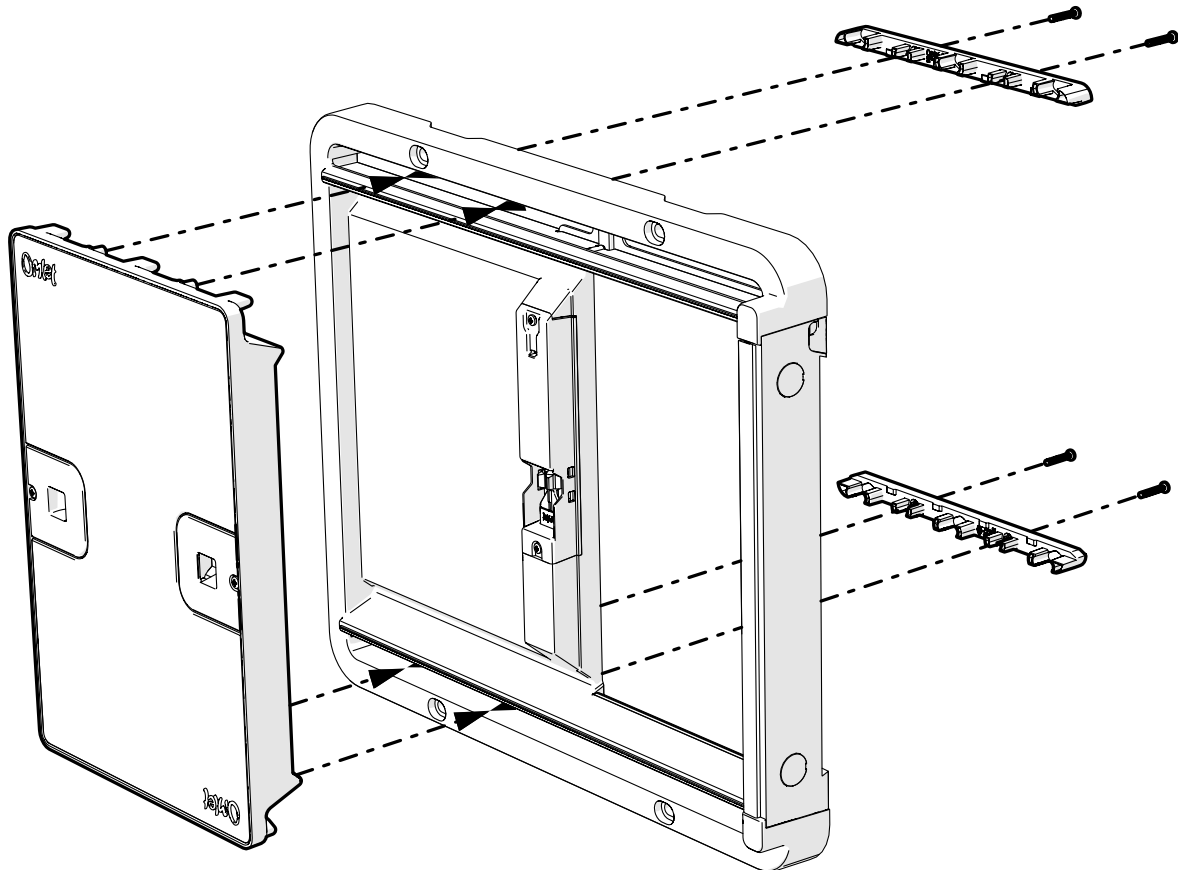
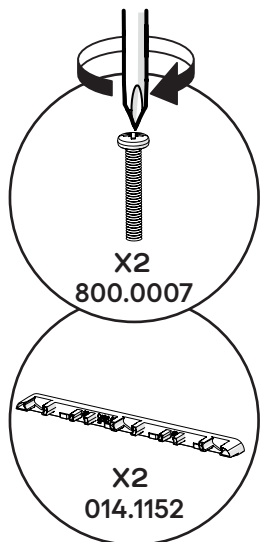

Plug the Door back in again. It will recalibrate