

# SMART FAN

## Assembly Guide

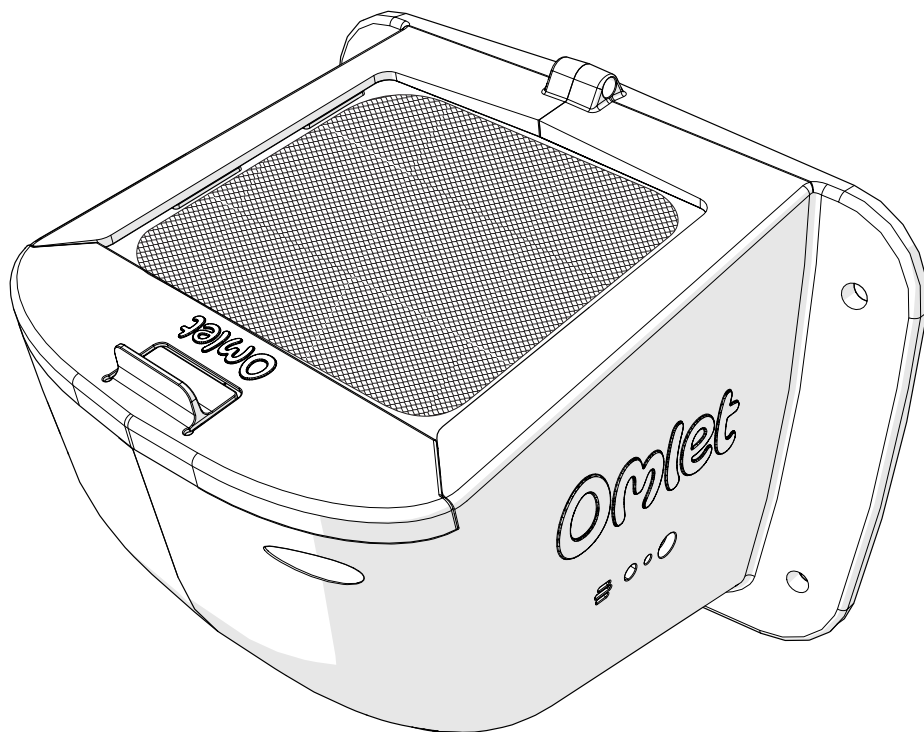

**Omlet**

## **EN Important Information! Please read before use**

Thank you for buying an Omlet Smart Fan. It is designed for attachment to your Eglu Pro or to a wooden coop. The Smart Fan ensures a cool and comfortable environment for your chickens by ventilating stagnant hot air that builds up throughout the day, keeping the air fresh inside the coop. Please make sure you read this manual carefully while assembling the product. It is only suitable for use inside the Eglu Pro or a wooden coop. You must follow the assembly and maintenance instructions to ensure the product works as intended. Any other use beyond what is specified shall be considered improper use. Direct commercial or industrial use is also deemed improper. Omlet is not liable for any damage caused from such use. This product requires an external power source. Please note that the Smart Fan may require maintenance throughout its use. Do not carry out maintenance before unplugging the Smart Fan from the power source. If you are uncomfortable with using power tools, please seek professional advice.







Scan a QR code below to download the Omlet app



For Apple



For Android

**Warning: Unplug cable before removing filter**

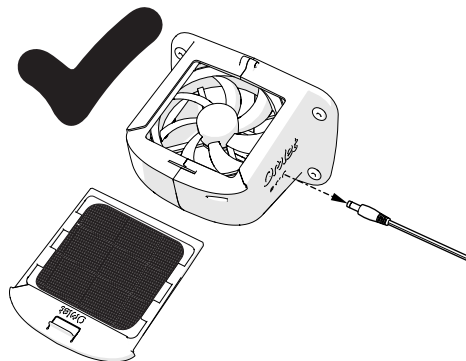
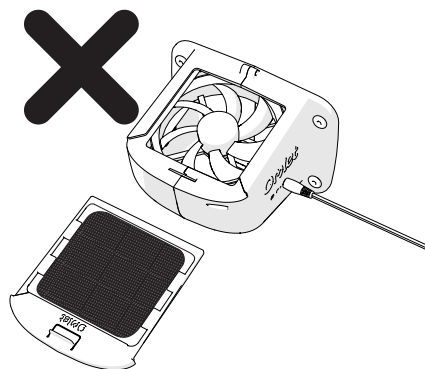

**Interfering with the fan while in motion may cause injury and damage the fan**



## What you have received

### 117.0021 Boxed Smart Fan

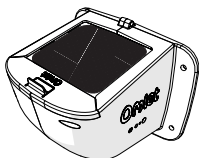

**X1**  
Smart Fan  
117.0012

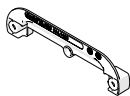

**X1**  
Inner Logo Plate  
114.1135



**X1**  
Outer Logo Plate  
114.1136.0002

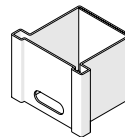

**X1**  
Cardboard Insert  
820.2680

**Keep cardboard insert if attaching to a wooden coop**



**US Power Supply**  
2.5m  
117.1008

or



**EU Power Supply**  
2.5m  
117.1010

or



**UK Power Supply**  
2.5m  
117.1003

or



**AUS Power Supply**  
2.5m  
117.1009



## 117.0022 Boxed Fan Fixings Pack



**X2**  
Wood Screw  
3.5x10mm  
800.0515



**X4**  
Wood Screw  
5x16mm  
800.0509



**X4**  
M6 x 12mm  
Bolt  
800.0353



**X2**  
Cable Management  
Clamp  
117.1002

**Screws provided are for wooden coops with a wall thickness above 3/8" (10mm). For thinner walls, follow recommendations for Step 9.**



You will need...

For attachment to Eglu Pro



For attachment to a wooden coop

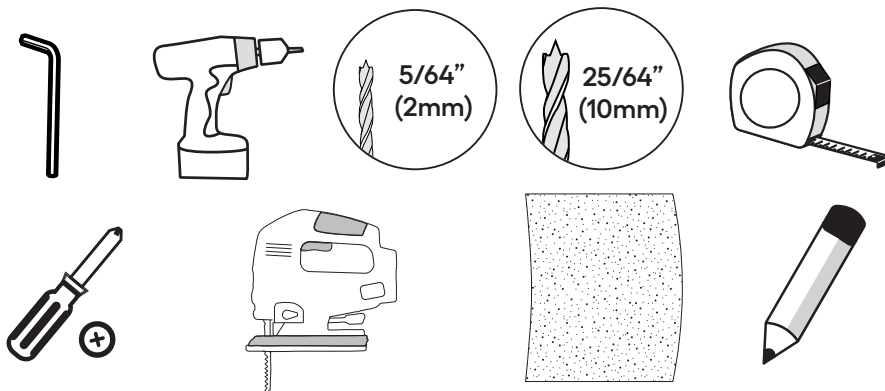

## How to attach your Smart Fan to your Eglu Pro or wooden coop

### Eglu Pro

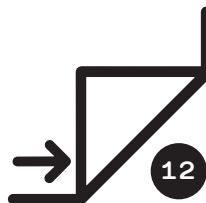
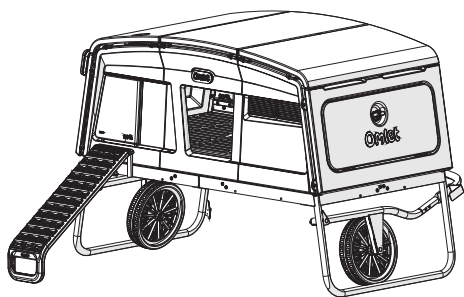

### Wooden Coop

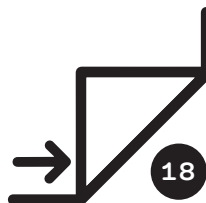
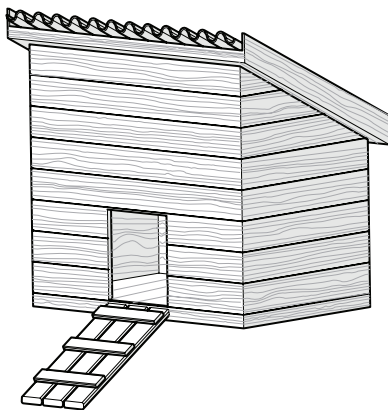

# 1

## Attaching to an Eglu Pro

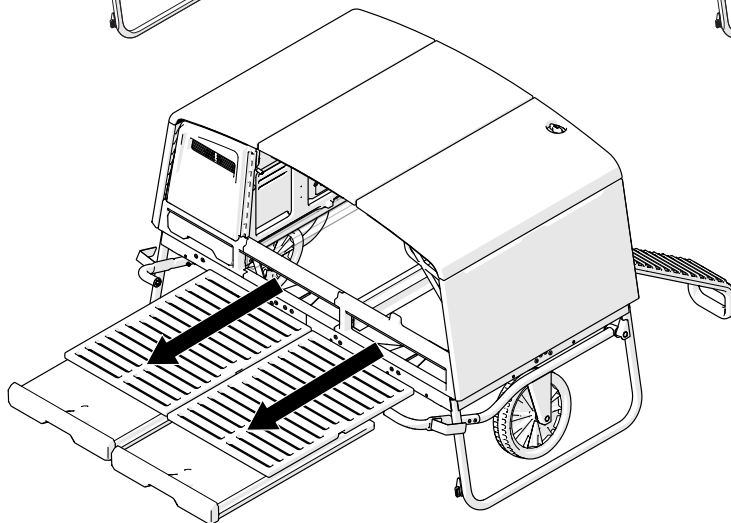
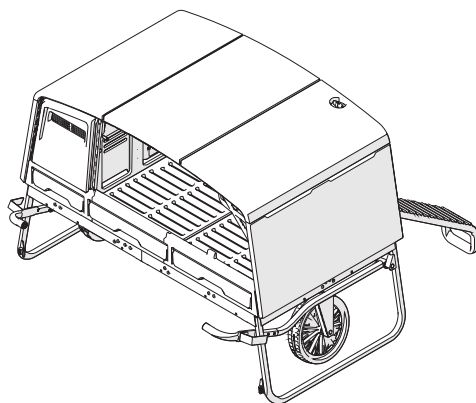
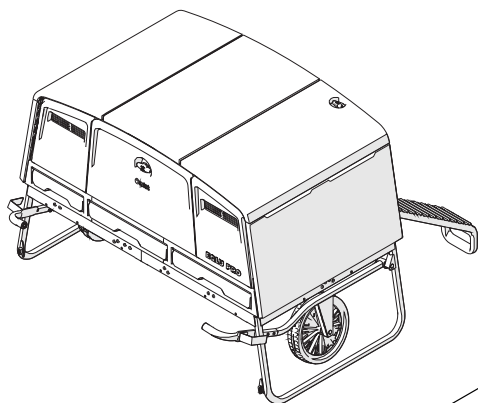



2

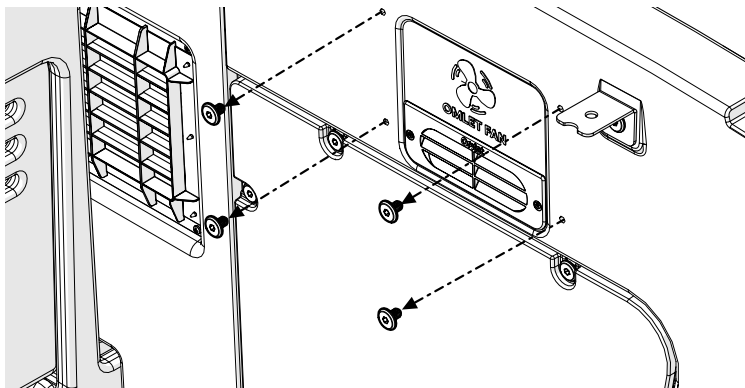
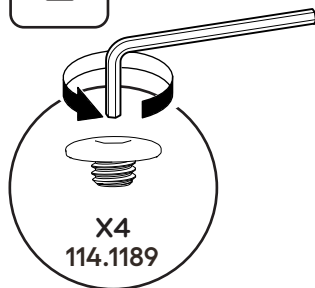

3

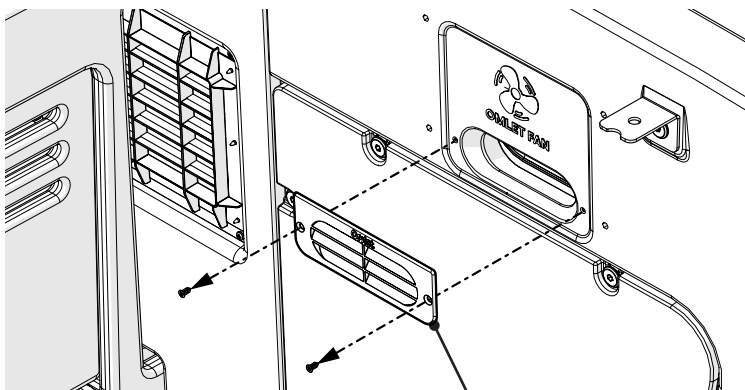
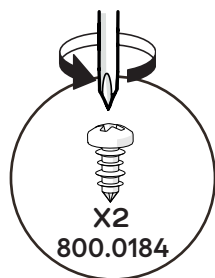

114.1137

4

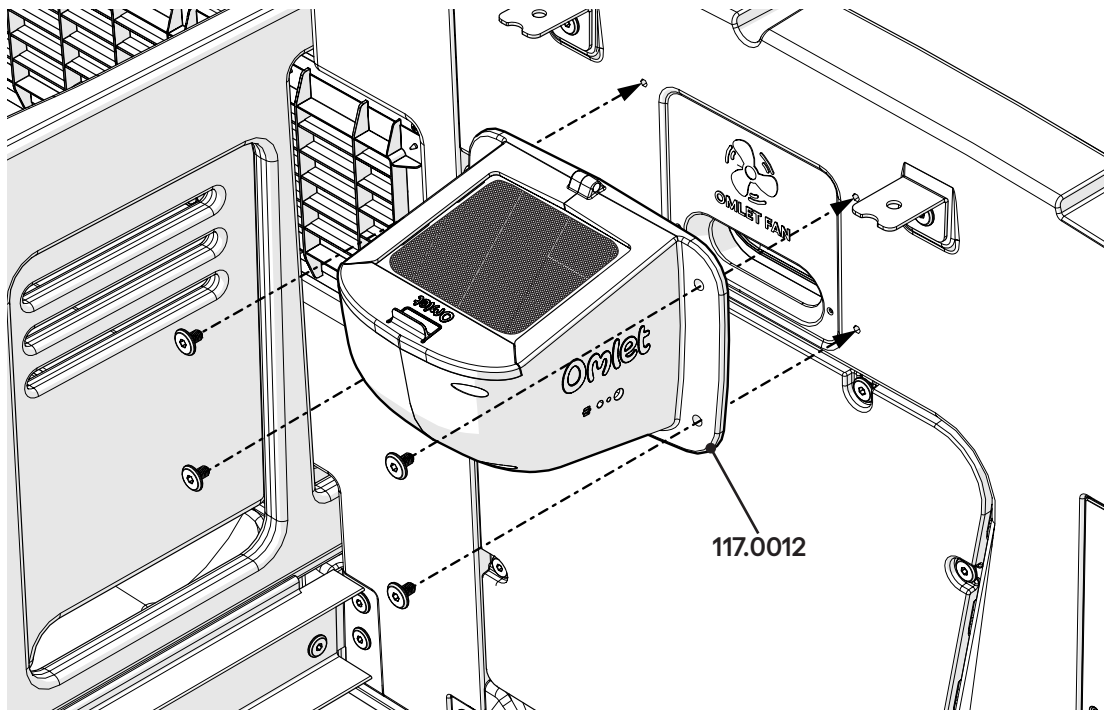
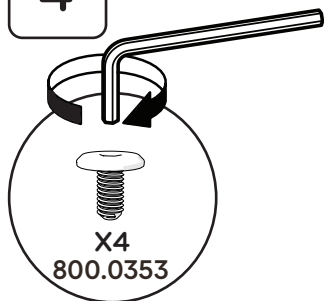

5

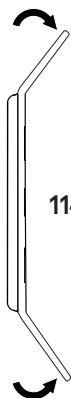

114.1148

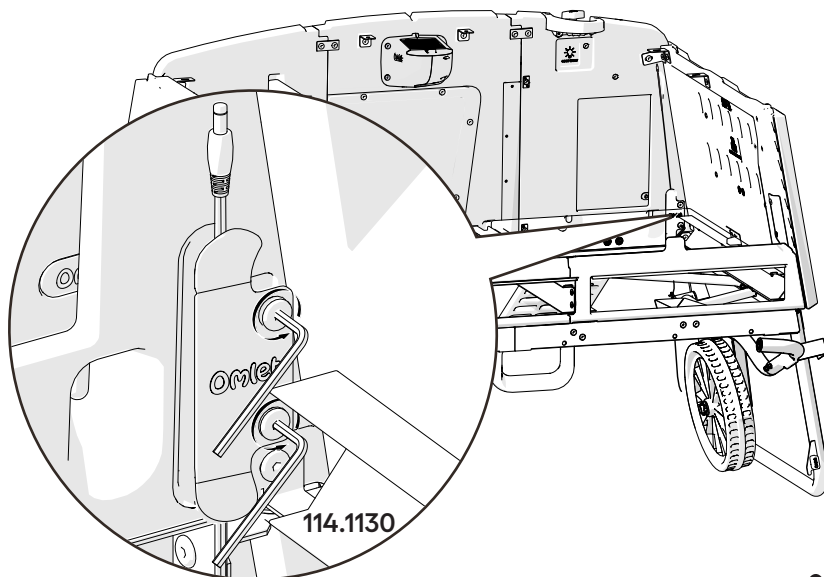

114.1130

Untighten and bend tabs to thread cable under channel cover, then retighten.  
114.1130 Tray Runner removal optional for easier access.

6

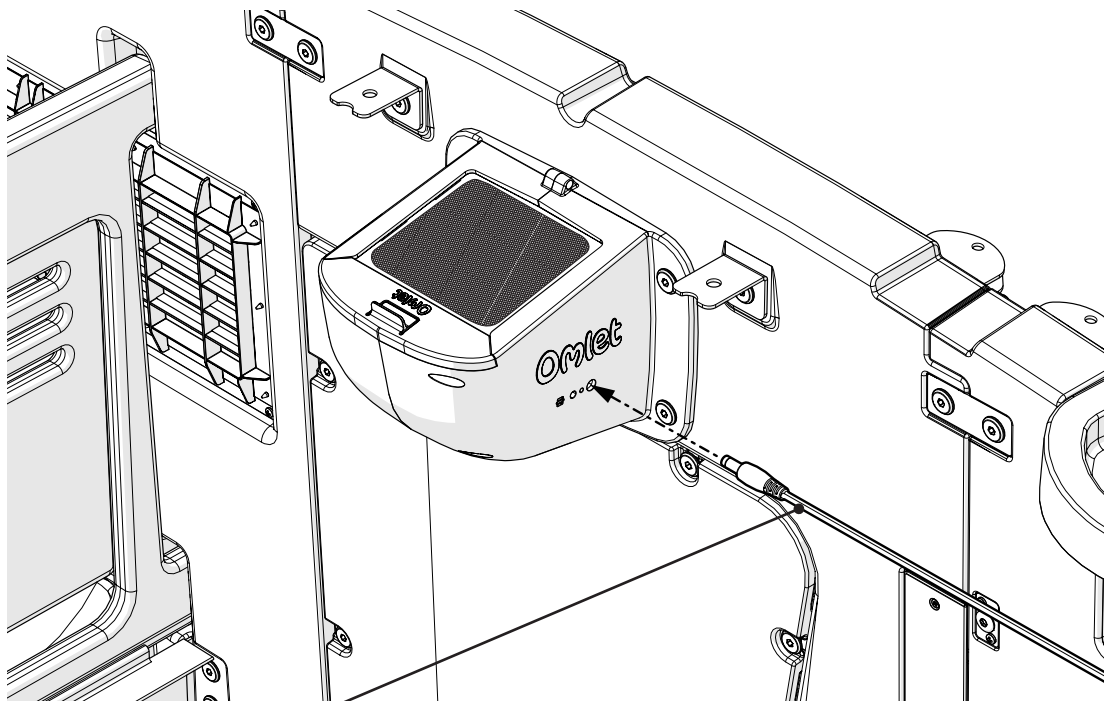

117.1008

or

117.1010

or

117.1003

or

117.1009



7

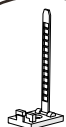

X2  
117.1002

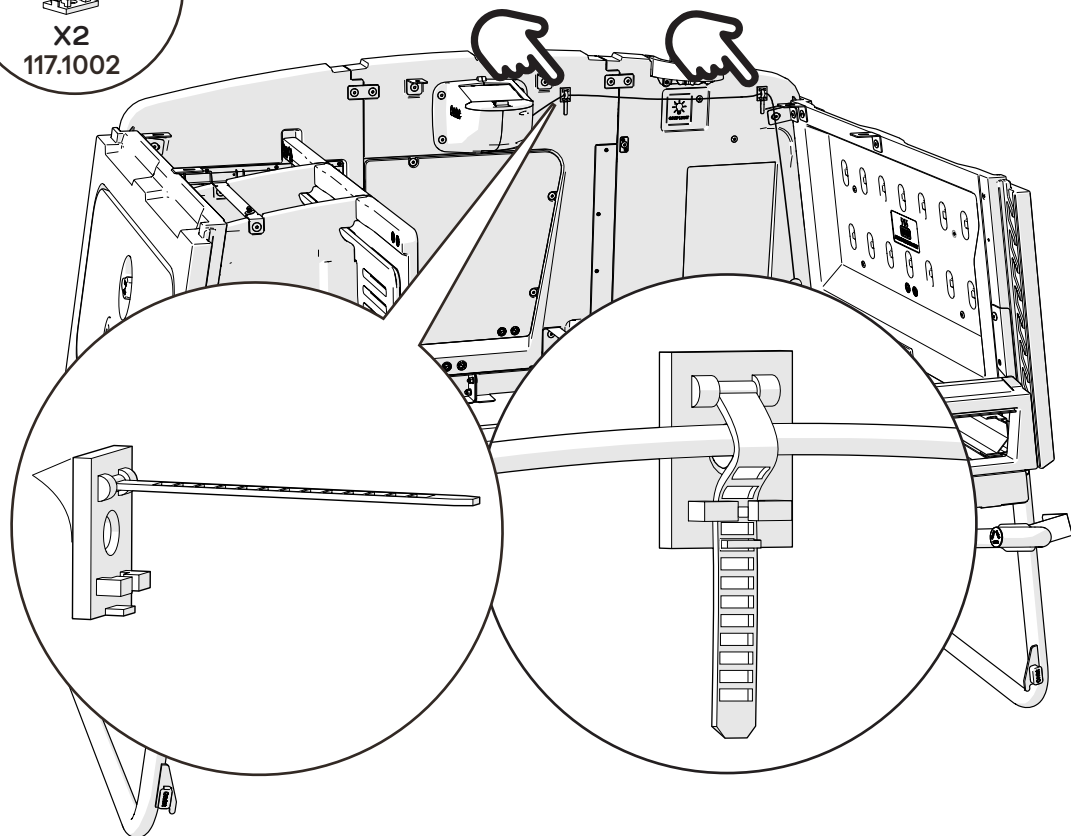

# 1

## Attaching to a Wooden Coop

### Smart Fan Assembly to a Wooden Coop Exploded View

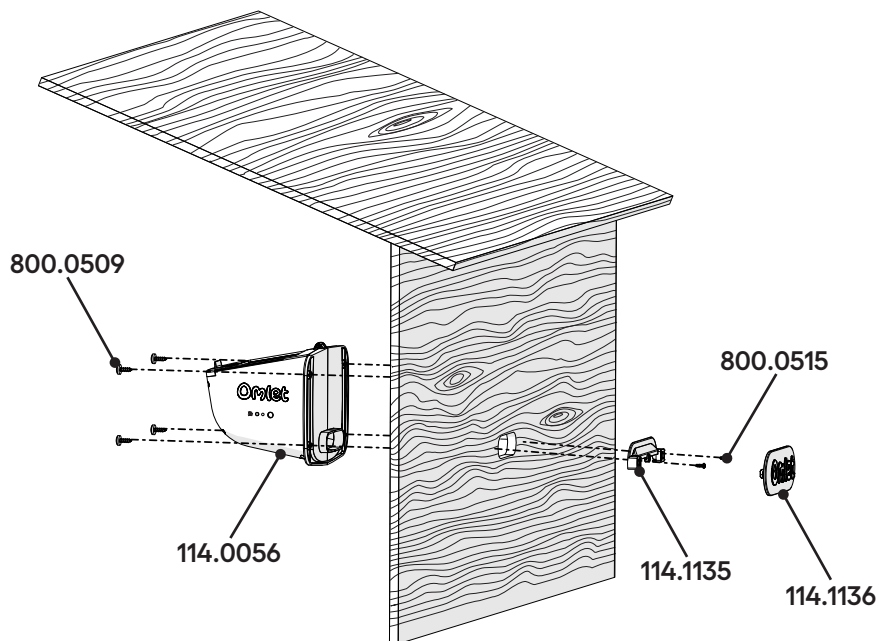

2

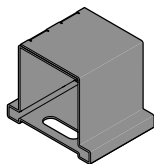

820.2680

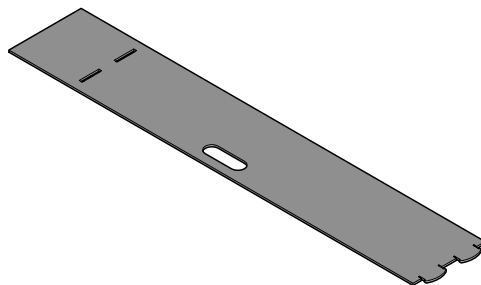

3

Measure appropriate distance from the roof

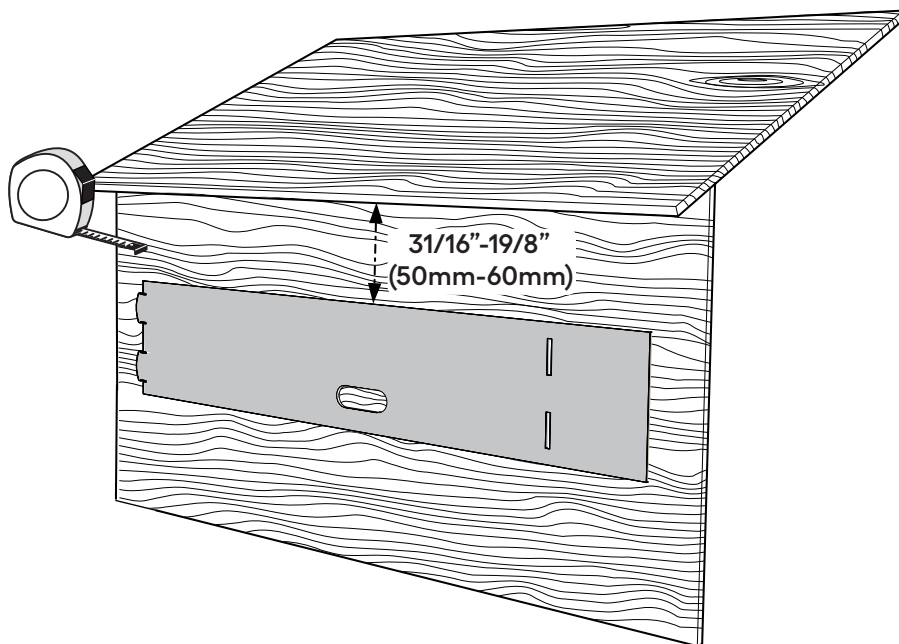

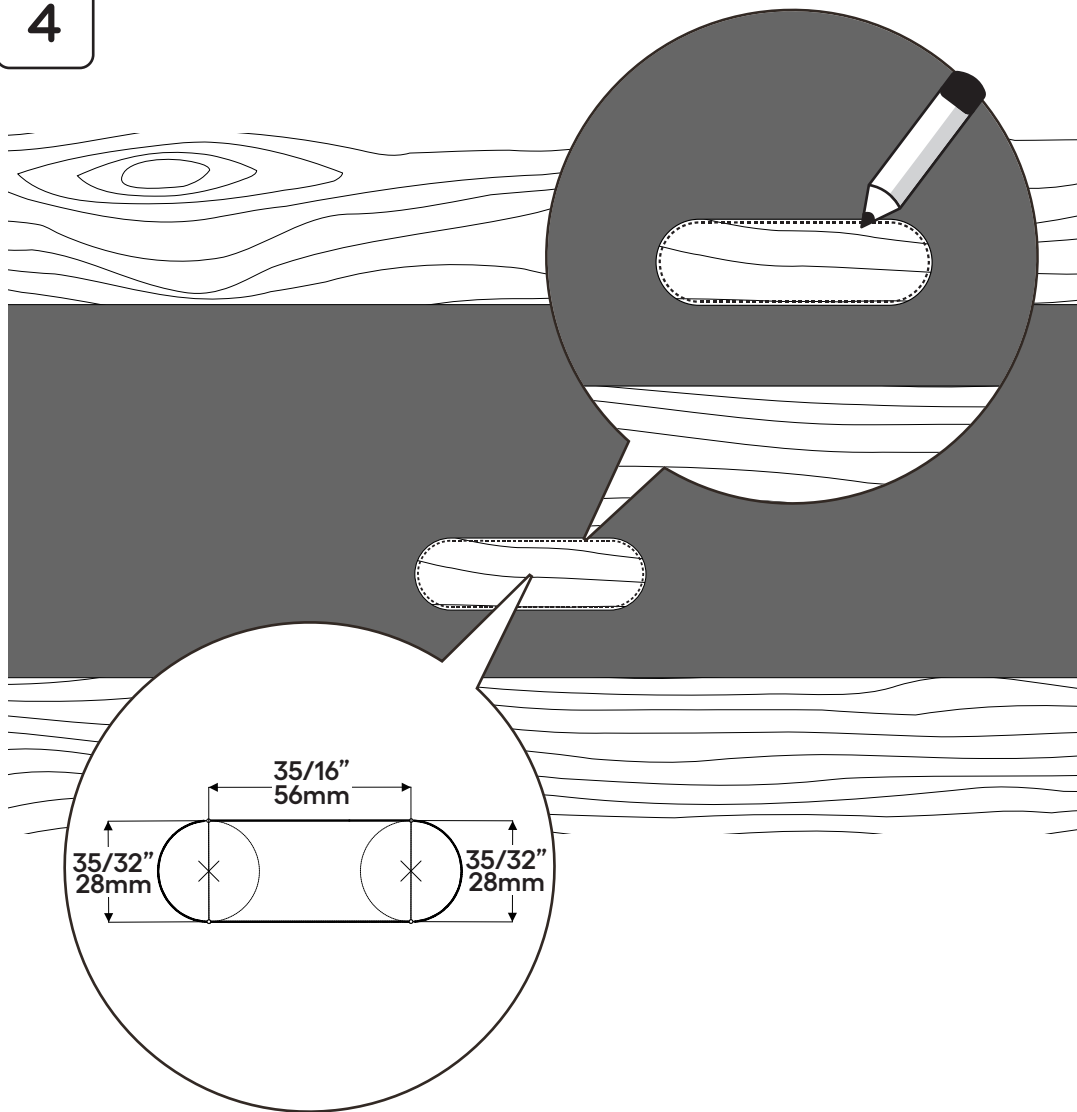

5

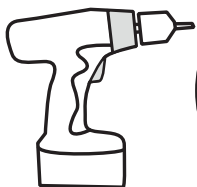

25/64"  
(10mm)

6

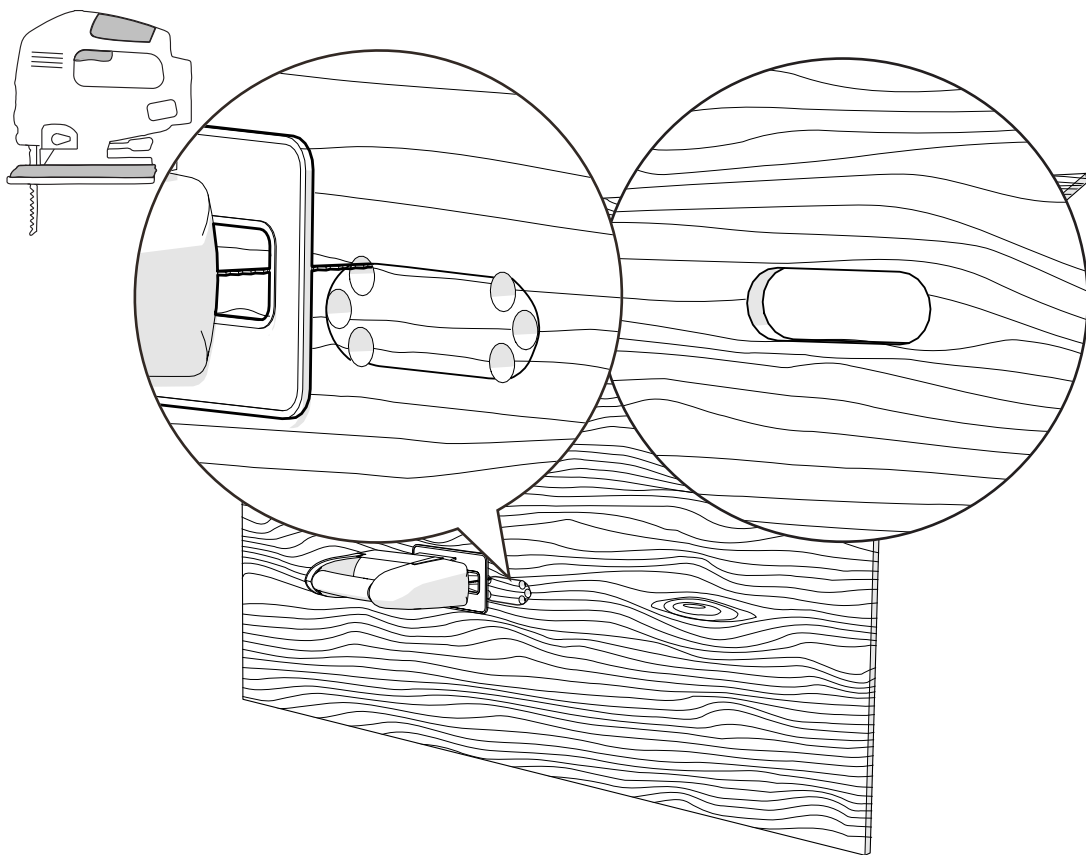

Sand edges smooth



7

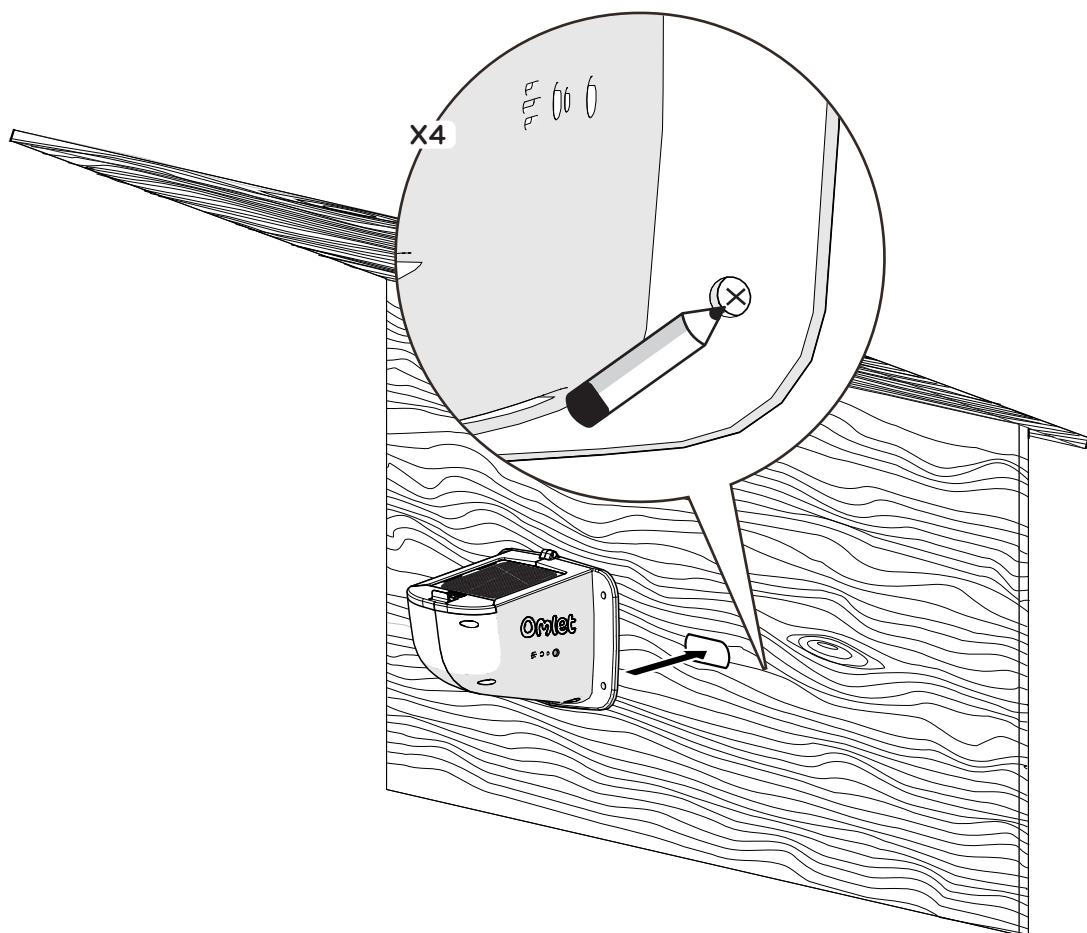

8

Drill pilot hole. Caution: Avoid drilling through wood

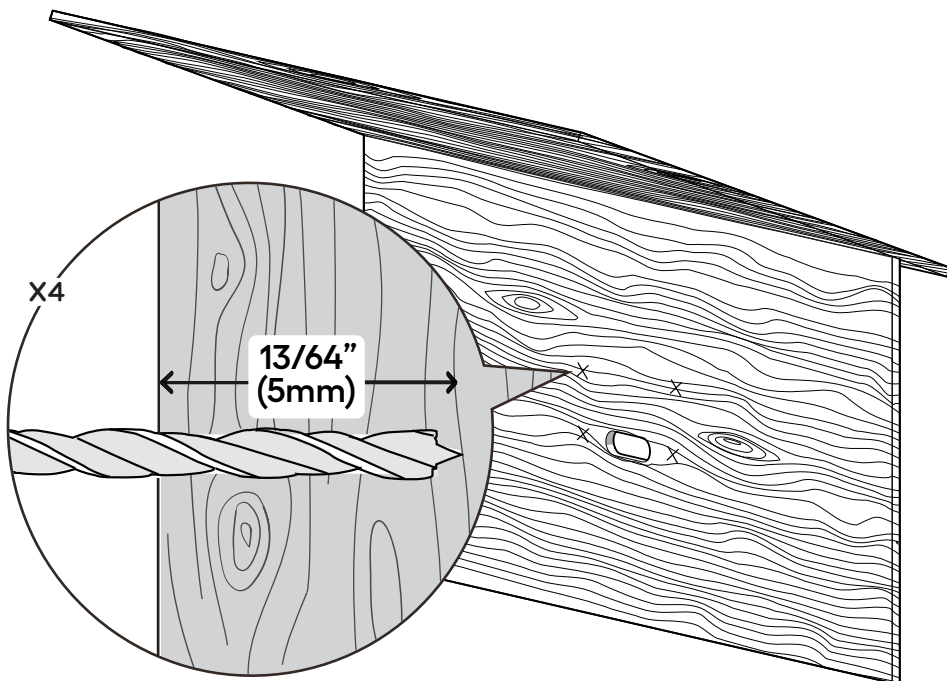
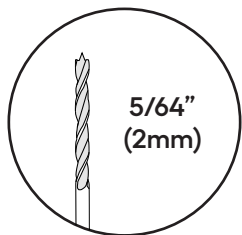
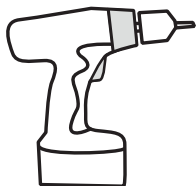



9

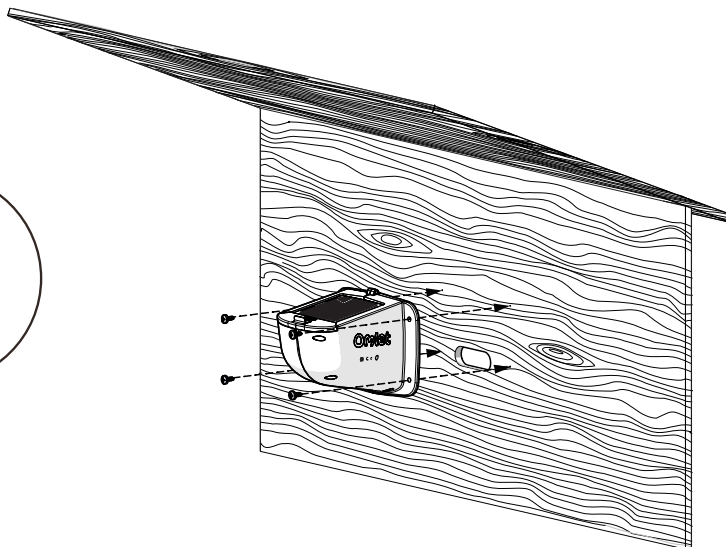
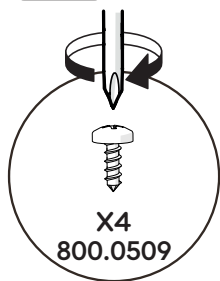

A supporting sheet of wood is recommended for walls thinner than  $\frac{3}{8}$ " (10mm)

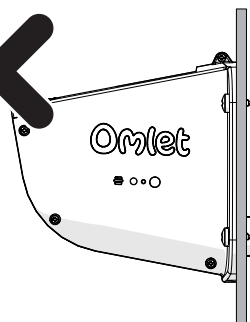

$<\frac{3}{8}$ "  
( $<10\text{mm}$ )

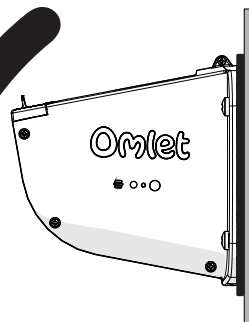

$>\frac{3}{8}$ "  
( $>10\text{mm}$ )

10

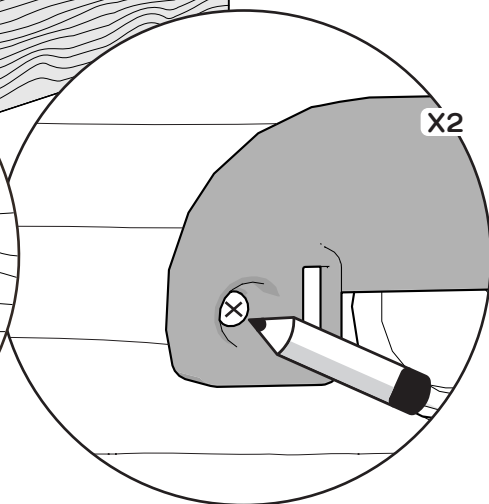
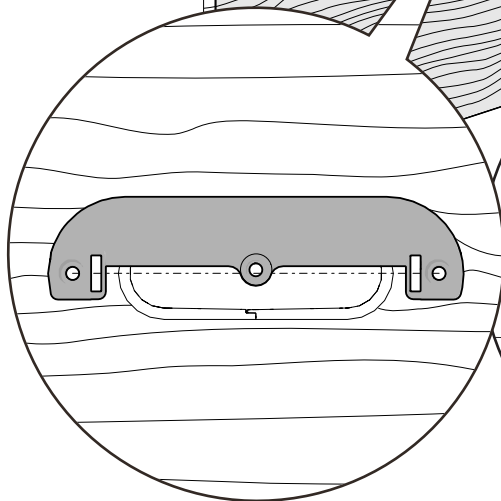
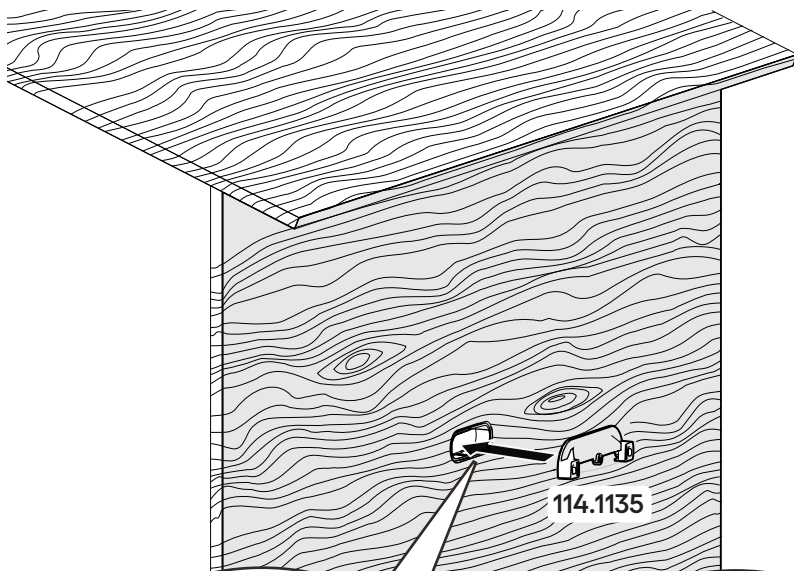

11

Drill pilot hole. Caution: Avoid drilling through wood

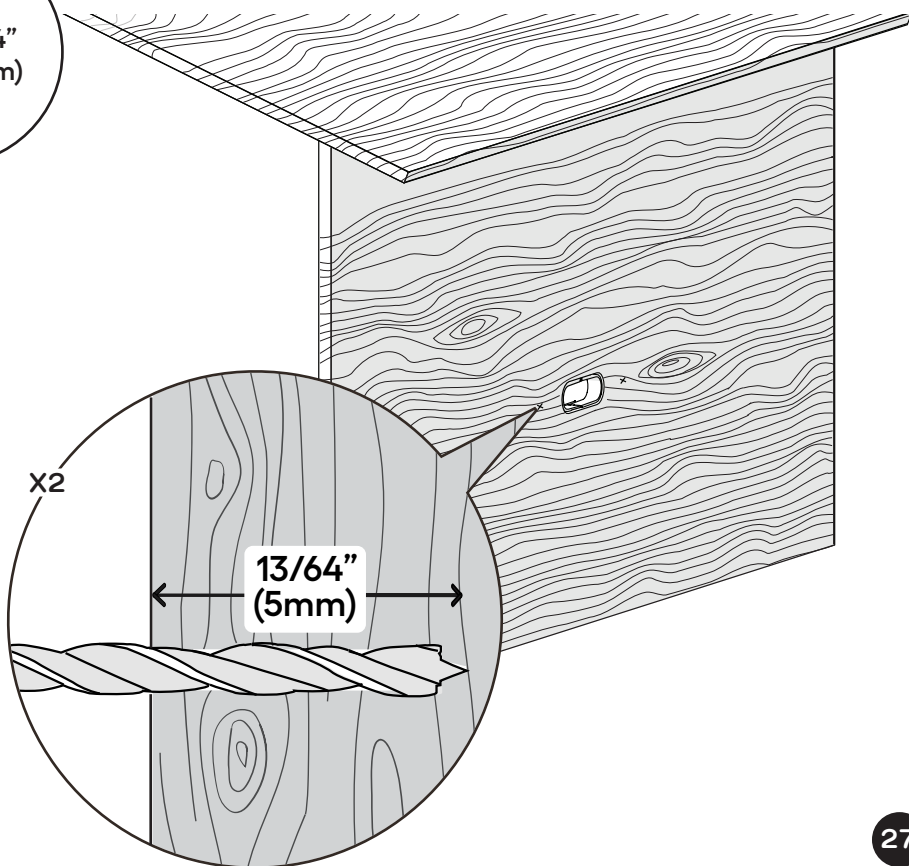
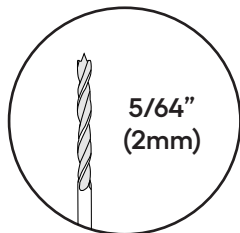
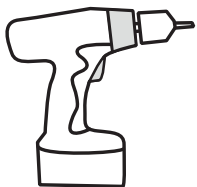

12

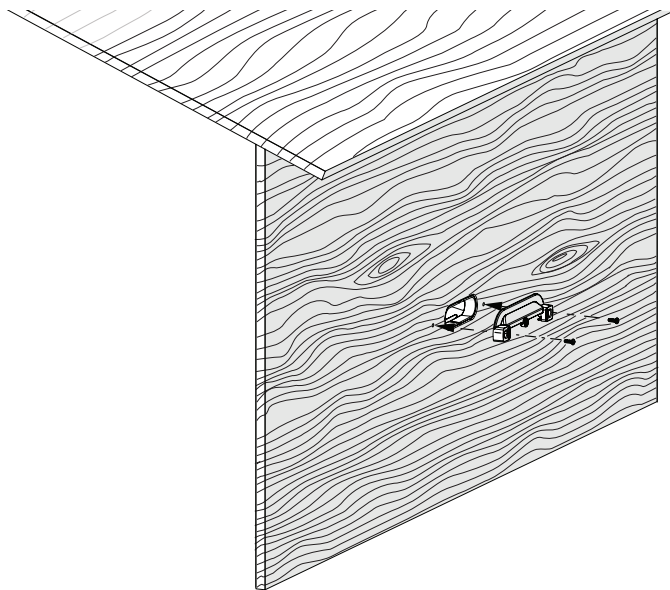
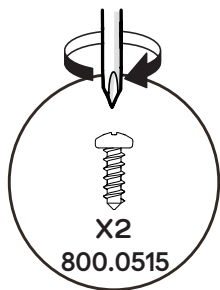

13

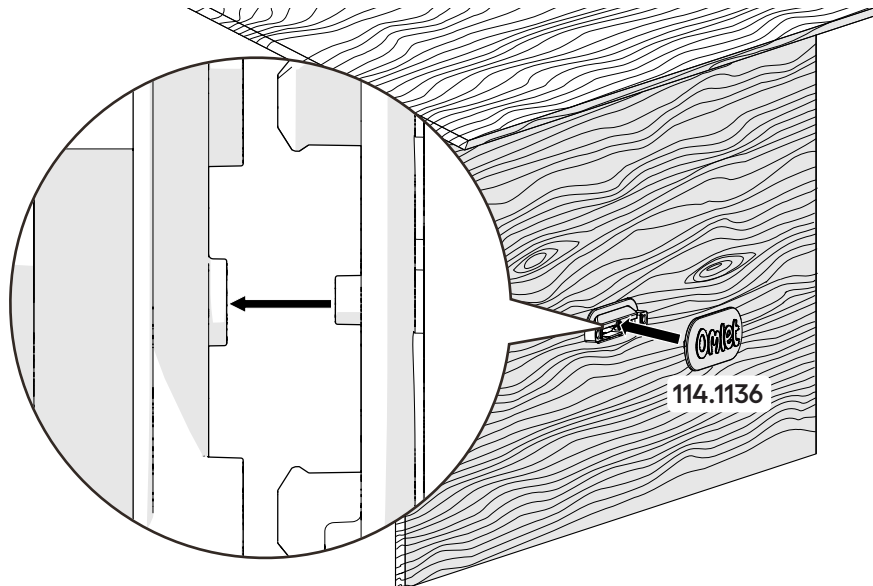

14

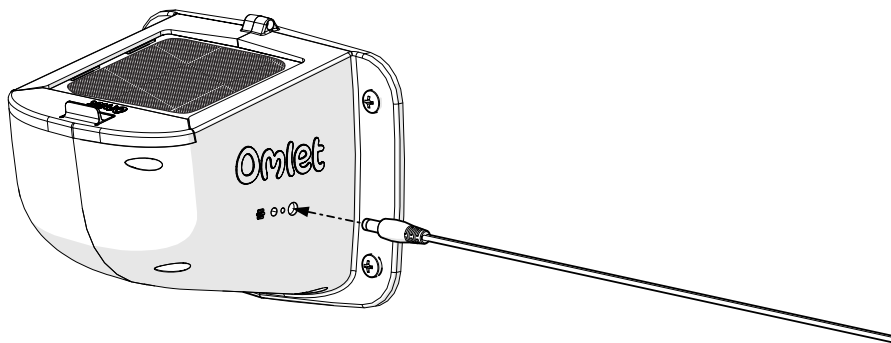

15

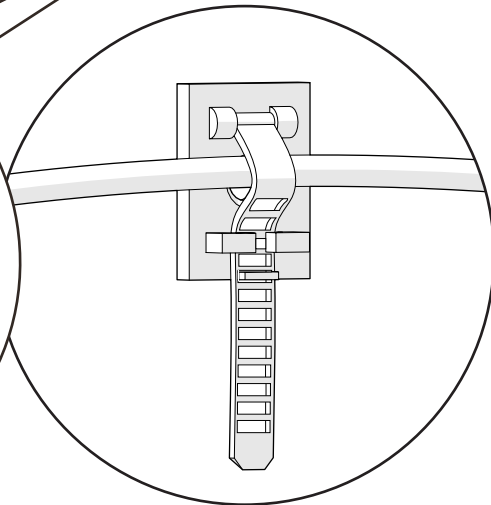
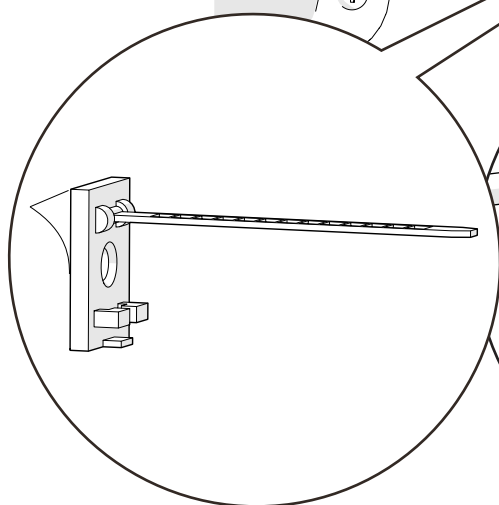
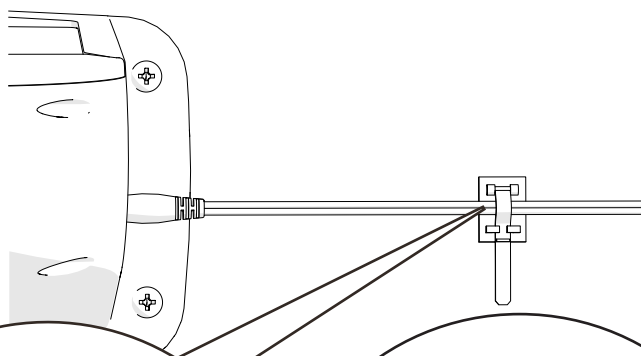
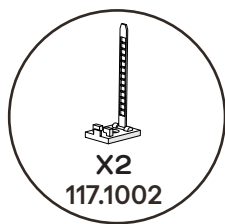



### Dust Filter Removal:

1. Unplug Fan before removing filter casing.
2. Pull latch to remove filter
3. Clean with compressed air or a microfibre cloth
4. Reinsert the filter into the Smart Fan casing

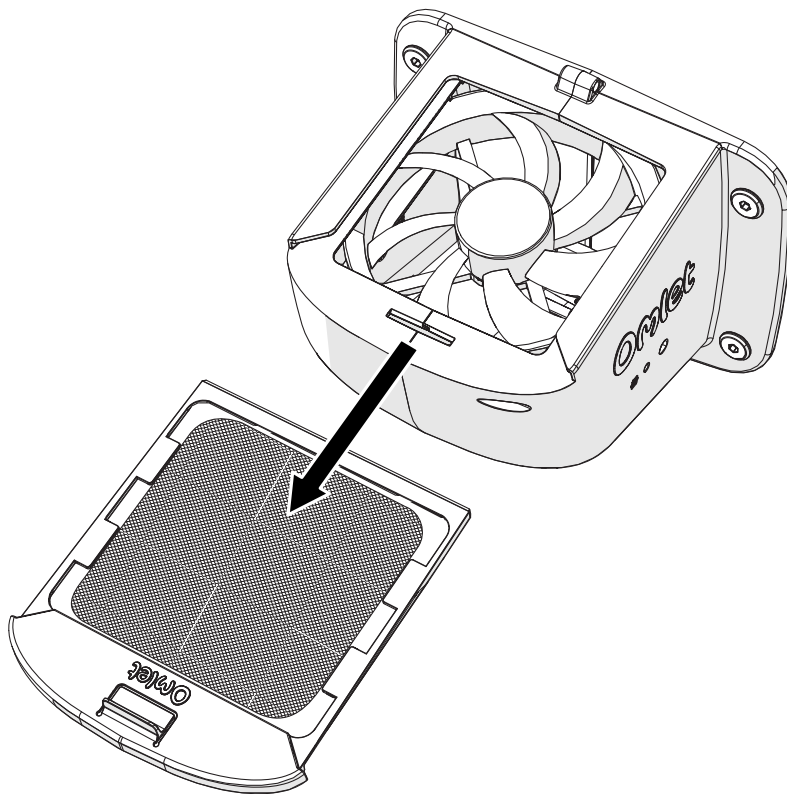



# Omlet



Please  
reuse &  
recycle.

© Copyright Omlet Ltd. 2024

Design registered, patent pending

Omlet is a registered trademark of Hebe Studio Ltd.

820.2701\_Instruction Manual Smart Fan\_17/05/2024

UK  
CA CE



Points de collecte sur [www.quefairedemesdechets.fr](http://www.quefairedemesdechets.fr)  
Privilégiez la réparation ou le don de votre appareil !



5 055358 858044 >